

TOWNSHIP 11 NORTH, RANGE 40 EAST, OF THE MOUNT DIABLO MERIDIAN, NEVADA

AMENDED NEVADA PROTRACTION DIAGRAM No. 256, UNIT No. 57

UNSURVEYED

OFFICIALLY FILED
NEVADA STATE OFFICE
at 10:00 AM on March 5, 1998

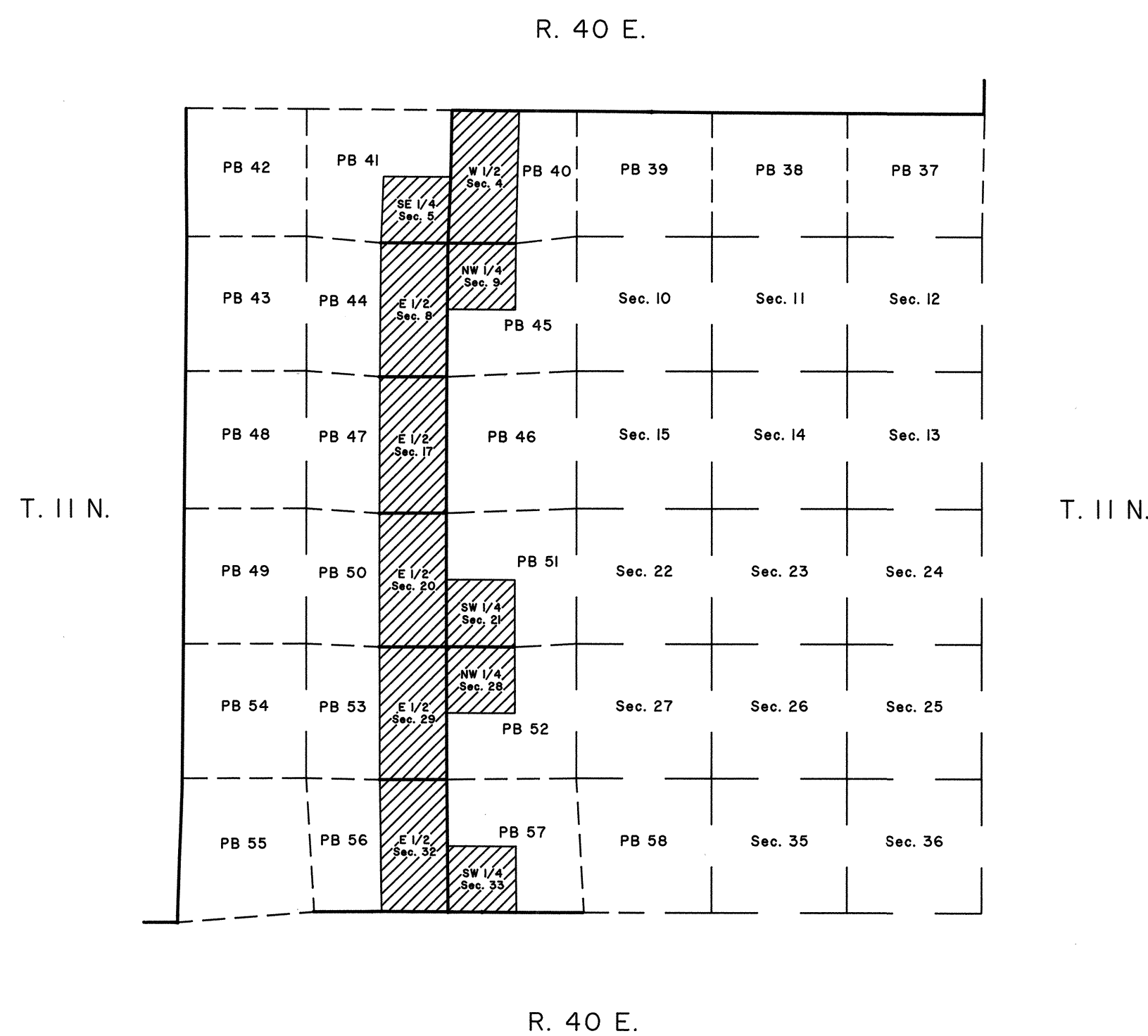
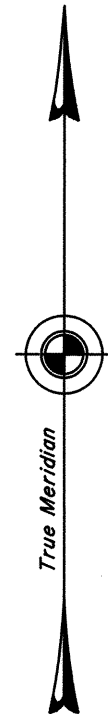

TOWNSHIP INDEX

T. 11 N. R. 40 E. Sheet 2

- Surveyed Areas
- Surveyed Lines
- Protracted Lines
- Reliable Protracted Lines

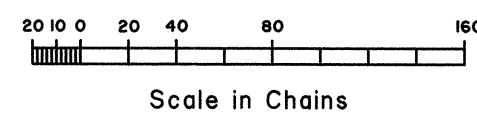

UNITED STATES DEPARTMENT OF THE INTERIOR
BUREAU OF LAND MANAGEMENT

Reno, Nevada March 3, 1998

This diagram represents the official protraction of the rectangular system of surveys and is hereby accepted.

For the Director

Robert H. Thompson

Acting Chief Cadastral Surveyor, Nevada

Amended Nevada Protraction Diagram No. 256
Unit No. 57

BJC/bmg

T. 11 N., R. 40 E., M.D.M.