

TOWNSHIP N^o 47 NORTH RANGE N^o 64 EAST MOUNT DIABLO MERIDIAN

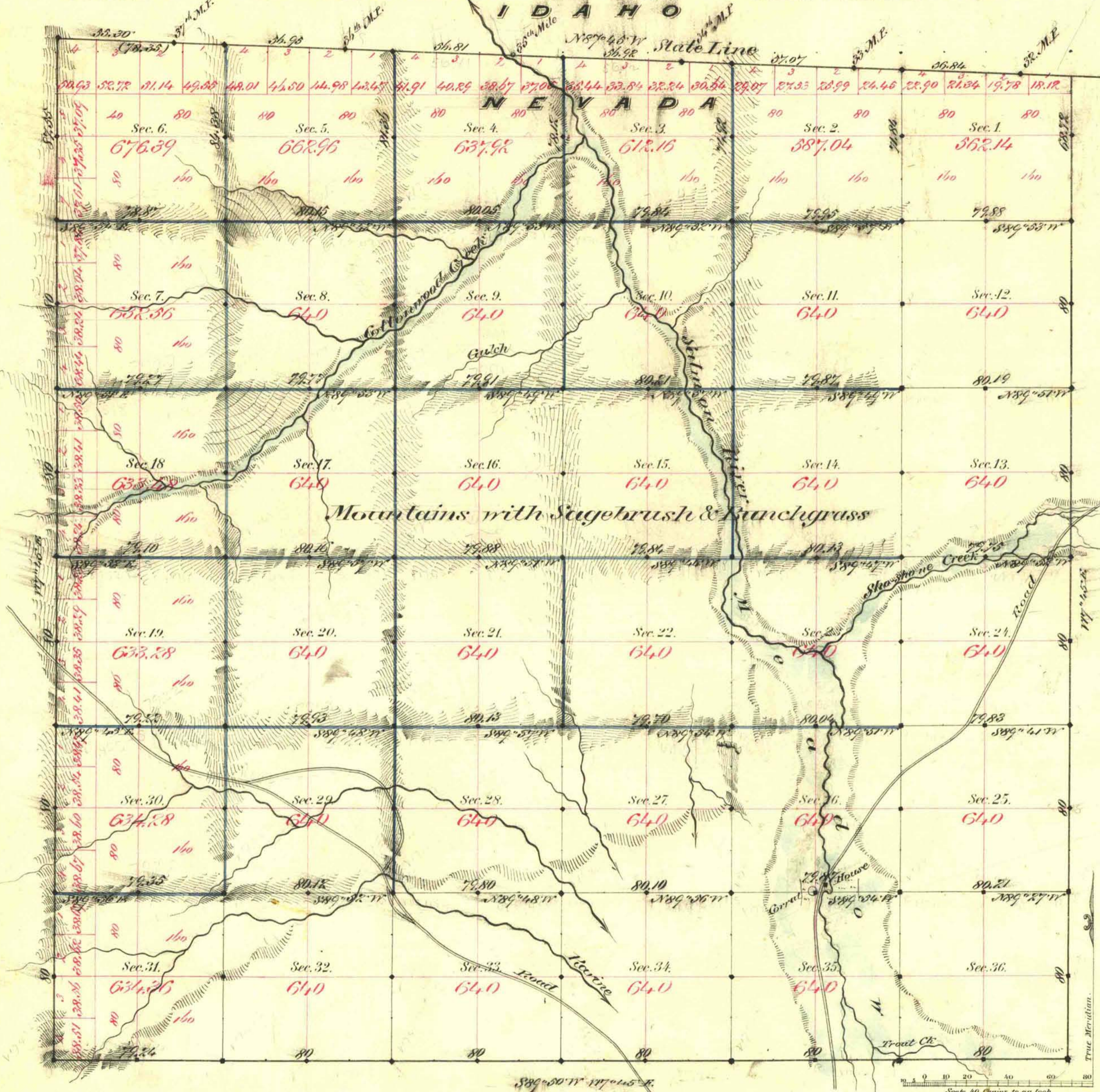

Aggregate Area of Public Lands surveyed 27,906.07

Commenced February 15th 1881
Completed " " 21st

but division lines run with a Variation of 17' 45" East

Survey Disputed	By Whom Surveyed	Date of Contract	Amount of Survey	When Surveyed	Corr.
N. 47 th State Line	D. H. Meyer	Sept. 4 th 1872	M. Ch. 122	1872	
E. N. 47 th Range	Morgan & Co. Blain	Dec. 15 th 1880	17-75-21	1881	107
Badlam's Black's	"	"	22-71-29	February	"
Blair's	"	"	34-74-12	"	"
Comedman's	"	"	3-44-29	"	"

The above Map of Township N. 47 North of Range N. 64 East
Mount Diablo Meridian
is strictly conformable to the field
notes of the survey thereof on file in this Office, which have been examined and approved.

Surveyor General's Office,
Virginia City, Nev.
April 19th 1881

C. S. Davis
Sur. Gen. Nev.

3

0251

A. J. Hancock & Co. S. 1.