

## TOWNSHIP 47 NORTH, RANGE 28 EAST, MOUNT DIABLO MERIDIAN, NEVADA.

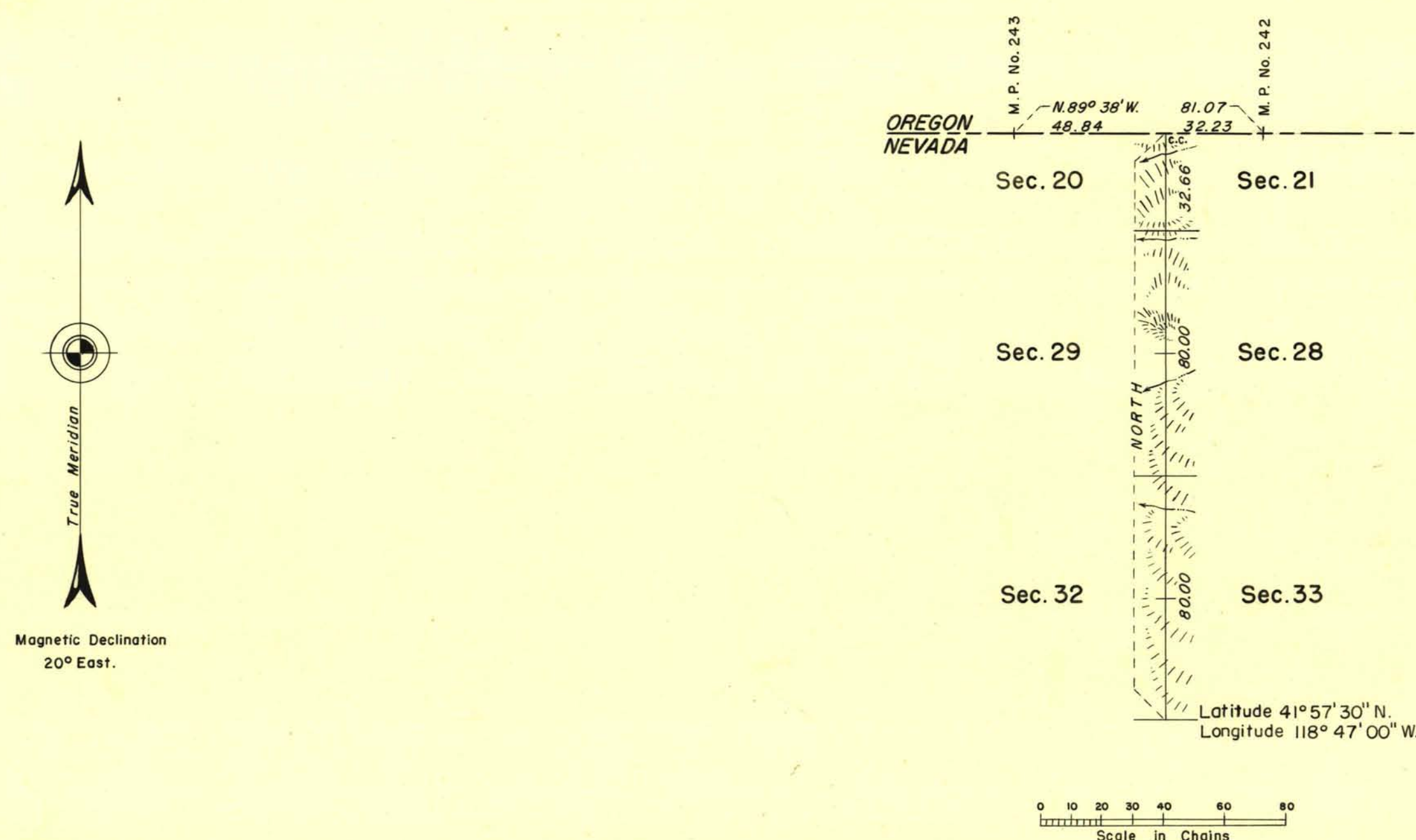

The survey of the 4th meridional line was executed by Philip L. Inch, October 28 to 31, 1940, under special instructions dated August 1, 1940 for Group 310, Nevada.

UNITED STATES DEPARTMENT OF THE INTERIOR  
BUREAU OF LAND MANAGEMENT  
Washington, D. C. August 29, 1955

This plat is strictly conformable to the approved field notes, and the survey, having been correctly executed in accordance with the requirements of law and the regulations of this Bureau, is hereby accepted.

For the Director

*Earl G. Harrington*  
Cadastral Engineering Staff Officer