

Township N<sup>o</sup> 46 North

Range N<sup>o</sup> 32 East

Mount Diablo Meridian

Sur. Cont 71

Sur. Cont 61

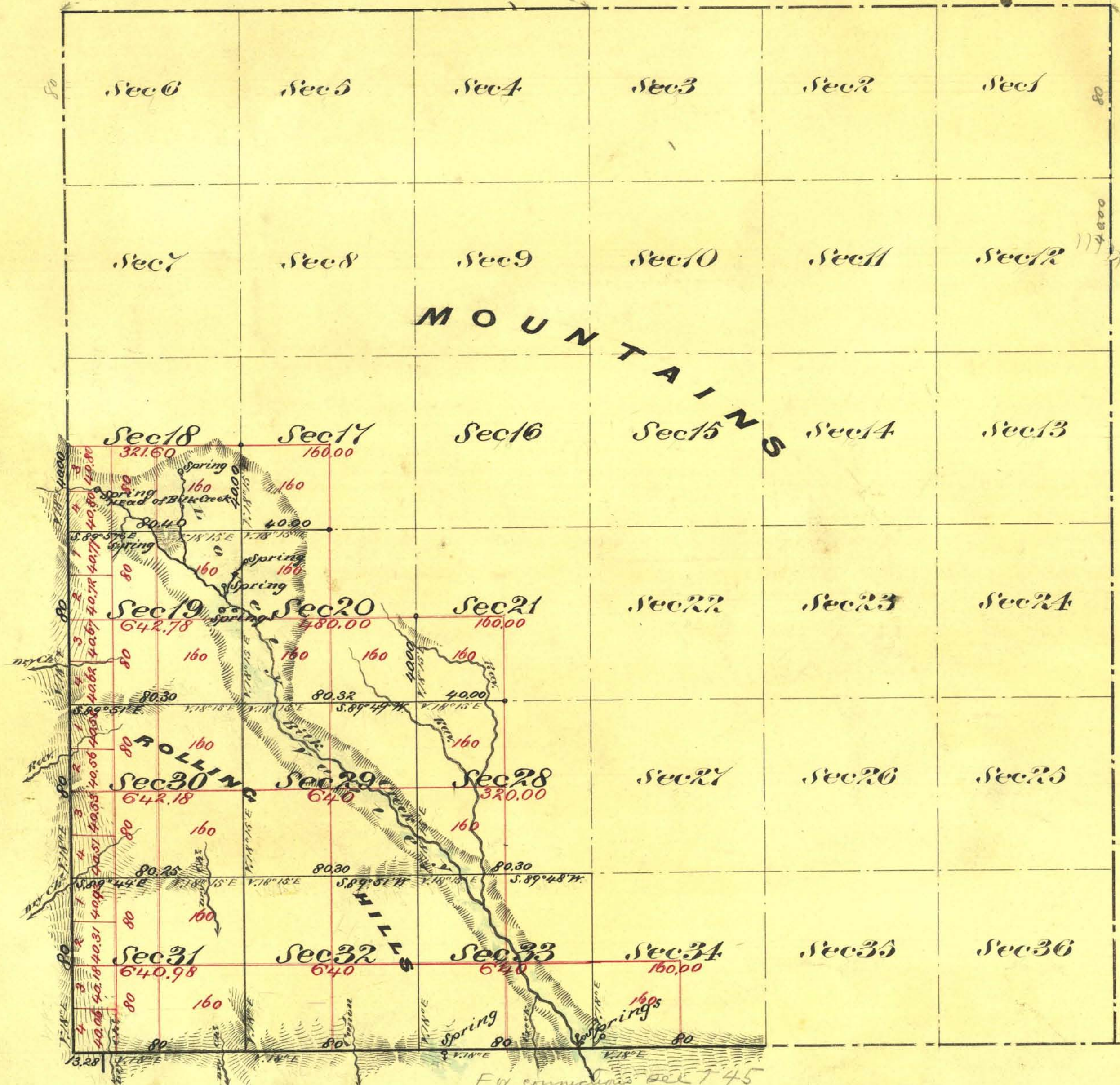

Aggregate Area of Public Land (Surveyed) 5,2147.54 Acres  
 Estimated " " Mountains (unsurveyed) 17,408.00 "  
Aggregate 22,655.54 "

Commenced March 12<sup>th</sup> 1875  
 Completed March 8<sup>th</sup> 1875

The above Map of Township N<sup>o</sup> 46 North Range N<sup>o</sup> 32 East Mount Diablo Meridian is strictly conformable to the field notes of the surveys thereof on file in this Office, which have been examined and approved.  
 U. S. Surveyor General's Office  
 Virginia City, Nevada  
 April 17<sup>th</sup> 1875

Survey Designated	By Whom Surveyed	Date of Contract	Am <sup>t</sup> of Survey	When Surveyed	7 <sup>th</sup> Cont.
Township Lines	G. W. Jarvis & C. D. Noble	Dec <sup>r</sup> 31 <sup>st</sup> 1874	7 40 00	1875	67
Subdivision Lines	" " " " " "	" " "	14 01 87	March 1875	4

C. S. Davis  
 U. S. Surveyor General Nevada