

Township N^o 46 North

Range N^o 28 East

Mount Diablo Meridian

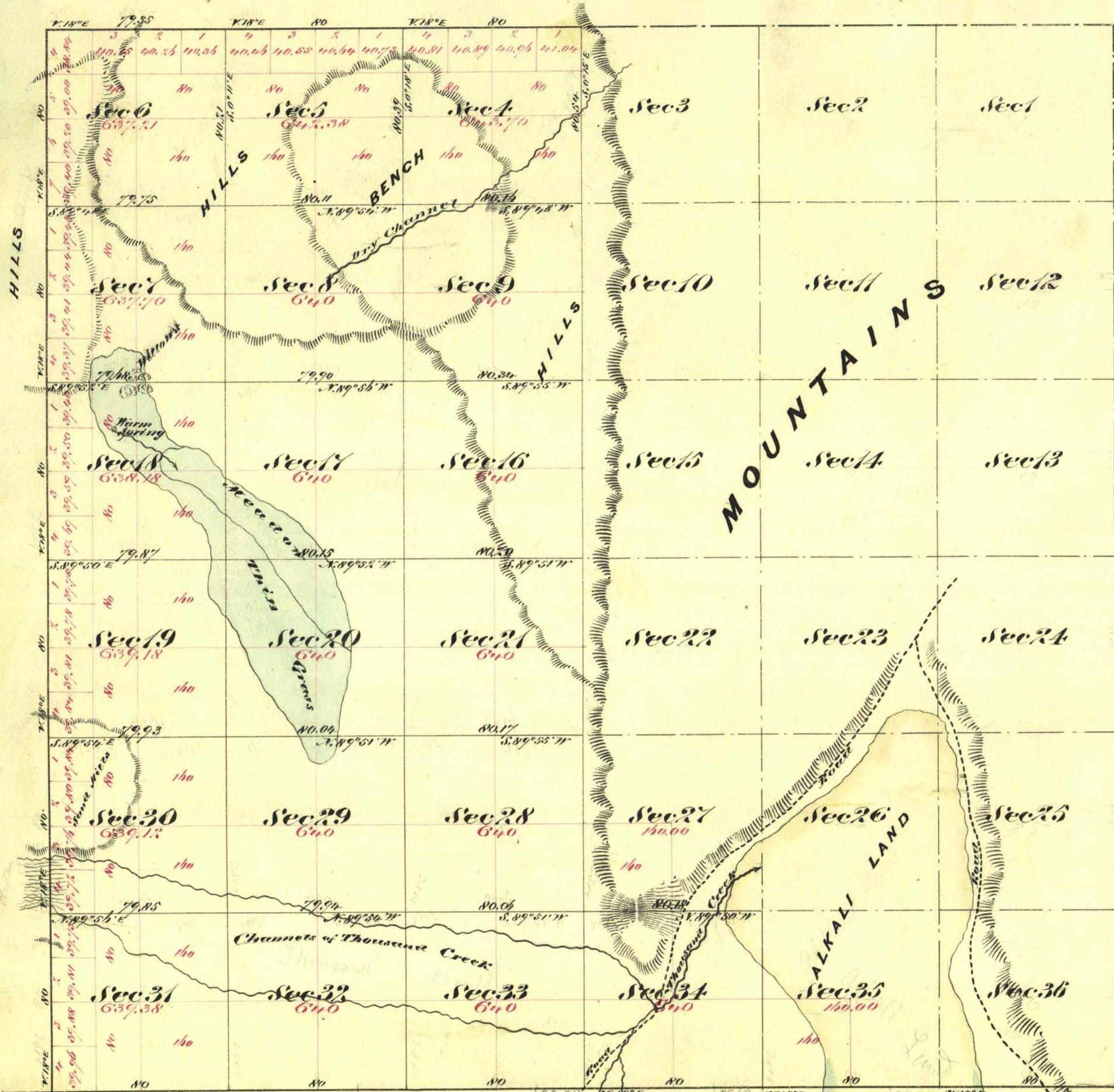

Aggregate Area of Public Land (Surveyed) 12,474.85 Acres
 Estimated " " Mountains (unsurveyed) 10,566.48 "
 Aggregate 23,041.33 "

Commenced September 10th 1874
 Completed " 24th 1874

Subdivision lines not otherwise noted run with a line of 18° East

The above Map of Township N46 North Range N28 East Mount Diablo Meridian is strictly conformable to the field notes of the Surveys thereof on file in this Office which have been examined and approved
 U.S. Surveyor General's Office
 Virginia City Nevada
 October 14th 1874.

For connections see T 45

Surveys Designated	By whom Surveyed	Date of Contract	Am't of Survey Mts. Chs. Secs.	When Surveyed	T ^h Cor.
Township Lines	A. Hatch, D. W. Skinner & C. B. Preble	July 25 th 1874	14 79 35	1874	64
Subdivision Lines	" " " " "	" " "	35 01 47	Sept "	"

0667

T 46 N. R 28 E. YD

E. S. Davis
 U.S. Surveyor General Ariz.