

TOWNSHIP 46 NORTH, RANGE 26 EAST, OF THE MOUNT DIABLO MERIDIAN, NEVADA.  
DEPENDENT RESURVEY, NINTH STANDARD PARALLEL NORTH

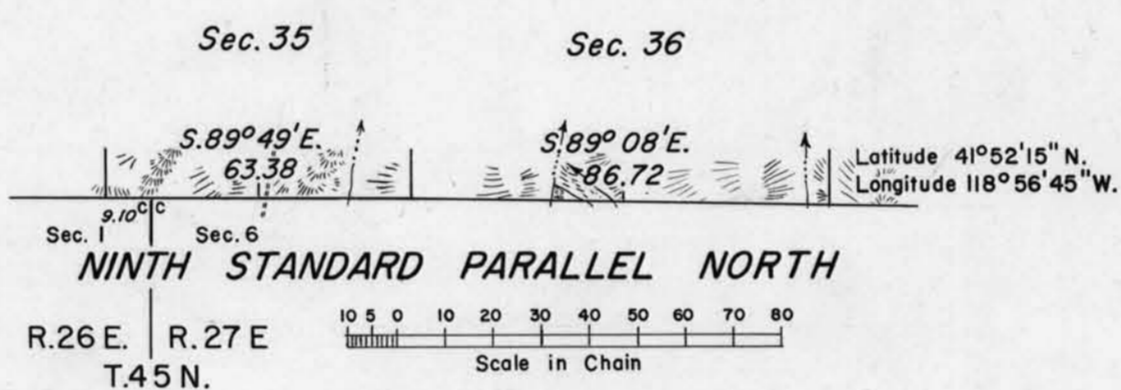
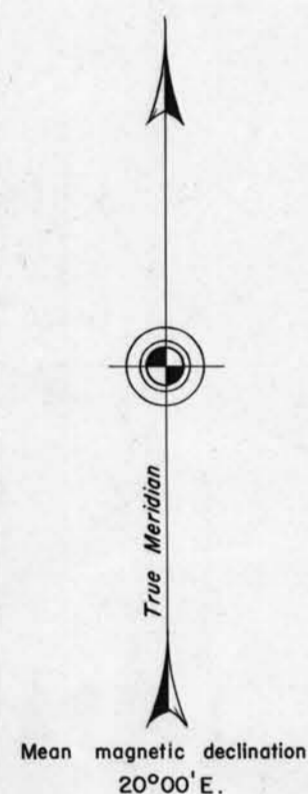

The survey of the 9th Standard Parallel North through R. 26 E. was made by Hatch, Skinner, and Preble in 1874.

The dependent resurvey of a portion of the 9th Standard Parallel North through R. 26 E. was executed by Philip L. Inch September 23 to October 10, 1940 under special instructions dated August 1, 1940 for Group 310, Nevada.

UNITED STATES DEPARTMENT OF THE INTERIOR  
BUREAU OF LAND MANAGEMENT  
Washington, D. C. August 29, 1955

This plat is strictly conformable to the approved field notes, and the survey, having been correctly executed in accordance with the requirements of law and the regulations of this Bureau, is hereby accepted.

For the Director  
*Earl B. Harrington*  
Cadastral Engineering Staff Officer

N

0573-a

T46N, R26E.