

TOWNSHIP N^o 45 NORTH RANGE N^o 50 EAST MOUNT DIABLO MERIDIAN

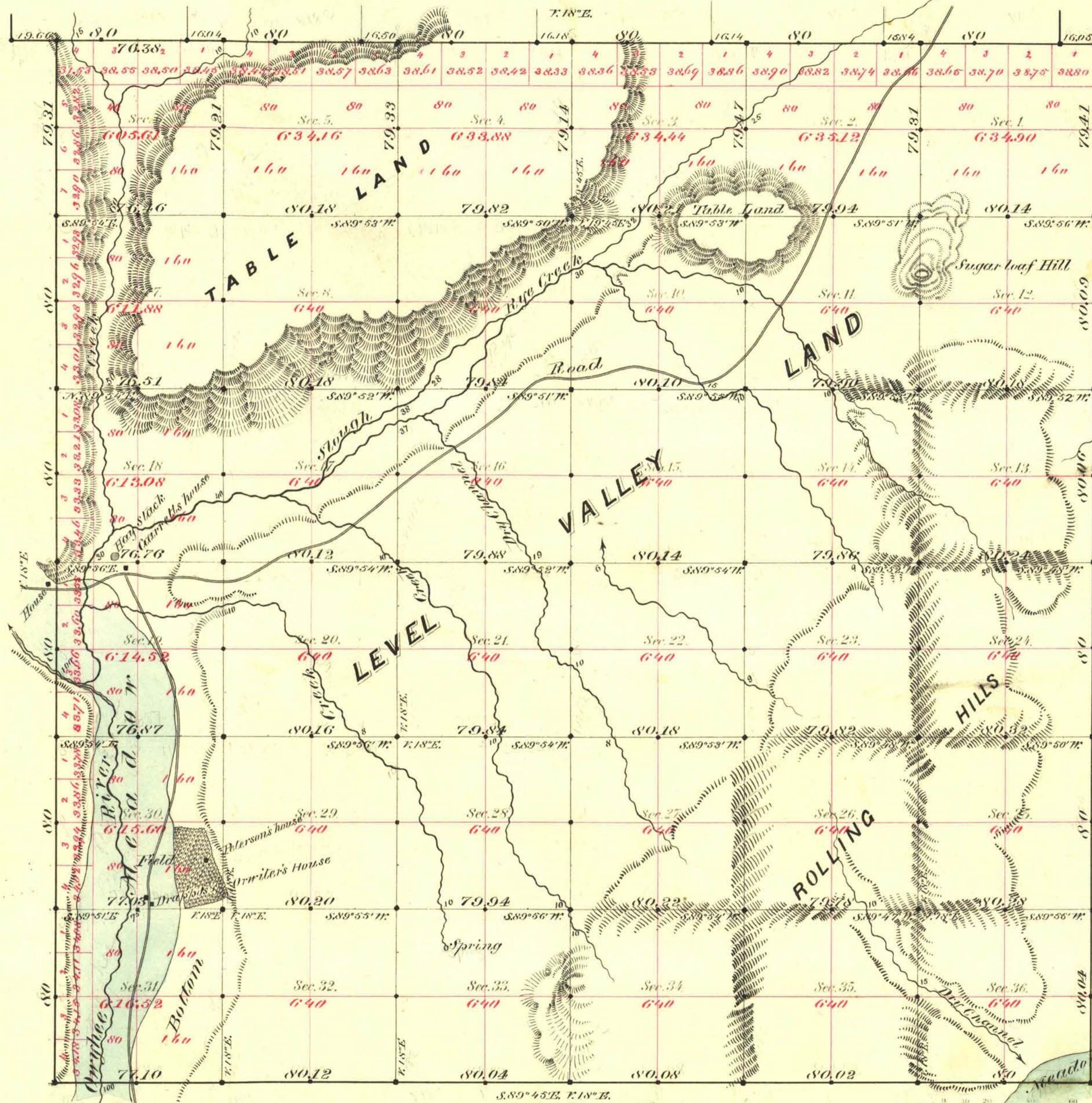

Aggregated Area of Public Land Surveyed 22849.71 Acres

Commenced Aug. 10th 1882
Completed 15th

Subdivisions not noted run with a Var. 18° 15' East.

Surveys Designated	By Whom Surveyed	Date of Contract	Amount of Surveys	When Surveyed	79 th Cor.
N. S. E. & W. B. by Hatch & Eaton		Feb. 6 th 1871	23-75-68	1871	43
N. S. E. & W. (retracted) Fitzpatrick & Smyles		July 25 th 1882	23-76-27	1882	153
Subdivisions			59-61-56	Aug	"
Convergency			1-00-70		"

The above Map of Township N^o 45 North of Range N^o 50 East of Mount Diablo Meridian is strictly conformable to the field notes of the survey thereof on file in this Office, which have been examined and approved.

Surveyor General's Office,
Nevada
December 28th 1882

H. S. Parry
Sur. Gen. Nevada