

# TOWNSHIP N° 45 NORTH RANGE N° 24 EAST MOUNT DIABLO MERIDIAN NEVADA

T. 45½ N., R. 24 E.

DEPENDENT RESURVEY  
Sec. 36  
T. 46 N., R. 23 E.  
N. 89° 20' E. 8.69  
99 St. Par. N.  
T. 45 N., R. 23 E.

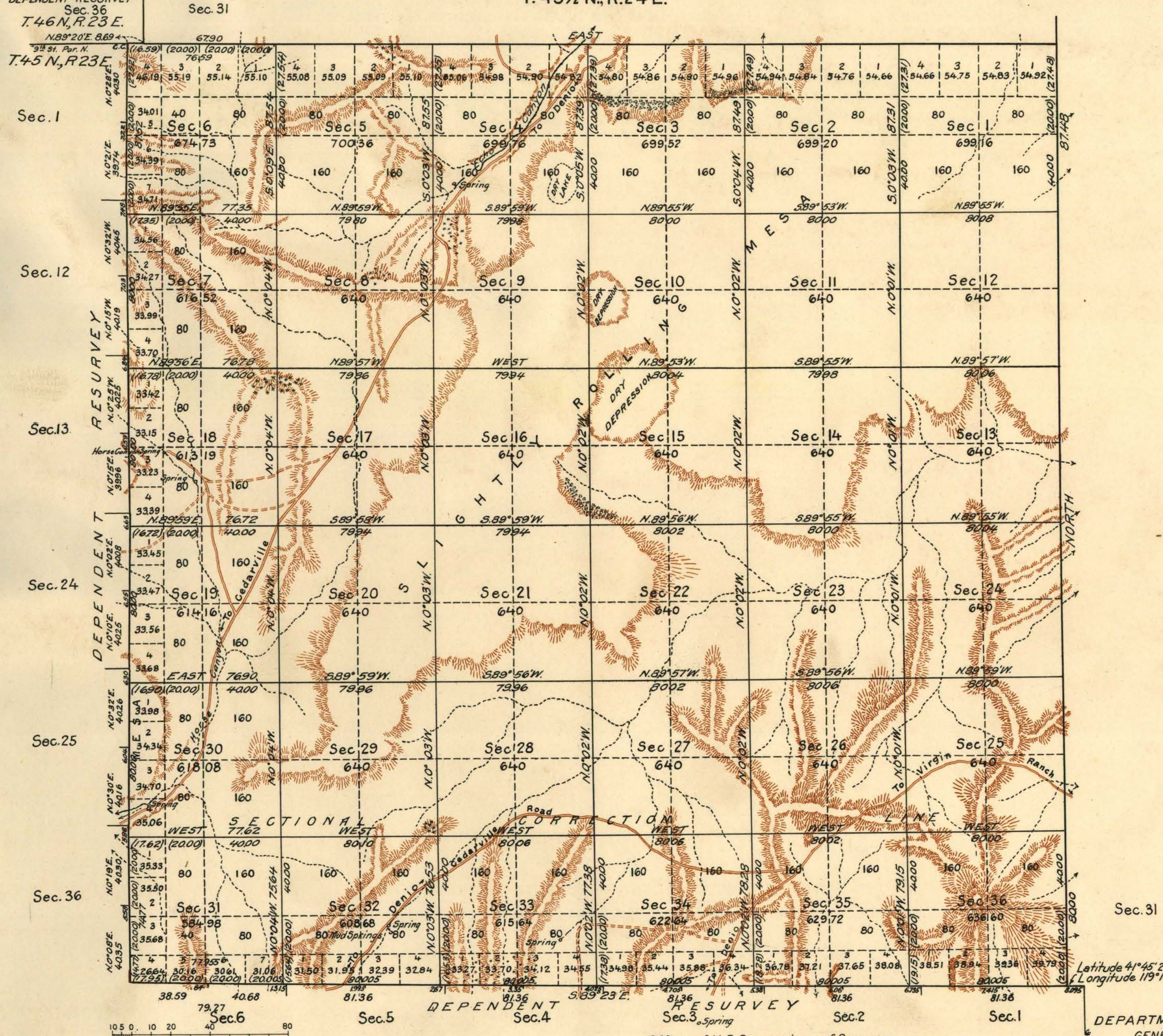

Mean Magnetic Declination,

Scale: 40 Chains to an Inch.

Area Surveyed, 23132.94 Acres.

LINES DESIGNATED	BY WHOM SURVEYED	NO	GROUP DATE	MILEAGE		WHEN SURVEYED	
				MLS.	CHS.	BEGUN	COMPLETED
Exterior	Walter H. Good	134	Feb. 5, 1926	18	6.36	Aug. 11, 1927	Sept. 11, 1927
Subdivisional	" " "	"	" " "	60	9.55	Aug. 13, 1927	Sept. 11, 1927
S. Bdy.	Carl S. Swanholm	"	" " "	6	6.07	" 26, 1929	Aug. 26, 1929.
Miscellaneous							

Office of U.S. Supervisor of Surveys  
Denver, Colorado, Feb. 19, 1931.  
The above plat of Township No. 45 North Range No. 24 East of the Mount Diablo Meridian, Nevada, is strictly conformable to the field notes of the survey thereof which have been examined and approved.

*Walter H. Good*  
U.S. Supervisor of Surveys

DEPARTMENT OF THE INTERIOR  
GENERAL LAND OFFICE  
Washington, D.C., February 27, 1931.  
The survey represented by this plat having been correctly executed in accordance with the requirements of law and the regulations of this office, is hereby accepted.

*John C. Stowell*  
Assistant Commissioner.