

TOWNSHIP N^o 45 NORTH RANGE N^o 23 EAST MOUNT DIABLO MERIDIAN

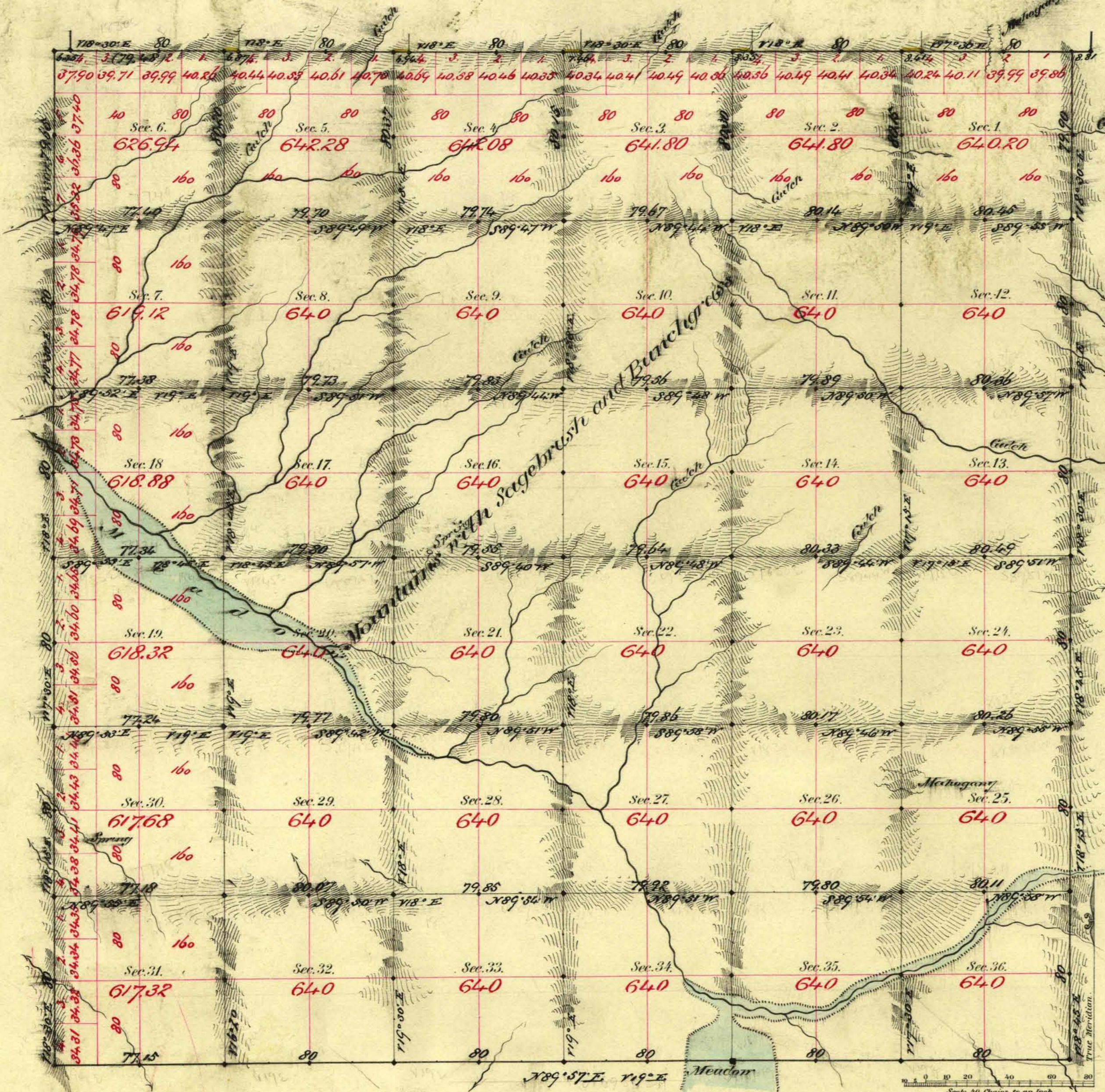

Aggregate Area of Public Land Surveyed 22,924.42 ac.

Commenced January 2nd 1881
Completed " 29th "

Subdivision not ended per with Variation of 18' 30" East

Surveys Designated	By Whom Surveyed	Date of Contract	Amount of Surveys	When Surveyed	N ^o of Cor.
J. L. Ledy	W. H. Hamble	Apr. 11 th 1874	74 - 80	1874	74
J. W. & M. Ledy	B. W. & P. W. Ledy	" 29 th 1880	81 - 86	1881	103
Subdivision of Emergency (yellow)	"	"	87 - 90	January "	"
			91 - 96	" "	"

The above Map of Township N^o 45 North of Range N^o 23 East
Mount Diablo Meridian is strictly conformable to the field
notes of the survey thereof on file in this Office, which have been examined and approved.
Surveyor General's Office,
Virginia City Nev.
March 17th 1881
C. J. Paris, Sur. Gen. Nev.