

TOWNSHIP N° 43 NORTH RANGE N° 68 EAST MOUNT DIABLO MERIDIAN

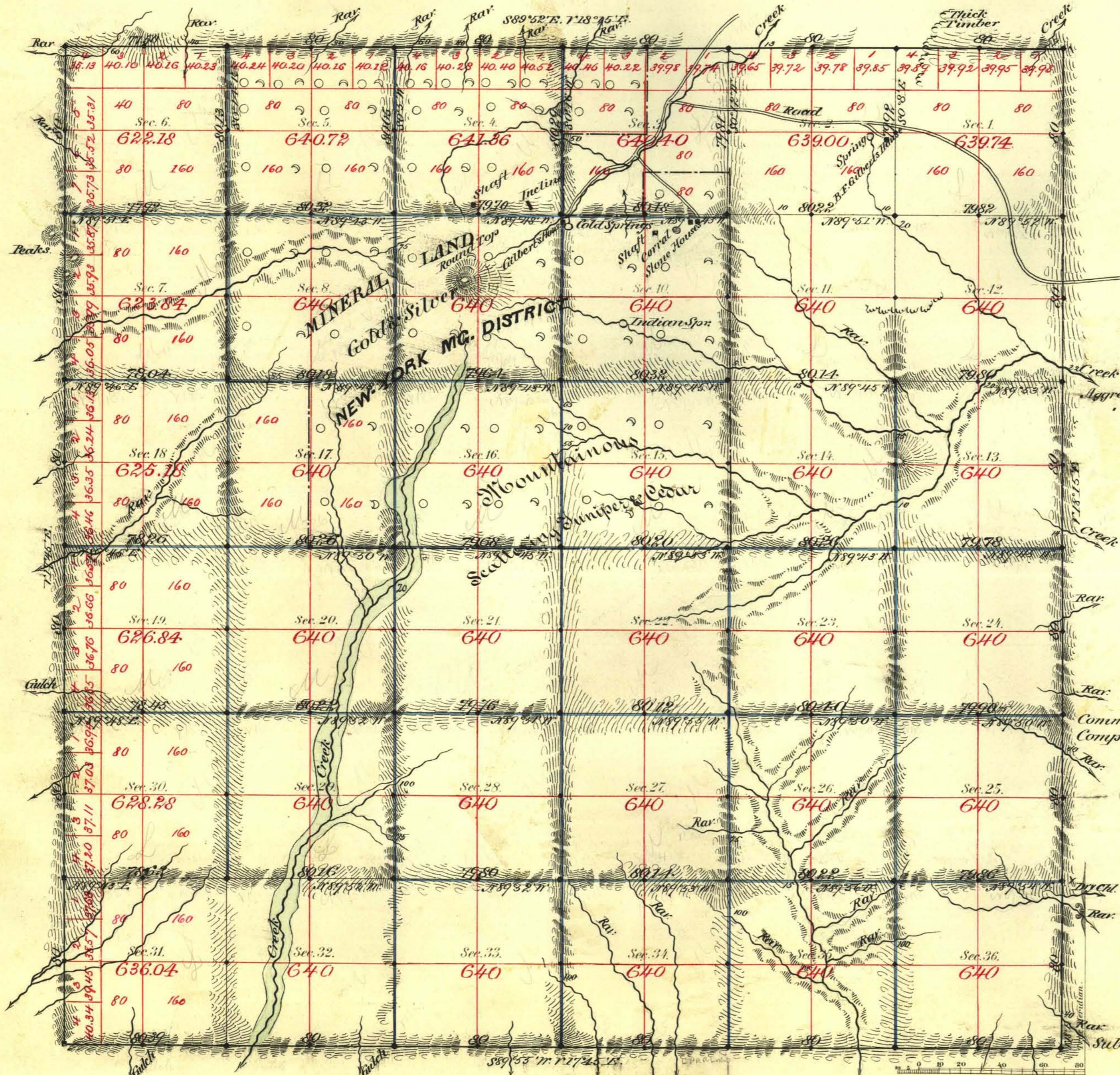

Aggregate Area of Public Land Surveyed 17920.82 Acres.
 " Mineral " 5042.76
 Aggregate 22963.58

Commenced May 27th 1882.
 Completed June 4th "

Subdivisions run with a variation of 18° East.

Surveys Designated	By Whom Surveyed	Date of Contract	Amount of Surveys	When Surveyed
West Boundary	Monroe & McClellan	Feb. 15 th 1881	6- 00- 50	1881
South	"	March 25 th	6- 00- 39	"
N. & E.	"	April 10 th 1882	11- 77- 50	1882
Subdivisions black	"	"	11- 78- 49	May & June
blue	"	"	47- 74- 08	"

7th Cor.
 113
 120
 134
 "

The above Map of Township N° 43 North of Range N° 68 East of Mount Diablo Meridian is strictly conformable to the field notes of the survey thereof on file in this Office, which have been examined and approved.
 Surveyor General's Office,
 Reno, Nevada
 June 26th 1882
 W. S. Parry, Sur. Gen. Nevada