

*Humboldt Nat. Forest*

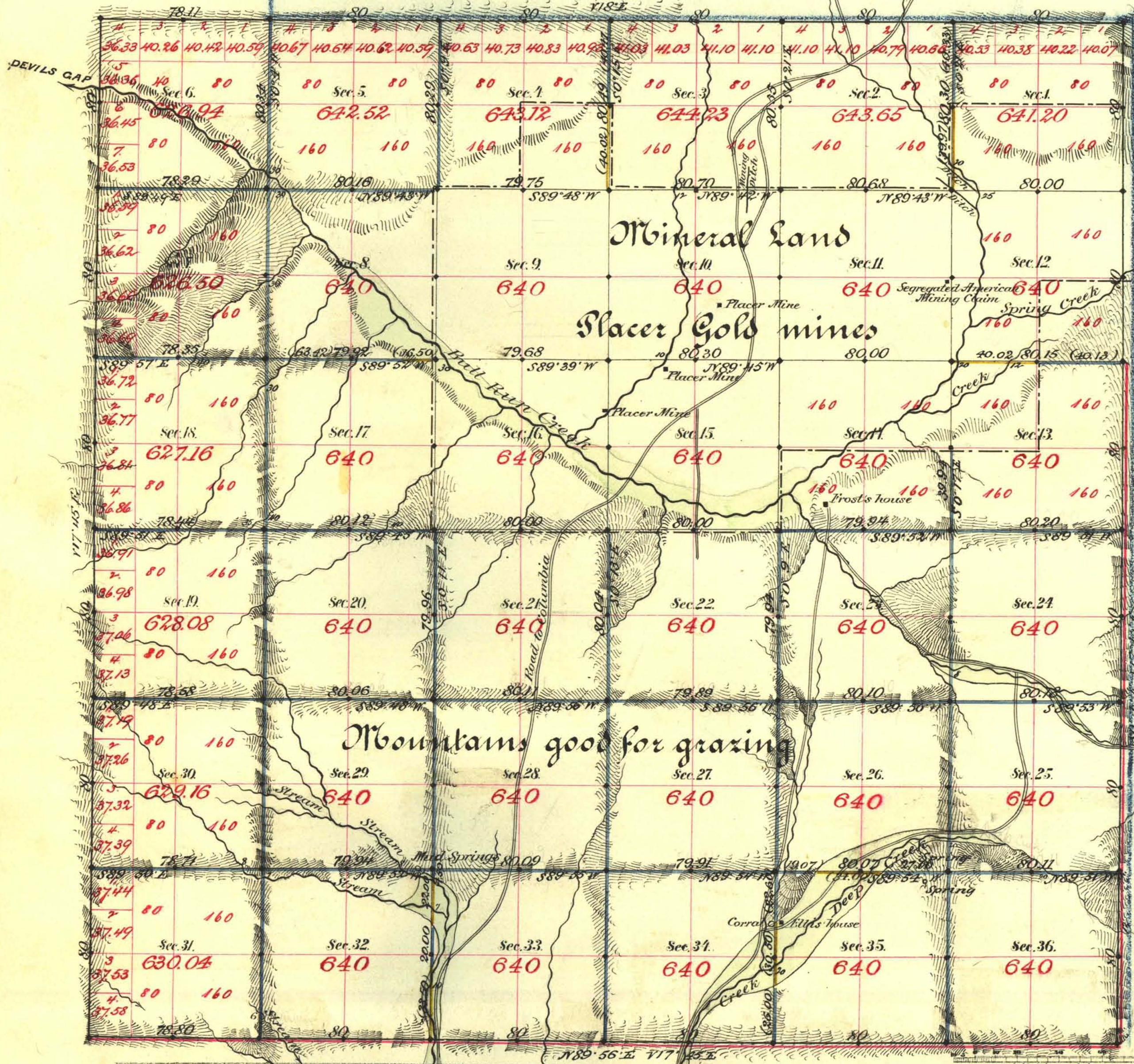

*Humboldt Nat. Forest*  
*Plan. Cont 218*

Aggregate Area of Mineral Land surveyed by

Hatch & Eaton, Feb. 6 <sup>th</sup> 1871	4640.00
Public Land by same	964.40
Stewart & McClellan, March 17 <sup>th</sup> 1884	17378.20
Aggregate	22982.60

Old work commenced April 7<sup>th</sup> 1871  
 " " completed " 10<sup>th</sup> "  
 New " commenced June 9<sup>th</sup> 1884  
 " " completed " 15<sup>th</sup> "

Old surveys approved by E.S. Davis, May 10<sup>th</sup> 1871

Subdivisions run with a var. of 17' 15".

Surveys designated.	By Whom Surveyed.	Date of Contract.	Amount of Surveys.	When surveyed.
N.W. & E. by black	Hatch & Eaton	Feb. 6 <sup>th</sup> 1871	43 - 78 - 77	1871
Subdivs black	"	"	19 - 01 - 60	"
E. red & S. red	Stewart & McClellan	Mar 17 <sup>th</sup> 1884	9 - 78 - 80	1884
Subdivs yellow	"	"	3 - 16 - 51	"
" blue	"	"	39 - 17 - 21	"

*79 Cont*  
 The above Map of Township No. 43 North of Range No. 52 East Mount Diablo Meridian is strictly conformable to the field notes of the survey thereof on file in this Office, which have been examined and approved.  
 Surveyor General's Office, Reno. *b. b. Canning*  
 August 23<sup>rd</sup> 1884  
 U.S. Sur. Gen'l. of Nevada.