

Township N° 43 North

Range N° 23 East

Mount Diablo Meridian

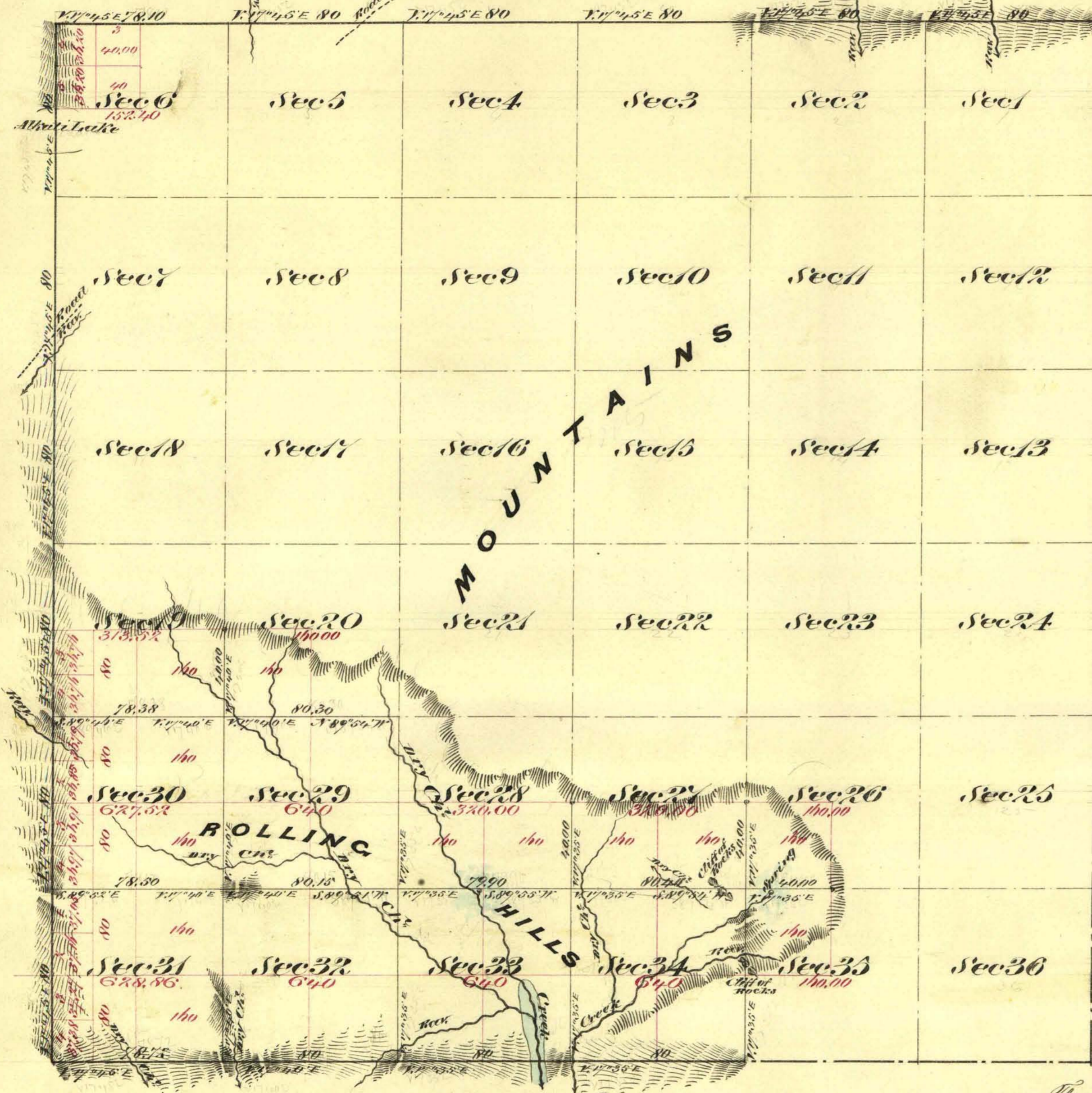

Aggregate Area of Public Land (Surveyed) 5,402.30 Acres  
 Estimated " " Mountains (unsurveyed) 17,579.76 "  
 Aggregate 22,982.06 "

Commenced February 10<sup>th</sup> 1875  
 Completed " " 11<sup>th</sup> 1875

Surveys Designated	By Whom Surveyed	Date of Contract	Am't of Conty. Accts. etc.	When Surveyed	
N.W. Boundary	G. W. Sawside & S. Preble	Nov <sup>r</sup> 18 <sup>th</sup> 1873	11 78 10	1873	061
Subdivision lines	" " " " "	Dec <sup>r</sup> 31 <sup>st</sup> 1874	3 78 72	1875	067
	" " " " "	" " "	13 77 63	Feb <sup>r</sup> 27 1875	067

The above Map of Township N° 43 North Range N° 23 East Mount Diablo Meridian is strictly conformable to the filed notes of the surveys thereof on file in this Office, which have been examined and approved by the U.S. Surveyor General's Office, Virginia City Nevada April 17<sup>th</sup> 1875

0402

E. S. Davis  
 U.S. Surveyor General Nevada  
 T43N, R23E V.D.