

Township N^o 42 North

Range N^o 27 East

Mount Diablo Meridian

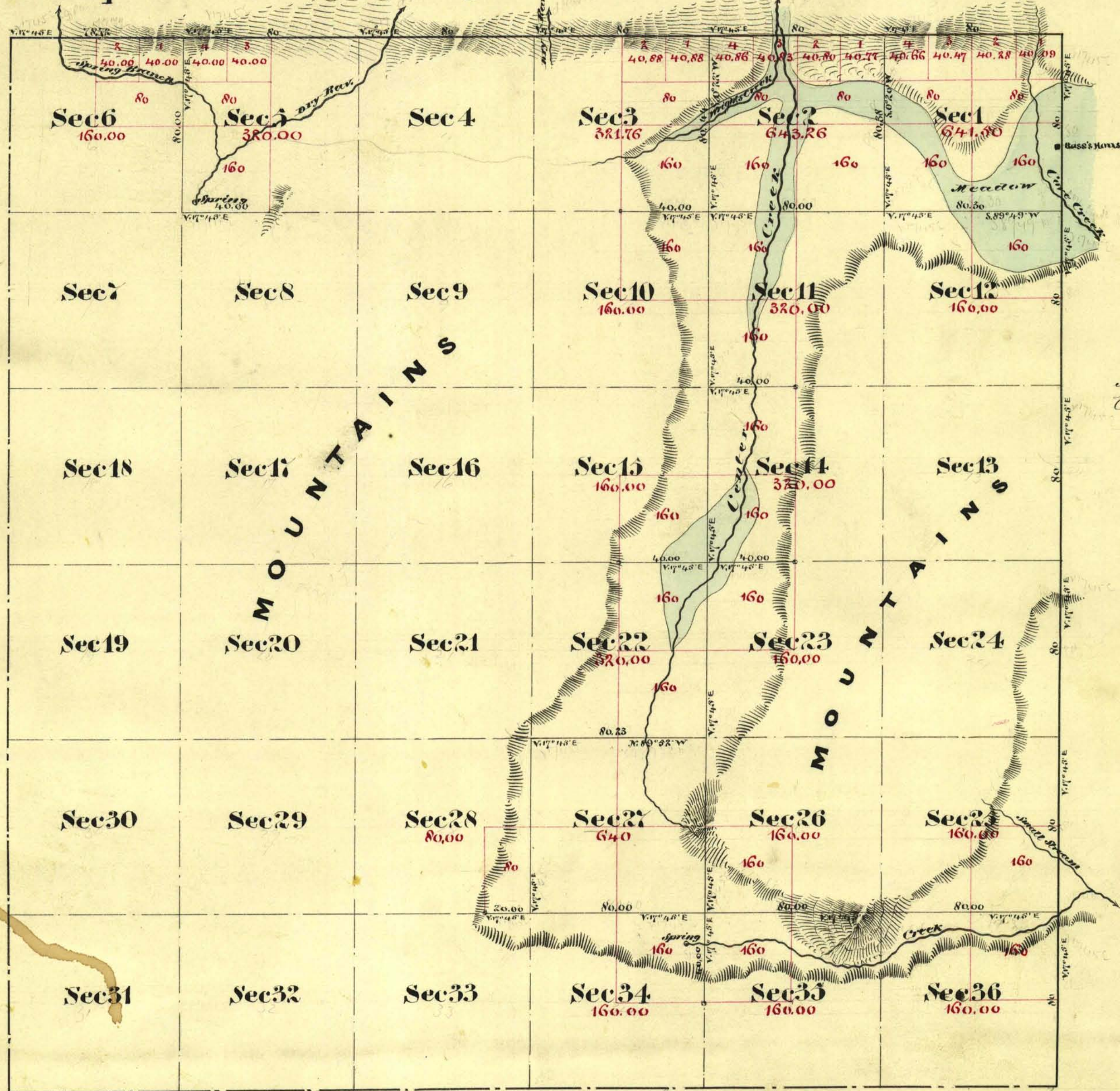

Aggregate Area of Public Land (Surveyed) 5,206.52 Acres
 Estimated " " Mountains (unsurveyed) 17,781.98 "
 Aggregate 22,988.50 "

Commenced February 1st 1873
 Completed " 3rd "

Surveyed Cont 58-

Survey Designated	By Whom Surveyed	Date of Contract	Am ^t of Survey When Surveyed	No ^o Cont.
Township Lines	E. W. Garside	December 1 st 1872	11 78 72	1872
Subdivision "	" "	" "	17 21 35	February 1873

The above map of Township N^o 42 North Range N^o 27 East Mount Diablo Meridian is strictly conformable to the field notes of the surveys thereof on file in this office which have been examined and approved
 U. S. Surveyor General's Office
 Virginia City Nevada
 April 17th 1873

0608

T42N, R27E

E. S. Davis
 U. S. Surveyor General Nevada

V.D.