

TOWNSHIP N° 42 NORTH, RANGE N° 24½ EAST, OF THE MOUNT DIABLO MERIDIAN, NEVADA.

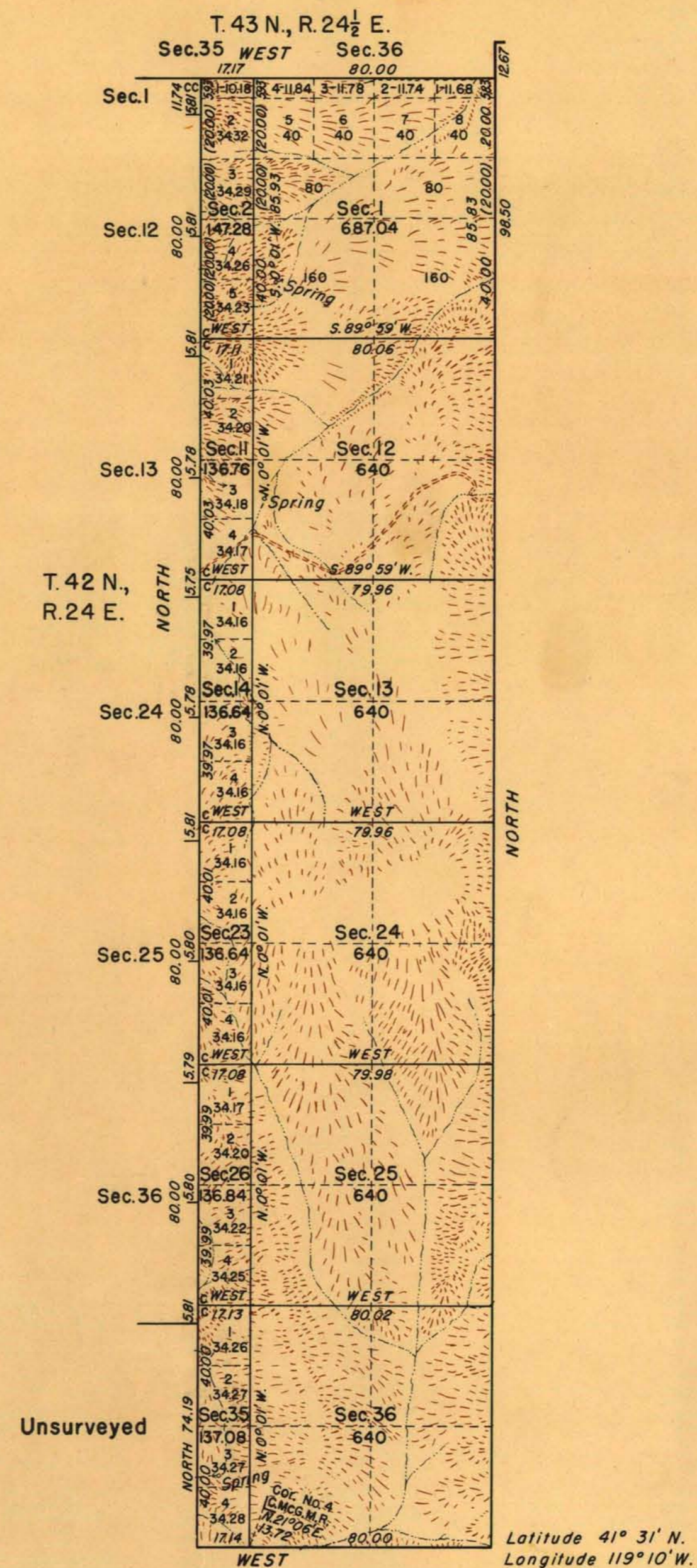

Unsurveyed

Area surveyed: 4718.28 Acres

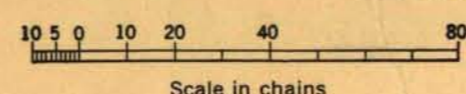

Portion of West boundary surveyed in 1915, and North boundary in 1918.

Portion of West boundary, South and East boundaries and subdivisional lines surveyed by James W. Hardison, beginning September 23, 1946, and completed October 21, 1946, pursuant to special instructions for Group No. 342, dated April 17, 1946.

UNITED STATES DEPARTMENT OF THE INTERIOR
 BUREAU OF LAND MANAGEMENT
 Washington, D. C. September 27, 1948

This plat is strictly conformable to the approved field notes, and the survey, having been correctly executed in accordance with the requirements of law and the regulations of this bureau, is hereby accepted.

For the Director:
William F. Richards
 Acting Chief, Branch of Surveys