

TOWNSHIP 42 NORTH, RANGE 22 EAST, OF THE MOUNT DIABLO MERIDIAN, NEVADA
DEPENDENT RESURVEY

OFFICIALLY FILED
NEVADA STATE OFFICE
at 10:00 AM on SEPTEMBER 15, 1993

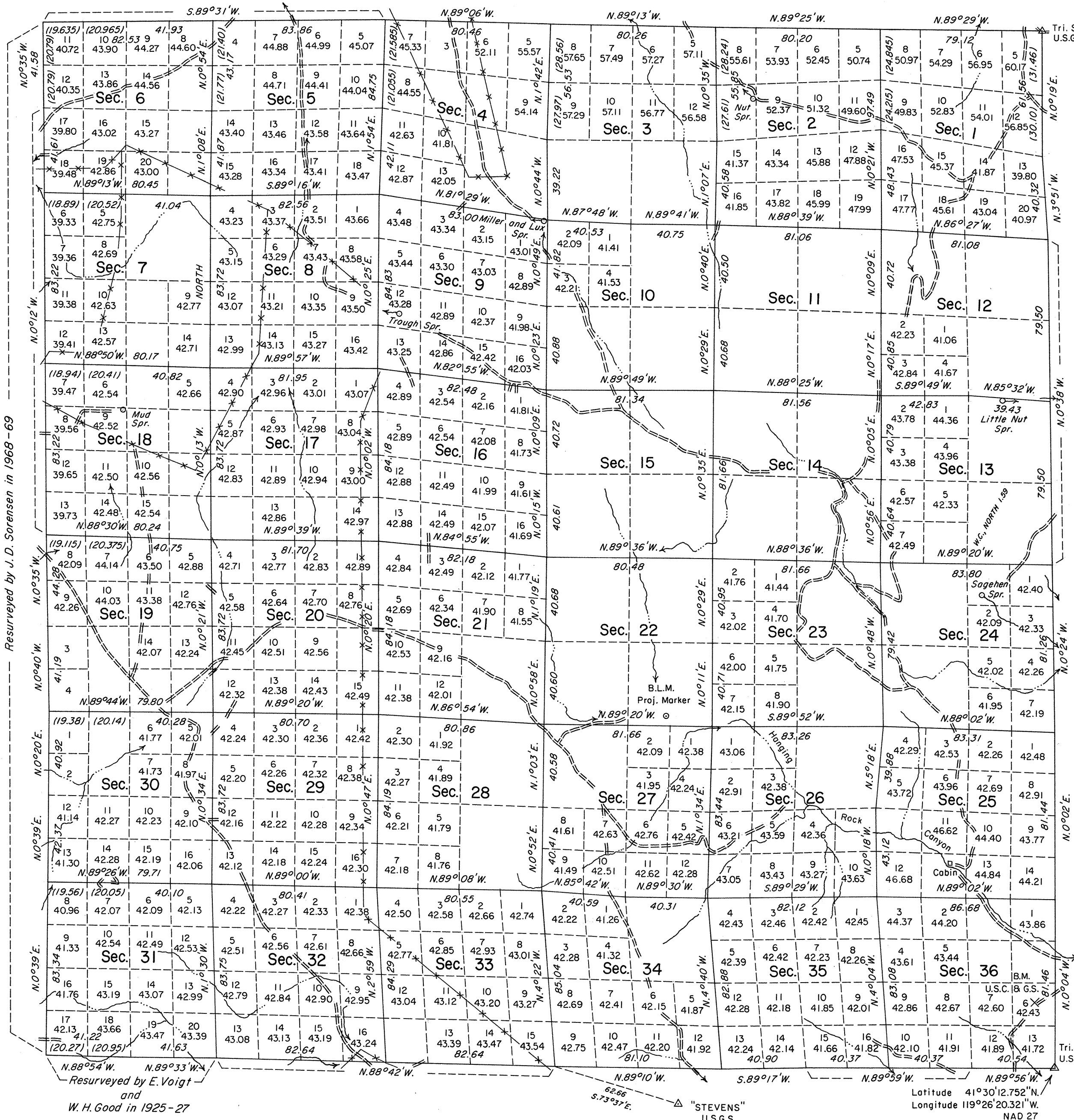

Spr.

History of the earlier surveys is contained in the field notes.

This plat represents the dependent resurvey of a portion of the south boundary, the east and north boundaries and the subdivisional lines of T. 42 N., R. 22 E., Mount Diablo Meridian, Nevada, designed to restore the corners in their true original locations according to the best available evidence.

Lottings and areas, except as indicated hereon, are as shown on the plats approved April 17, 1875, and June 20, 1877.

Survey executed by Ronald E. Williams, Cadastral Surveyor, beginning August 29, 1989 and completed November 2, 1989, under Special Instructions dated July 3, 1989, for Group No. 679, Nevada.

UNITED STATES DEPARTMENT OF THE INTERIOR
BUREAU OF LAND MANAGEMENT
Reno, Nevada September 8, 1993

This plat is strictly conformable to the approved field notes, and the survey, having been correctly executed in accordance with the requirements of law and the regulations of this Bureau, is hereby accepted.

For the Director

John J. Parrish

Chief Cadastral Surveyor, Nevada

Resurveyed by J. D. Sorensen in 1968 - 69

Resurveyed by E. Voigt and W. H. Good in 1925 - 27

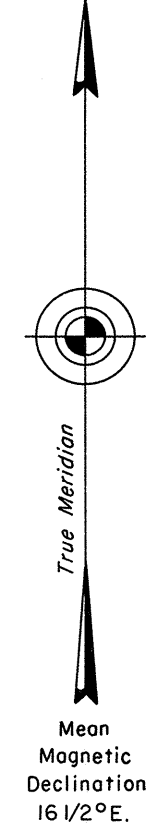
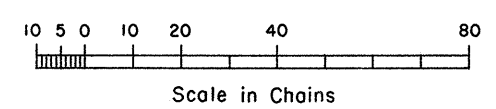

MU

T.42N., R.22E., M.D.M.