

Township N^o 42 North

Range N^o 21 East

Mount Diablo Meridian

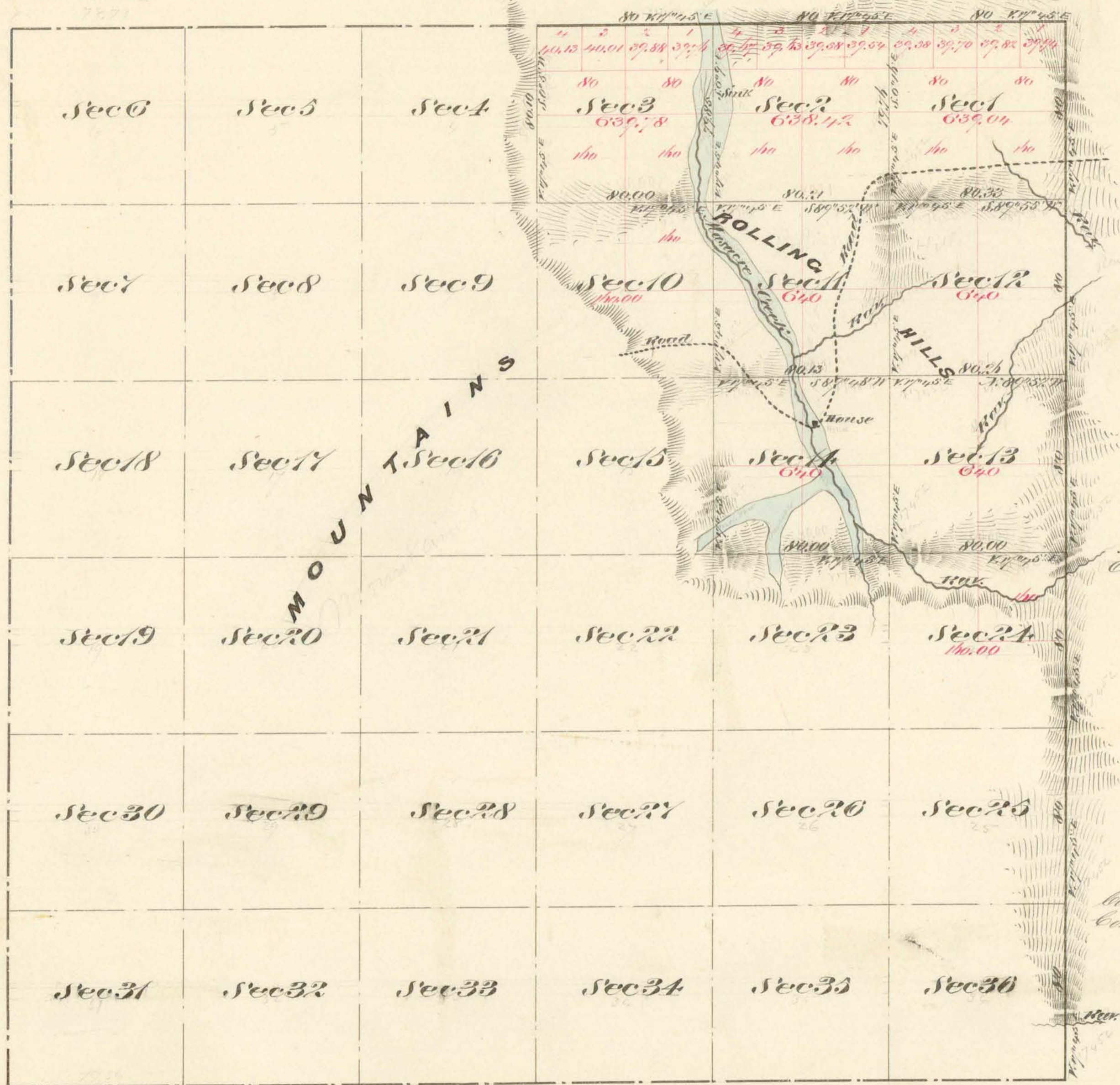

Aggregate Area of Public Land (Surveyed) 4,797.24 Acres
 Estimated " " Mountains (unsurveyed) 15,206.72 "
 Aggregate 20,003.96 "

Commenced January 15th 1874
 Completed January 15th 1874

Surveys Designated	By Whom Surveyed	Date of Contract	Acres of Survey	When Surveyed
Township Lines	W. J. Ganside & C. S. Davis	Nov ^r 15 th 1873	9 00 00	1874
Subdivision Lines	" " " "	" " "	24 00 00	January 1874

The above Map of Township N^o 42 North Range N^o 21 East Mount Diablo Meridian is strictly conformable to the field notes of the Surveyors thereof on file in this Office, which have been examined and approved by the Surveyor General's Office Virginia City Nevada March 25th 1874

C. S. Davis
 West. Surveyor Gen'l Nevada