

Township N<sup>o</sup> 42 North Range N<sup>o</sup> 18 East Mount Diablo Meridian

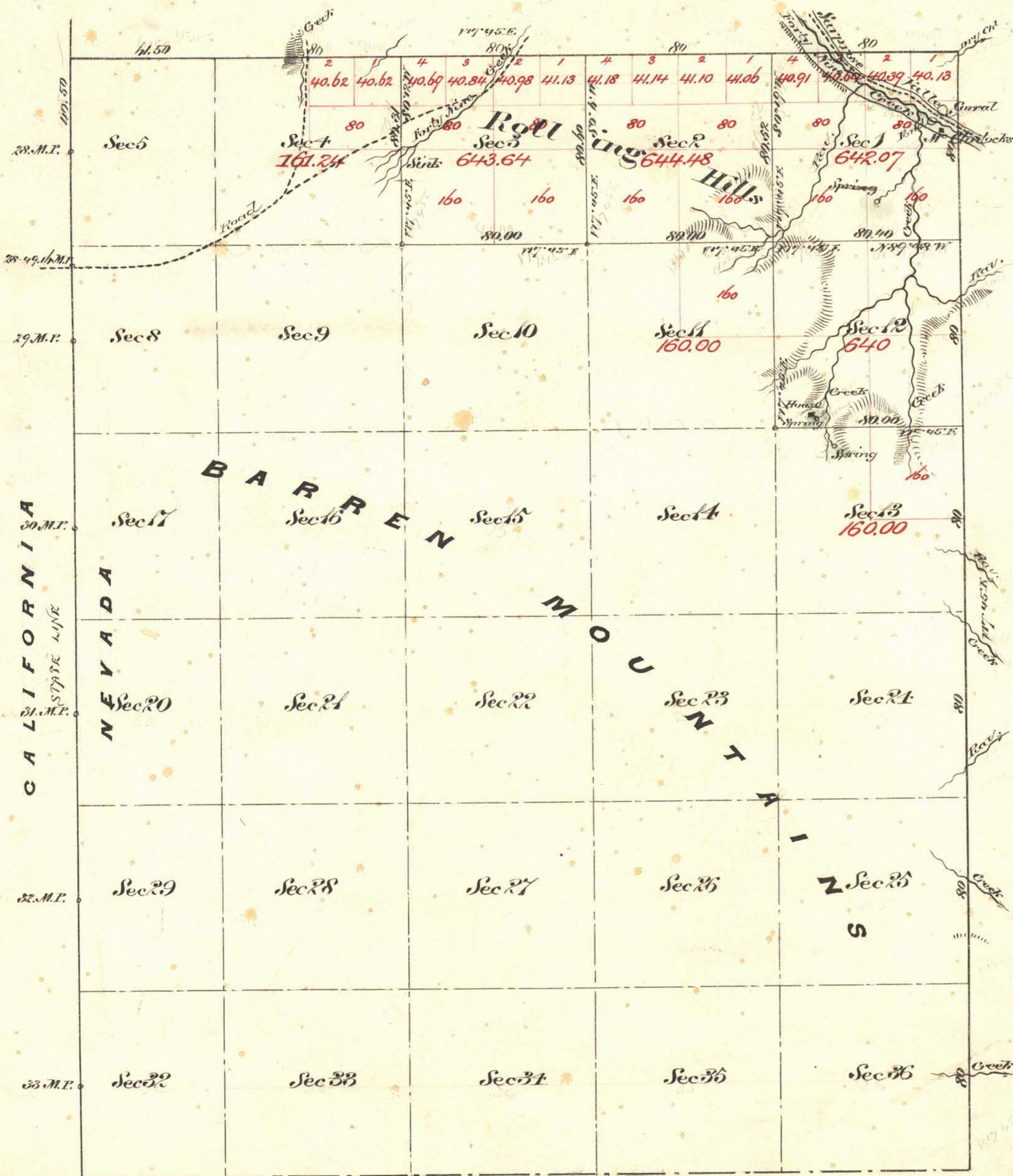

Aggregate Area of Public Land Surveyed  
 Estimated " " Barren Mountains Unsurveyed  
 3,061.43 Ac.  
 16,273.24 "  
 19,334.67 "

Commenced May 12<sup>th</sup> 1879  
 Completed " " "

Surveys designated	By whom surveyed	Date of Contract	Am't of Surveys	When surveyed
W. boundary (State Line)	J. W. Von Schmidt	July 20 <sup>th</sup> 1877		1877
N.E. "	G. H. Geuride	Mar. 26 <sup>th</sup> 1879	10-61-50	1879
Subdivisions	"	"	8-01-83	Mar "

The above plat of Township N<sup>o</sup> 42 North, Range N<sup>o</sup> 18 East Mount Diablo Meridian is strictly conformable to the field notes of the survey thereof on file in this office which have been examined and approved  
 U.S. Surv. Genl. Office  
 Virginia City Nev.  
 July 24<sup>th</sup> 1879  
 G. S. Davis  
 U.S. Surv. Genl. Sec.