

TOWNSHIP N^o 41 NORTH RANGE N^o 52 EAST MOUNT DIABLO MERIDIAN

Independence Mts.

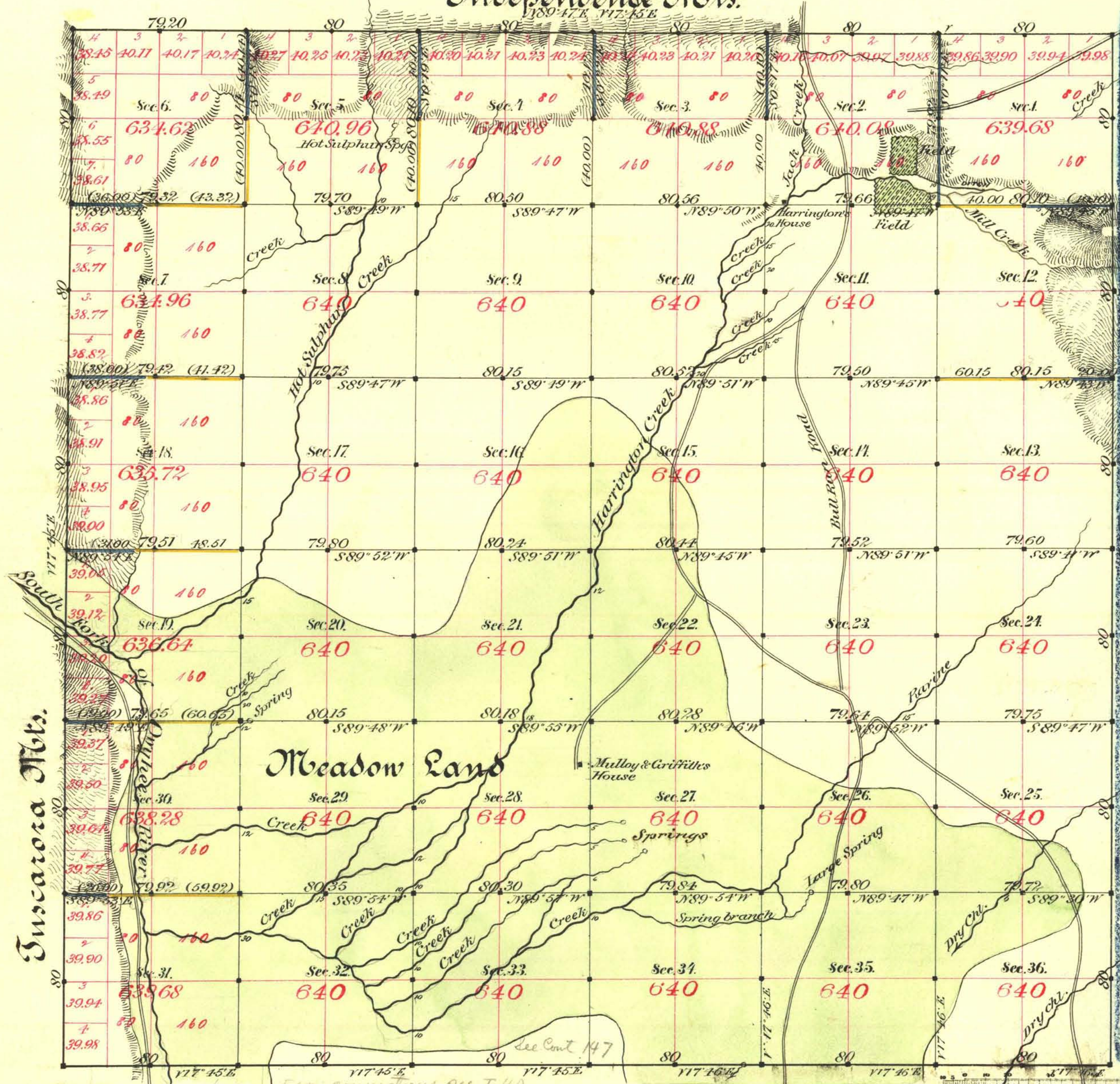

Humboldt Nat. Forest
Resur. Cont 232

Aggregate area of Public Land surveyed 18160.00
 by Makb & Eaton Nov. 26th 1870
 " " Stewart & McCallan Mar. 14th 1884 4862.38
 Aggregate 23022.38

Old work commenced Jan. 14th 1871
 " " completed " 20th "
 New " commenced May 26th 1884
 " " completed " 28th "

Old surveys approved by E. S. Davis Feb. 25th 1871

Subdivs not noted run with a Var. of 17° 45' E.

Surveys designated.	By whom surveyed.	Date of Contract.	Amount of Surveys.	When surveyed.
Township lines	Makb & Eaton	Nov. 26 th 1870	23 - 29 - 36	1870
Subdivs black	"	"	33 - 19 - 35	Jan 1871
" yellow	Stewart & McCallan	Mar. 14 th 1884	5 - 33 - 37	May 1884
" blue	"	"	5 - 44 - 48	"

7th Cont
 The above Map of Township No. 41 North of Range No. 52 East Mount Diablo Meridian is strictly conformable to the field notes of the survey thereof on file in this Office, which have been examined and approved.
 Surveyor General's Office, Reno, *B. B. Conning*
 U.S. Surv. Genl. of Nevada.
 August 23rd 1884