

Township N° 41 North

Range N° 52 East

Mount Diablo Meridian

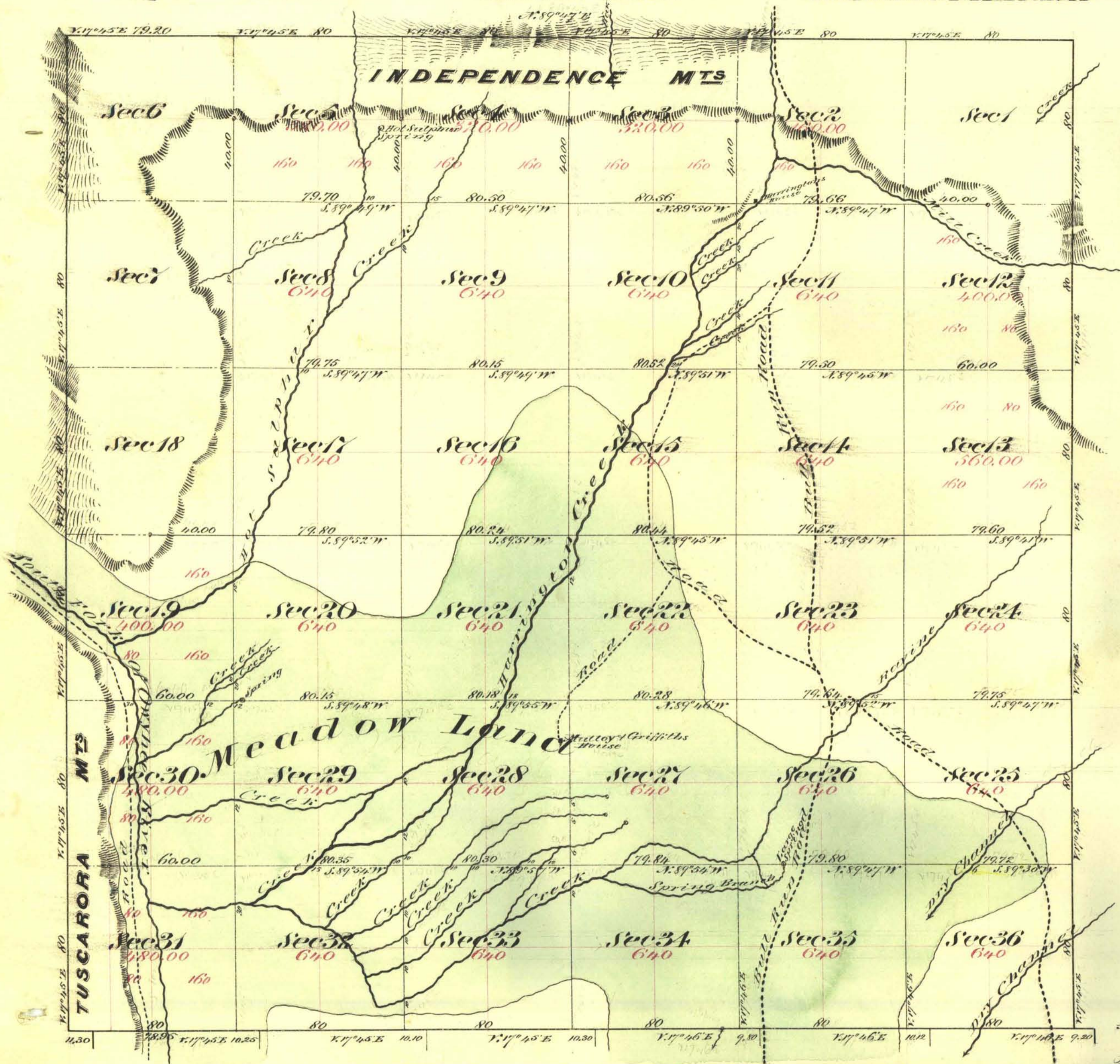

Aggregate Area of Public Land Surveyed) 13,160.00 Acres
 Estimated " " Mountains (unsurveyed) 4,560.80 " " " "
 Aggregate 23,020.80 " " "

Commenced January 14th 1871
 Completed January 20th 1871

Subdivision Lines not Otherwise noted run with a Variation of 17° 45' E

Survey Designated	By Whom Surveyed	Date of Contract	Amount of Survey M ^o C ^t S ^c	When Surveyed
Township Lines	A. J. Hatch & Co.	November 26 th 1870	23 79 20	1870
Subdivision Lines	" " " "	" " " "	33 19 95	January 1871

The above Map of Township N° 41 North Range N° 52 East Mount Diablo Meridian is strictly conformable to the field notes of the Surveyors thereof on file in this Office, which have been examined and approved
 W. S. Sawyer General's Office
 Virginia City Nevada
 February 28th 1871

2055

E. S. Paxon
 W. S. Sawyer General Nevada
 T 41 N, R 52 E