

TOWNSHIP N<sup>o</sup> 41 NORTH RANGE N<sup>o</sup> 51 EAST MOUNT DIABLO MERIDIAN

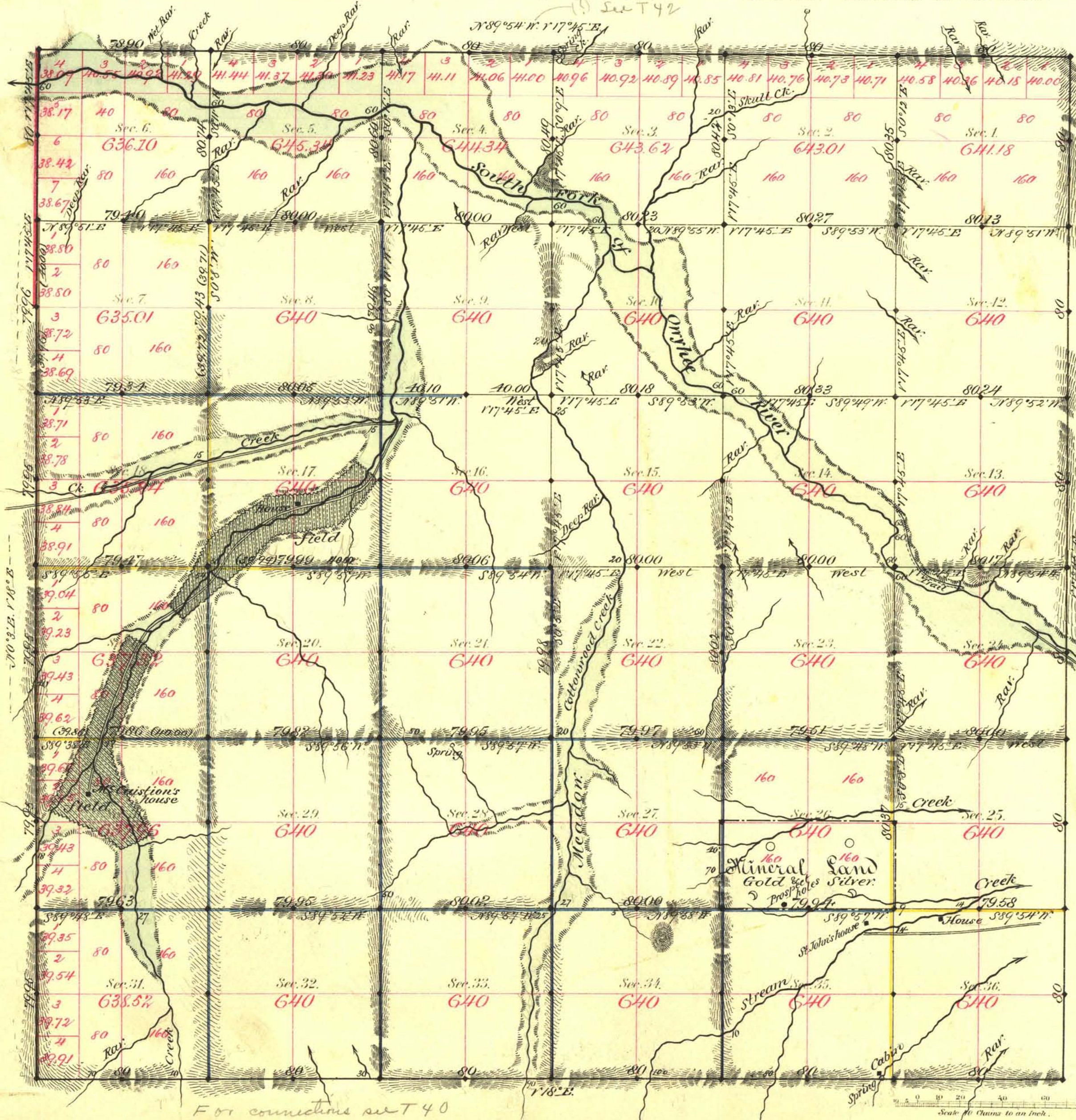

Aggregate Area of Public Land Surveyed by  
 Hatch & Eaton (Contract Apr. 1<sup>st</sup> 1873) 9291.20 Ac.  
 " " Public Land Surveyed by  
 Bell & Bell (Contract July 15<sup>th</sup> 1882) 13426.45 "  
 " " Mineral Land Surveyed 320.00 "  
 Aggregate 23037.65 "

Old Work commenced April 25<sup>th</sup> 1873.  
 " " completed " 27<sup>th</sup> "  
 New " commenced Aug. 3<sup>rd</sup> 1882.  
 " " completed " 6<sup>th</sup> "

Subdivisions not noted run Variation 18<sup>o</sup> East.

For connections see T 40

Surveys Designated	By Whom Surveyed	Date of Contract	Amount of Surveys	When Surveyed	N <sup>o</sup> of Cor.
East Boundary	Hatch & Eaton	Nov. 26 <sup>th</sup> 1870	8 - 06 <sup>th</sup> 00 <sup>th</sup>	1870	41
West " (red)	"	April 1 <sup>st</sup> 1873	7 - 38 - 90	1873	56
South " (brown)	Bell & Bell	July 15 <sup>th</sup> 1882	10 - 79 - 76	1882	147
Subdivisions (black)	Hatch & Eaton	April 1 <sup>st</sup> 1873	25 - 43 - 55	April 1873	56
" (yellow)	Bell & Bell	July 15 <sup>th</sup> 1882	6 - 38 - 98	Aug. 1882	147
" (blue)	"	"	27 - 77 - 52	"	"

The above Map of Township N<sup>o</sup> 41 North of Range N<sup>o</sup> 51 East of Mount Diablo Meridian is strictly conformable to the field notes of the survey thereof on file in this Office, which have been examined and approved.

Surveyor General's Office,  
 Reno Nevada

Edw. C. Davis  
 Sur. Gen. Nevada

Old work approved June 24<sup>th</sup> 1873.  
 New " " October 14<sup>th</sup> 1882.