

TOWNSHIP N^o 41 NORTH RANGE N^o 49 EAST MOUNT DIABLO MERIDIAN

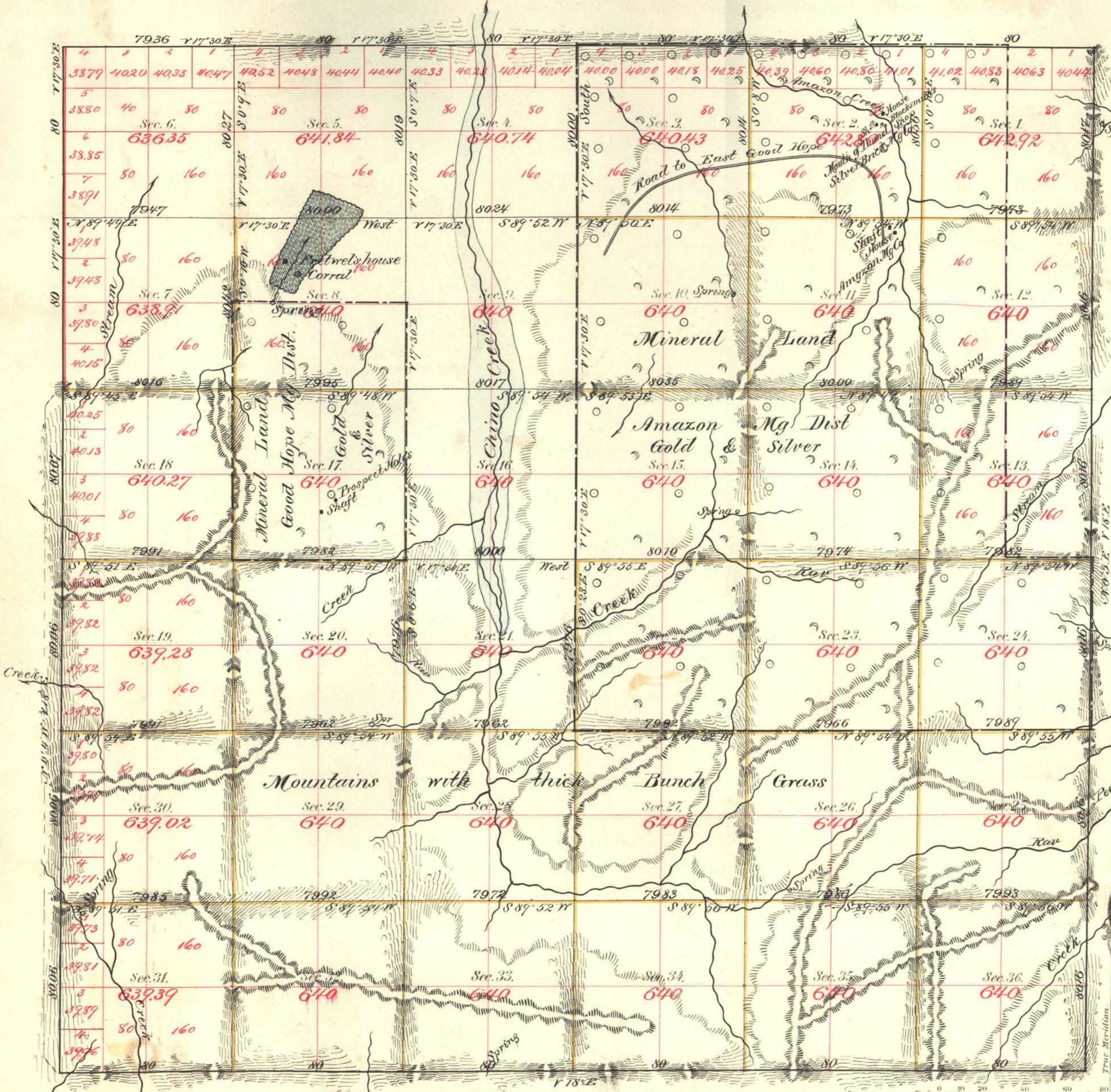

Aggregate Area of Public Land Surveyed by Hatch & Eaton (April 1st 1873) 3677.89 Acres
 Public Land Surveyed by Bell & Bell (July 15th 1882) 11678.98 "
 Mineral Land Surveyed by Bell & Bell 7685.08 "
 Aggregate 23041.95 "

Old Work Commenced May 1st 1873
 Completed 2nd
 New Work Commenced Aug 13th 1882
 Completed 18th

Subdivisions not noted run Var. 18° East

For connections see T 40

Survey Designated	By Whom Surveyed	Date of Contract	Amount of Survey	When Surveyed
N.W. Bdy (red)	Hatch & Eaton	April 1 st 1873	M. 7-79-36	1873
N. black) S.W. Bdy	Bell & Bell	July 15 th 1882	16-01-22	1882
Subdivisions (black)	Hatch & Eaton	April 1 st 1873	12-00-34	May 1873
" (yellow)	Bell & Bell	July 15 th 1882	47-77-71	Aug 1882

The above Map of Township N^o 41 North of Range N^o 49 East of Mount Diablo Meridian is strictly conformable to the field notes of the survey thereof on file in this Office, which have been examined and approved.
 Surveyor General's Office, Reno Nevada
 D. J. Parry, Sur. Gen. Nevada
 Old Work approved June 21st 1873
 New Work approved October 14th 1882

A. L. Baumbach & Co. Lith. S. F.