

TOWNSHIP N^o 41 NORTH RANGE N^o 48 EAST MOUNT DIABLO MERIDIAN

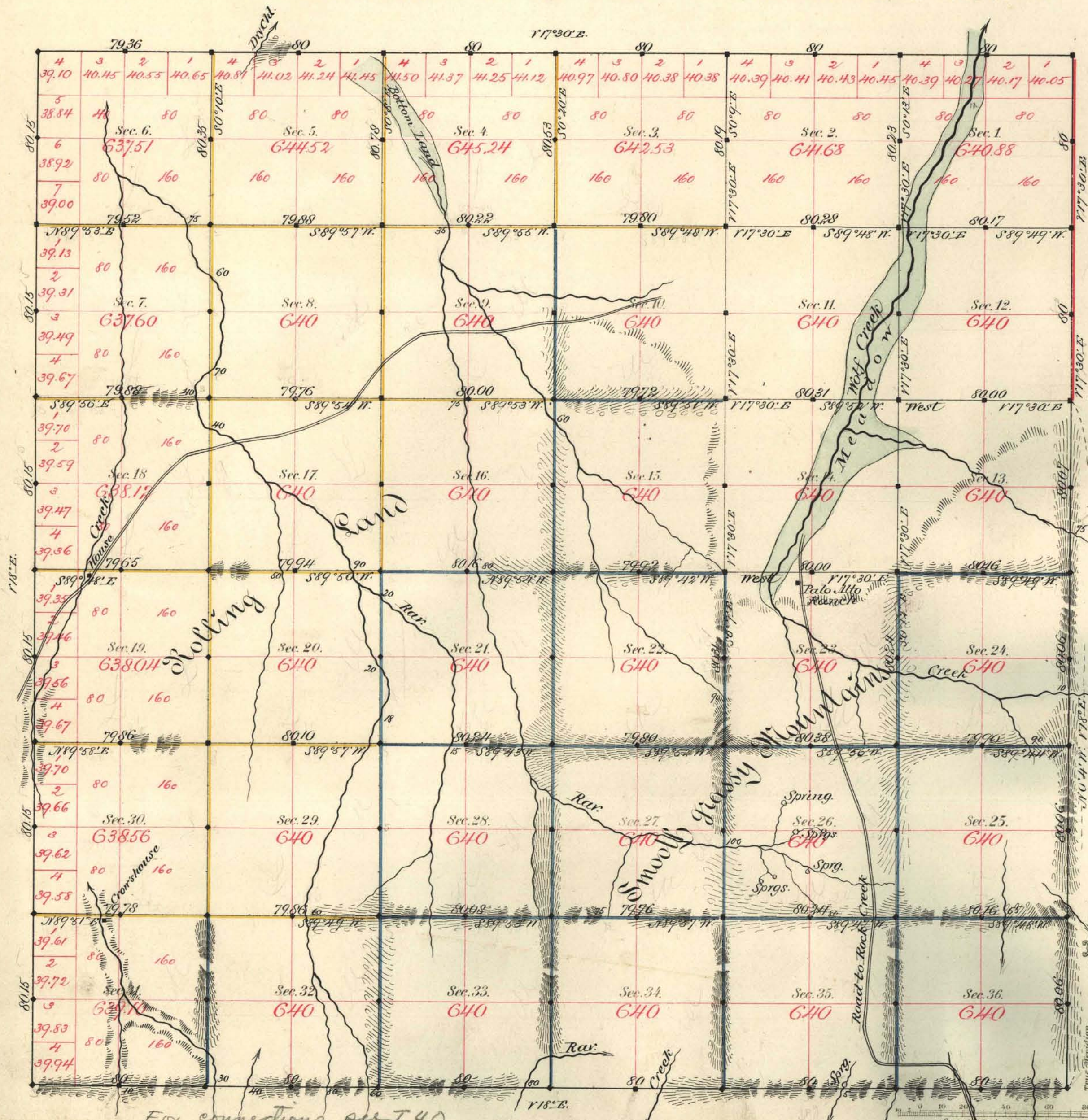

Aggregate Area of Public Land Surveyed by
 Hatch & Eaton (April 1st 1873) 3523.32 Acres
 Public Land Surveyed by
 Bell & Bell (July 15th 1882) 19520.46 "
 Aggregate 23043.78 "

Old Work commenced May 19th 1873
 Completed
 New Work commenced Aug. 19th 1882
 Completed 21th

Subdivisions not noted run with a Variation of 18" East.

For connections see T 40

Surveys Designated	By Whom Surveyed	Date of Contract	Amount of Surveys	When Surveyed
N. 41 N. & E. 112	Hatch & Eaton	April 1 st 1873	27-79-156	1873
E. 112 S. & N. 41 N.	Bell & Bell	July 15 th 1882	16-01-95	1882
Subdiv. 24	Hatch & Eaton	April 1 st 1873	11-01-18	May 1873
" yellow	Bell & Bell	July 15 th 1882	21-77-91	Aug. 1882
" blue	"	"	27-01-07	"

77th Conv.
 56
 147
 56
 147

The above Map of Township N. 41 North of Range N. 48 East of Mount Diablo Meridian is strictly conformable to the field notes of the survey thereof on file in this Office, which have been examined and approved.
 Surveyor General's Office,
 Reno, Nevada.
 W. S. Davis
 Sur. Gen. Nevada
 Old work approved June 24th 1873.
 New " " Oct. 14th 1882