

TOWNSHIP N^o 41 NORTH RANGE N^o 47 EAST

MOUNT DIABLO MERIDIAN

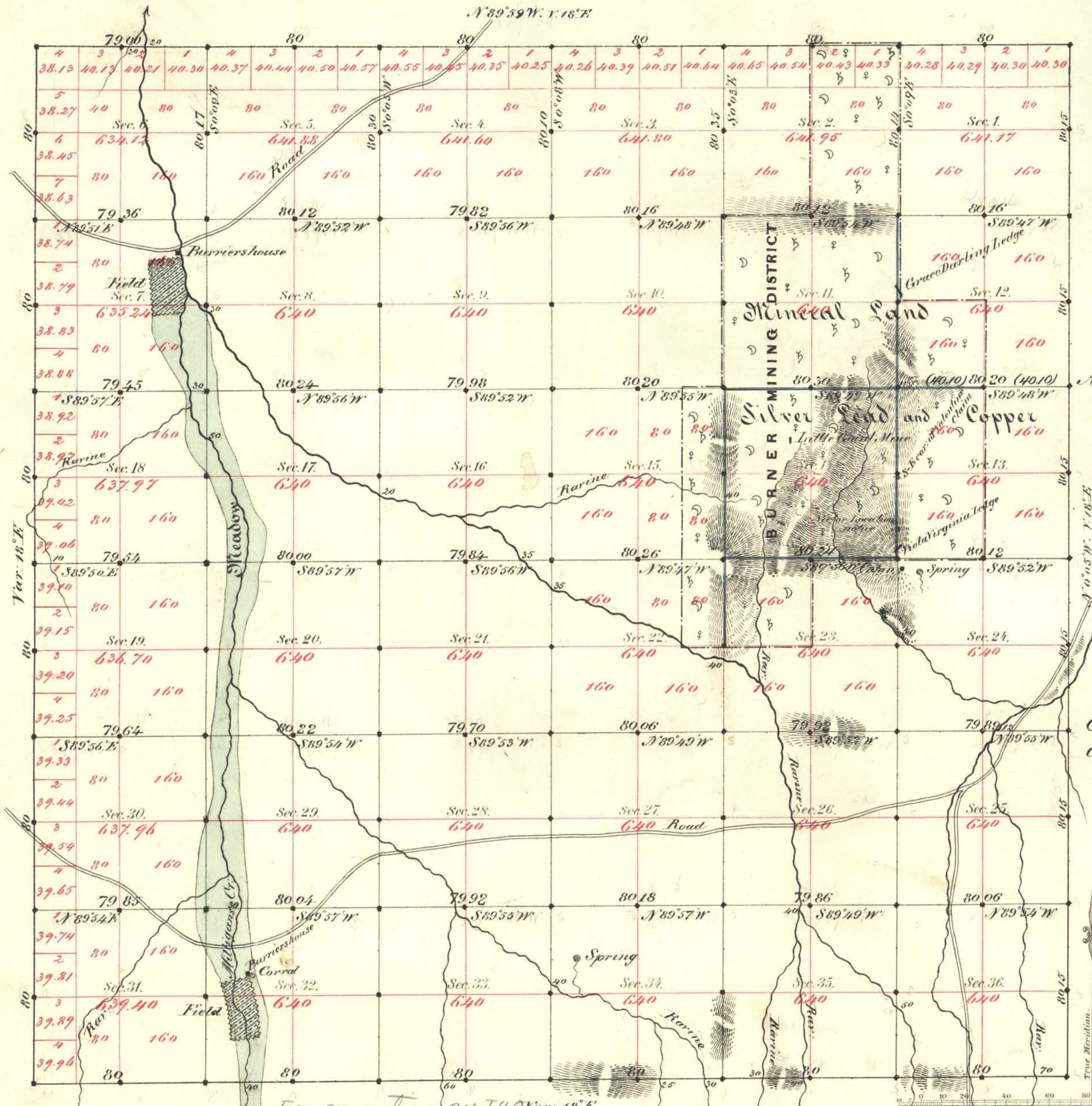

Aggregate Area of Public Land Surveyed 20549.03 Acres
 " of Mineral " 2480.76 "
 Aggregate 23029.79 Ac.

Commenced Septbr: 3rd 1882
 Completed " 8th "

Subdivision lines run with a variation of 18 East

For connections see T 40 Var: 18° E

Survey Designated	By Whom Surveyed	Date of Contract	Amount of Survey	When Surveyed
Township lines	Belle Bell	July 15 th 1882	23-79-75	1882
Section " bk	"	"	53-79-87	Sept. "
" blue	"	"	6-00-64	"

7th Cor. 147

The above Map of Township N^o 41 North of Range N^o 47 East of Mt Diablo Meridian is strictly conformable to the field notes of the survey thereof on file in this Office, which have been examined and approved.

Surveyor General's Office }
 Reno Nevada }
 October 14th 1882 }
 C. S. Davis }
 Sur. Gen. Nevada }

T 41 N, R 47 E.
 VD