

TOWNSHIP N<sup>o</sup> 41 NORTH RANGE N<sup>o</sup> 44 EAST MOUNT DIABLO MERIDIAN

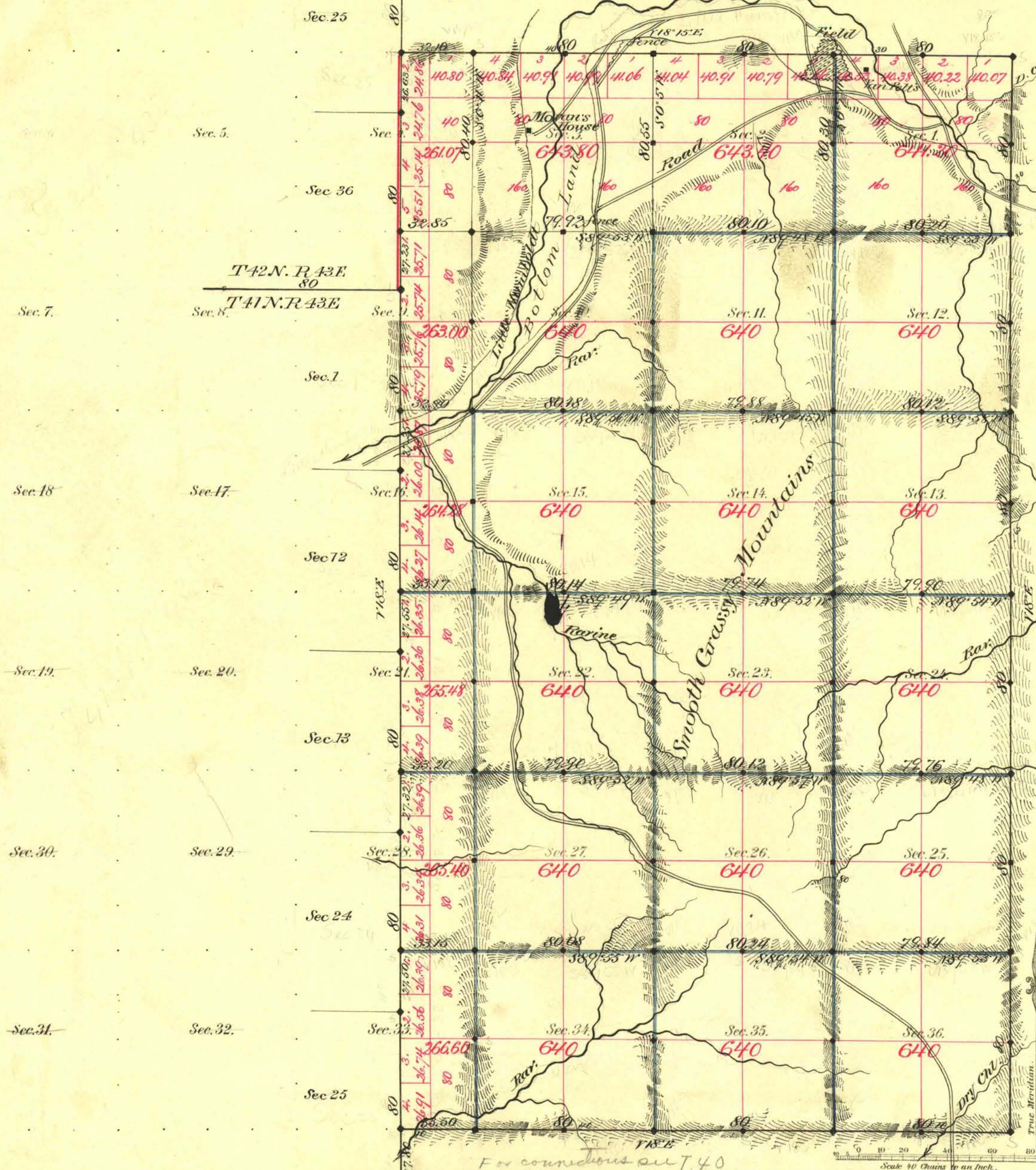

Aggregate Area of Public Land Surveyed 13,114.23 Ac.

Commenced Sept 5<sup>th</sup> 1882  
Completed " 7<sup>th</sup>

Subdivisions run with a Variation of 15° East

Survey Designated	By Whom Surveyed	Date of Contract	Amount of Survey	When Surveyed
W. Day, black	Whinnery, Hansford & Bell	July 10 <sup>th</sup> 1873	24 02 47	1873
" " red	Richard & Morrison	July 21 <sup>st</sup> 1882	1 25 63	1882
N. J. & C. Day	Bell & Bell	" 15 <sup>th</sup> 1882	12 65 60	"
Judsons, black	" "	" "	4 66 62	Sept. "
" blue	" "	" "	30 20 02	" "
Commodore W. Day	" "	" "	1 55 85	" "

The above Map of Township N<sup>o</sup> 41 North of Range N<sup>o</sup> 44 East Mount Diablo Meridian is strictly conformable to the field notes of the survey thereof on file in this Office, which have been examined and approved.

Surveyor General's Office,  
Paso Arada  
October 14<sup>th</sup> 1882

*E. S. Davis*  
Sur. Gen. Tex.

T 41 N, R 44 E VD

A. L. Bauer & Co. Lith. S. F.