

Township N°41 North Range N°35 East. Mount Diablo Meridian.

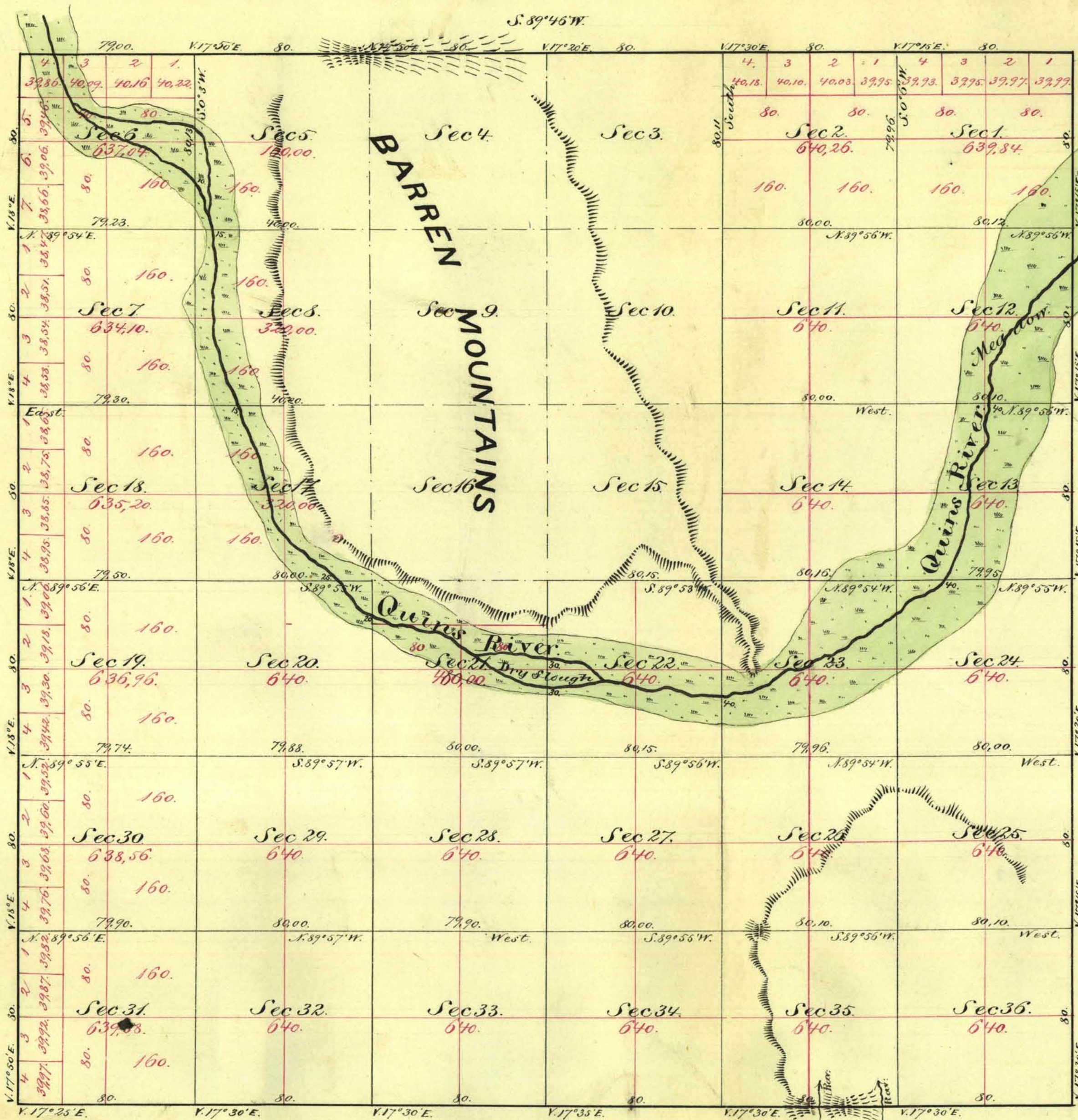

Aggregate Area of Public Land (Surveyed) 17,901.54 Acres.  
 Estimated — Barren Mountain (unsurveyed) 5,120.00 —  
 Aggregate 23,021.54 Acres.

Commenced September 27<sup>th</sup> 1868.  
 Completed October 1<sup>st</sup> 1868.

Subdivision lines not otherwise noted run with a variation of 17° 30' East.

Surveys Designated.	By whom surveyed.	Date of Contract.	Amount of Survey in lbs. & Cts.	When surveyed.	No. Cont.
East & South Boundary of Township	A. Palmer.	May 26 <sup>th</sup> 1868.	12-00-00.	1868.	15
West of Township lines.	—	August 7 <sup>th</sup> 1868.	11-79-00.	—	17
Subdivision lines.	—	—	47-78-44.	Sept 6 <sup>th</sup> 1868.	—

The above Map of Township N°41 North, Range N°35 East Mount Diablo Meridian is strictly conformable to the field notes of the Surveys thereof on file in this Office, which have been examined and approved.  
 U.S. Surveyor General's Office  
 Virginia City Nevada  
 January 15<sup>th</sup> 1869

*A. R. Safford*  
 U.S. Surveyor General Nevada.