

Township N^o 4 North Range N^o 32 East Mount Diablo Meridian

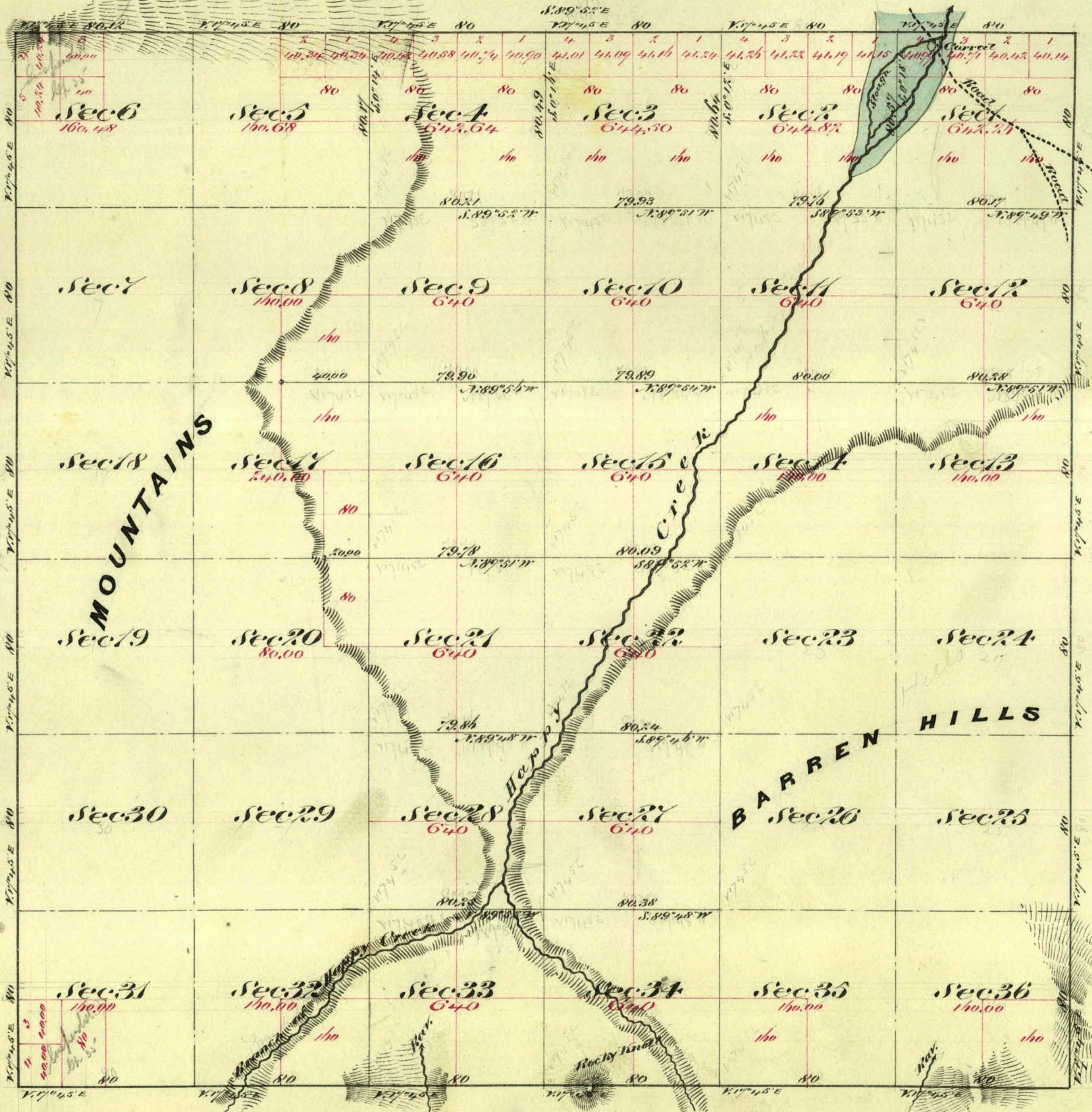

Aggregate Area of Public Land (Surveyed) 12,015.38 Acres
 Estimated " " Mountains (unsurveyed) 11,042.75 "
 Aggregate 23,058.10 "

Commenced September 18th 1873
 Completed " 22nd "

Subdivision lines and otherwise noted run with a variation of 1/4 of 1st

Surveys Designated	By Whom Surveyed	Date of Contract	Am ^t of Survey Acres	When Surveyed	7 th Con.
South Boundary	W. J. Hatch & J. H. Eaton	April 1 st 1873	4 00 00	1873	56
Rest of Township lines	W. M. Skinner & J. M. Garrison & C. S. Wells	July 10 th 1873	18 00 12	"	58
Subdivision lines	" " " " " "	" " "	34 42 10	September 1873	1

This map of Township N^o 4 North Range N^o 32 East Mount Diablo Meridian is strictly conformable to the field notes of the surveys thereof on file in this office which have been examined and approved
 Chief Surveyor General's Office
 Virginia City, Nevada
 November 6th 1873

E. S. Davis
 U. S. Surveyor General Tex.

T 41 N. R 32 E

17