

Township N^o 41 North

Range N^o 27 East

Mount Diablo Meridian

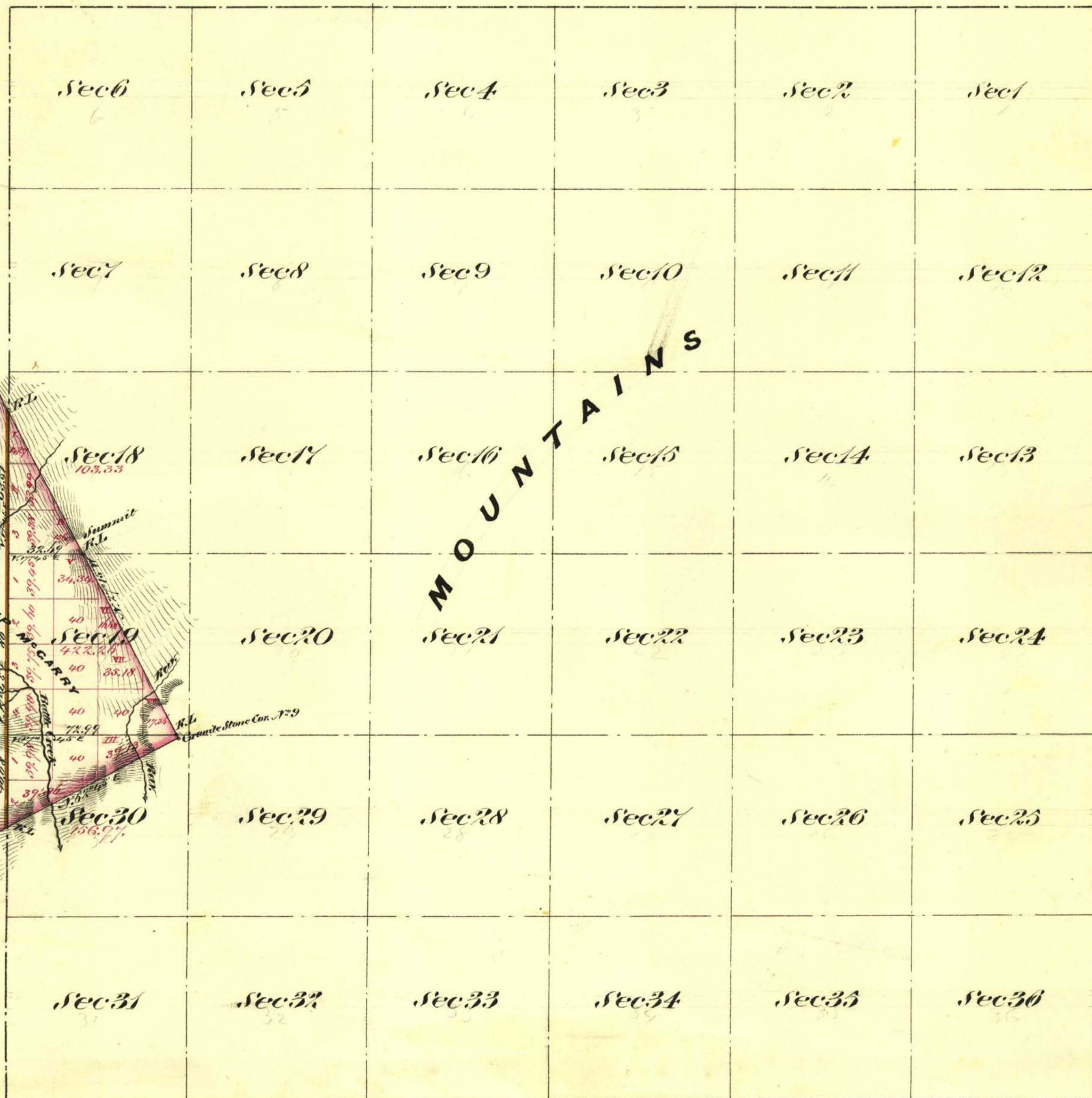

Aggregate Area of Land Surveyed within Camp Mc Garry	182.56 Acres
Estimated " " Ramon Mountains unsurveyed	22,342.16 "
Aggregate	23,024.72 "

Note
The exterior and subdivision lines as surveyed by J. W. Garside under contract of July 9th 1873 are within the limits of Camp Mc Garry and charge to Special Appropriation

Commenced September 11th 1873
Completed " " "

Surveys Designated	By Whom Surveyed	Date of Contract	Am ^t of Survey Ab ^t ch ^s c ^t s	When Surveyed
West Boundary	J. W. Garside	July 9 th 1873	2 23 59	1873
Subdivision lines	" " "	" " "	1 25 48	Sept 1873

0606

The above Map of Township N^o 41 North Range N^o 27 East Mount Diablo Meridian is strictly conformable to the field notes of the Surveyors thereof on file in this Office which have been examined and approved
U.S. Surveyor General's Office
Virginia City Nevada
October 31st 1873

E. S. Davis
U.S. Surveyor General Nev

T41N, R27E.

VD