

Township No. 40 North Range No. 45 East N.D.M.

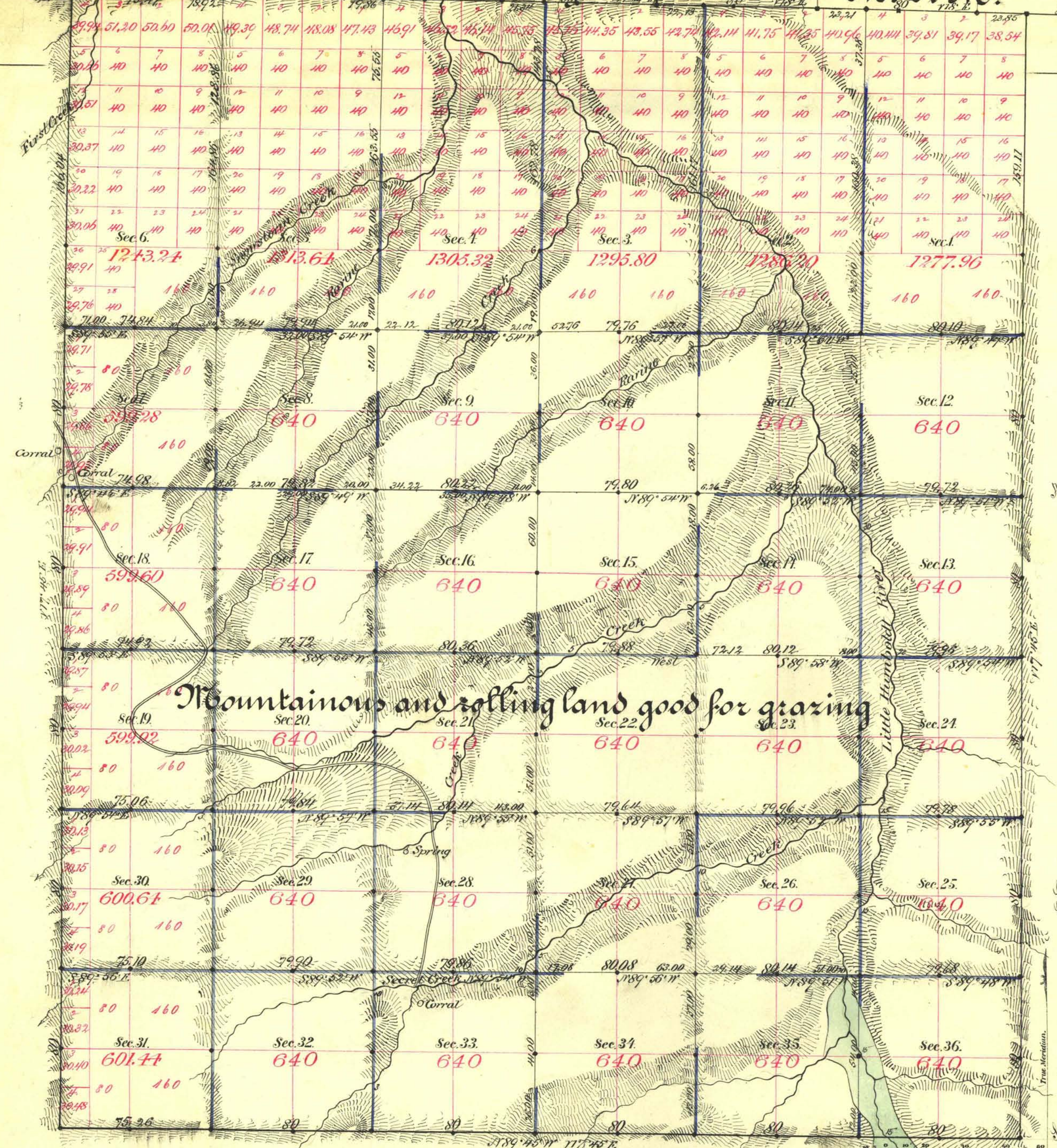

Aggregate Area of Public Land surveyed 26,723.04 Acres

Mountainous and rolling land good for grazing

Commenced Oct. 9th 1855
Completed " 18th "

Subdivisions run with a Var. of 14' 40" East

Surveys Designated.	By Whom Surveyed.	Date of contract.	Amount of Surveys.	When Surveyed.
N. Day	Bell & Bell	July 15th 1852	25 - 05 - 37	1852
J. D. & W. Day	S. H. Stewart	Nov. 10th 1851	20 - 00 - 41	1851
Subdiv. Black	McWilliam & Bridges	" " "	20 - 05 - 63	Subdiv. 1855
" Blue	" " "	" " "	44 - 60 - 95	" "
Contingency	" " "	" " "	1 - 25 - 46	" "

790 Cor.
147
173
174

The above Map of Township No. 40 North of Range No. 45 East Mount Diablo Meridian is strictly conformable to the field notes of the survey thereof on file in this Office, which have been examined and approved.

Surveyor General's Office, Reno, *66* *Conning*
March 31st 1855 U.S. Surv. Gen'l of Nevada.