

Township N^o 40 North

Range N^o 30 East

Mount Diablo Meridian

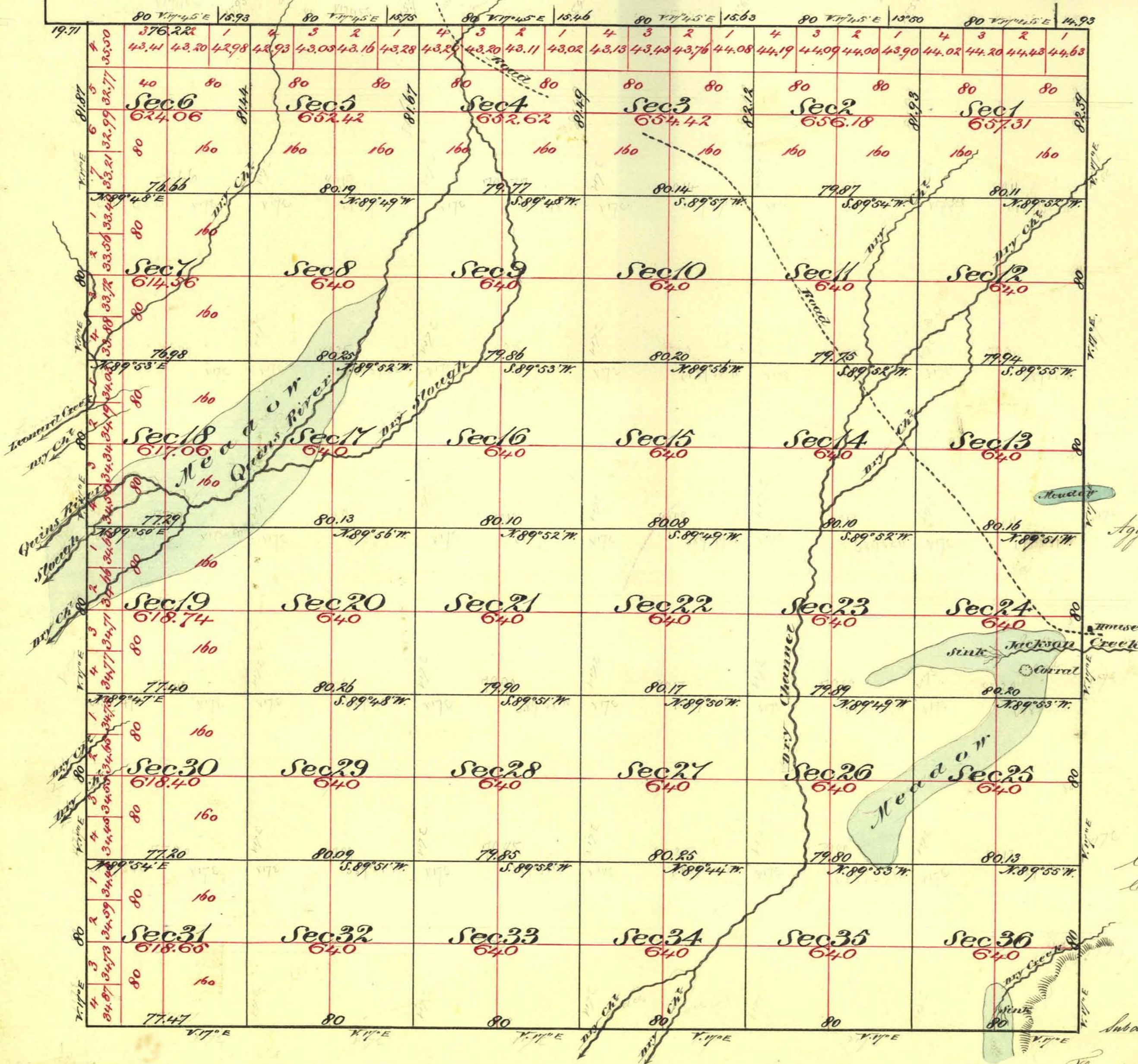

Aggregate Area of Public Land 22,984.42 Acres

Commenced Nov 19th 1874
Completed " 25th 1874

Subdivision lines not otherwise noted run with a Variation of 17' East

Surveys Designated	By whom Surveyed	Date of Contract	Am't of lan. Acs. Chs. Sts.	When Surveyed
North Boundary of Tp	Dr. Sarside Mr. Kimmerly & Co.	July 10 th 1873	6 00 00	1873
Rest of Township's lines	E. W. Sarside	August 13 th 1874	18 01 73	1874
Subdivision lines	" " "	" " "	59 75 37	Nov 1874
Convergency "	" " "	" " "	78 27	" "

79 Cor.
58
65
"

The above Map of Township N^o 40 North Range N^o 30 East Mount Diablo Meridian is strictly conformable to the field notes of the surveys thereof on file in the Office, which have been examined and approved
U. S. Surveyor General's Office
Virginia City Nevada
December 23rd 1874

0771

T40N, R30E.

E. S. Davis
U. S. Surveyor General Nevada
V.P.