

Township N^o 40 North

Range N^o 26 East

Mount Diablo Meridian

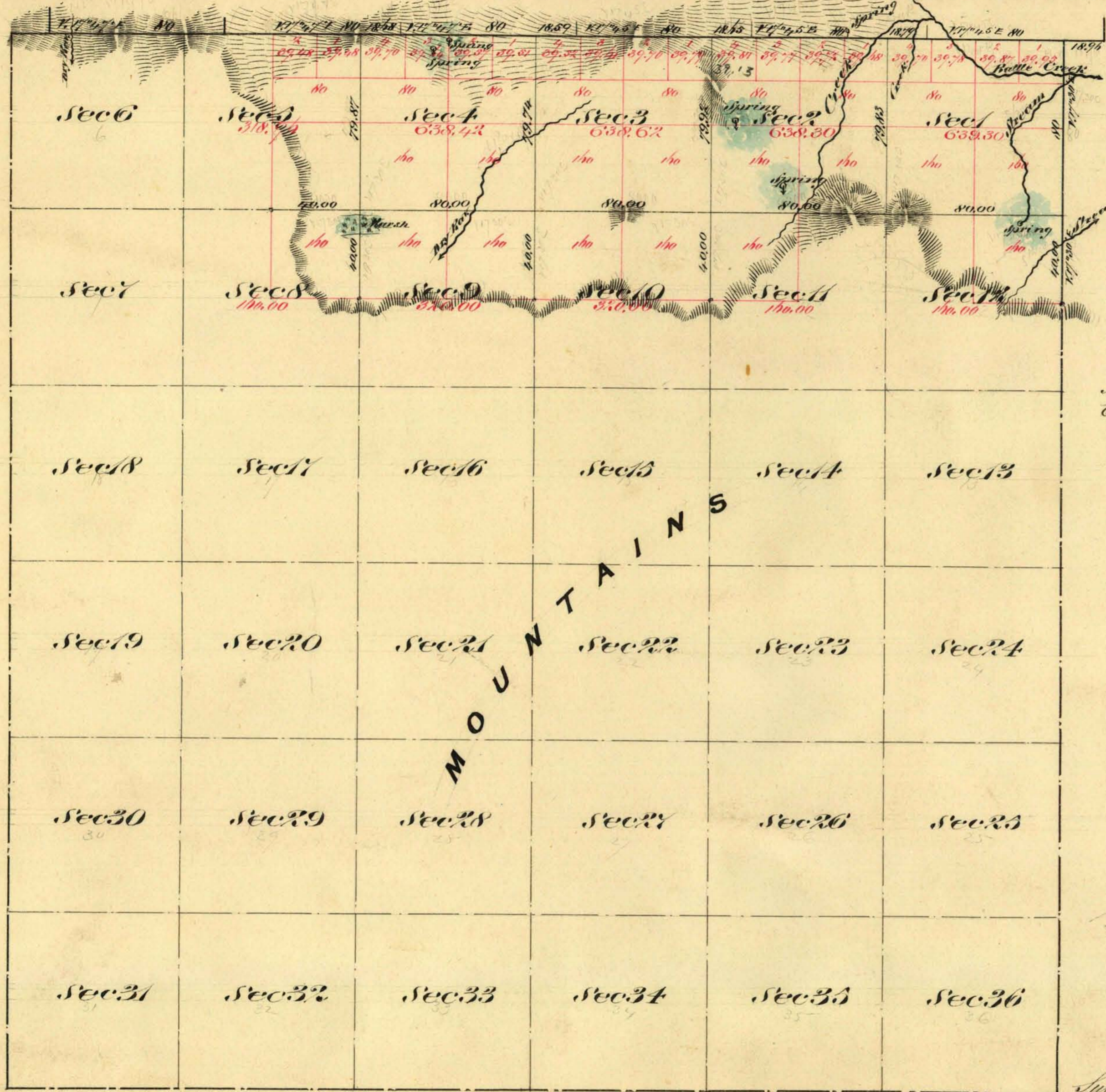

Aggregate Area of Public Land Surveyed 3,992.40 Acres
 Estimated " " Mountains (unsurveyed) 18,918.75 "
Aggregate 22,912.35 "

Commenced October 8th 1873
 Completed " " "

Subdivision lines not otherwise noted run with a variation of 1/2" to 6"
 The above Map of Township N^o 40 North Range N^o 26 East Mount Diablo Meridian is strictly conformable to the field of the surveys thereof on file in this Office, which have been examined and approved
 W. S. Sawyer General's Office
 Virginia City Nevada
 Dec 27th 1873

Surveys Designated	By Whom Surveyed	Date of Cont	Am ^t of Sur ^s M ^{ch} Ch ^o A ^c s	When Surveyed	7 th Cor.
Township Lines	W. W. Singer J. W. Jarside & C. D. Noble	July 10 th 1873	7 40 00	1873	58
Subdivision Lines	" " " " "	" " "	9 79 36	Oct 1873	"
Emergency "	" " " " "	" " "	74 71	"	"

0561

E. S. Davis
 W. S. Sawyer Gen'l Secy

T40N, R26E. VD