

TOWNSHIP 40 NORTH, RANGE 25 EAST, OF THE MOUNT DIABLO MERIDIAN, NEVADA. DEPENDENT RESURVEY

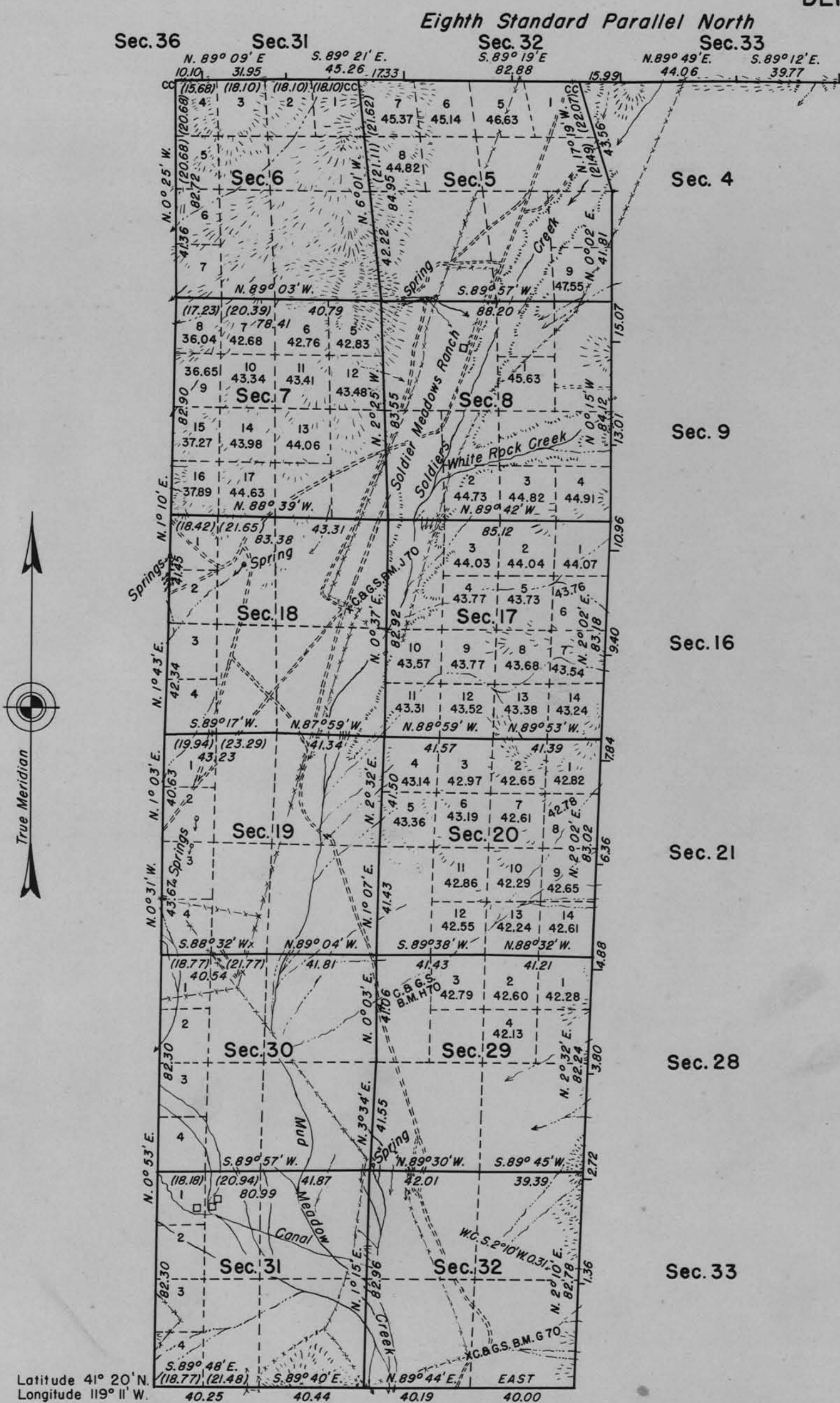

UNSURVEYED

Area Resurveyed, 7740.19 Acres.

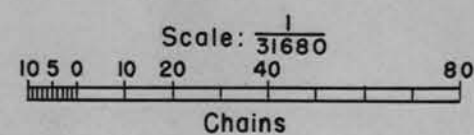

Resurvey executed by Emil Voigt, May 29 to July 23, 1942, and by James W. Hardison May 10 to July 19, 1946, under special instructions dated March 21, 1911, and supplemental special instructions dated September 4, 1941, for Group 314.

This plat represents a retracement and reestablishment of portions of the original township boundary and subdivisional lines designed to restore the corners in their original locations according to the best available evidence. The lottings and areas are as shown on the plat approved April 17, 1873, except as new areas are shown hereon.

UNITED STATES DEPARTMENT OF THE INTERIOR
BUREAU OF LAND MANAGEMENT
Washington, D. C., September 15, 1949

This plat is strictly conformable to the approved field notes, and the survey, having been correctly executed in accordance with the requirements of law and the regulations of this Bureau, is hereby accepted.

For the Director

William F. Richards
Chief, Branch of Surveys