

TOWNSHIP N^o 39 NORTH RANGE N^o 52 EAST

MOUNT DIABLO MERIDIAN

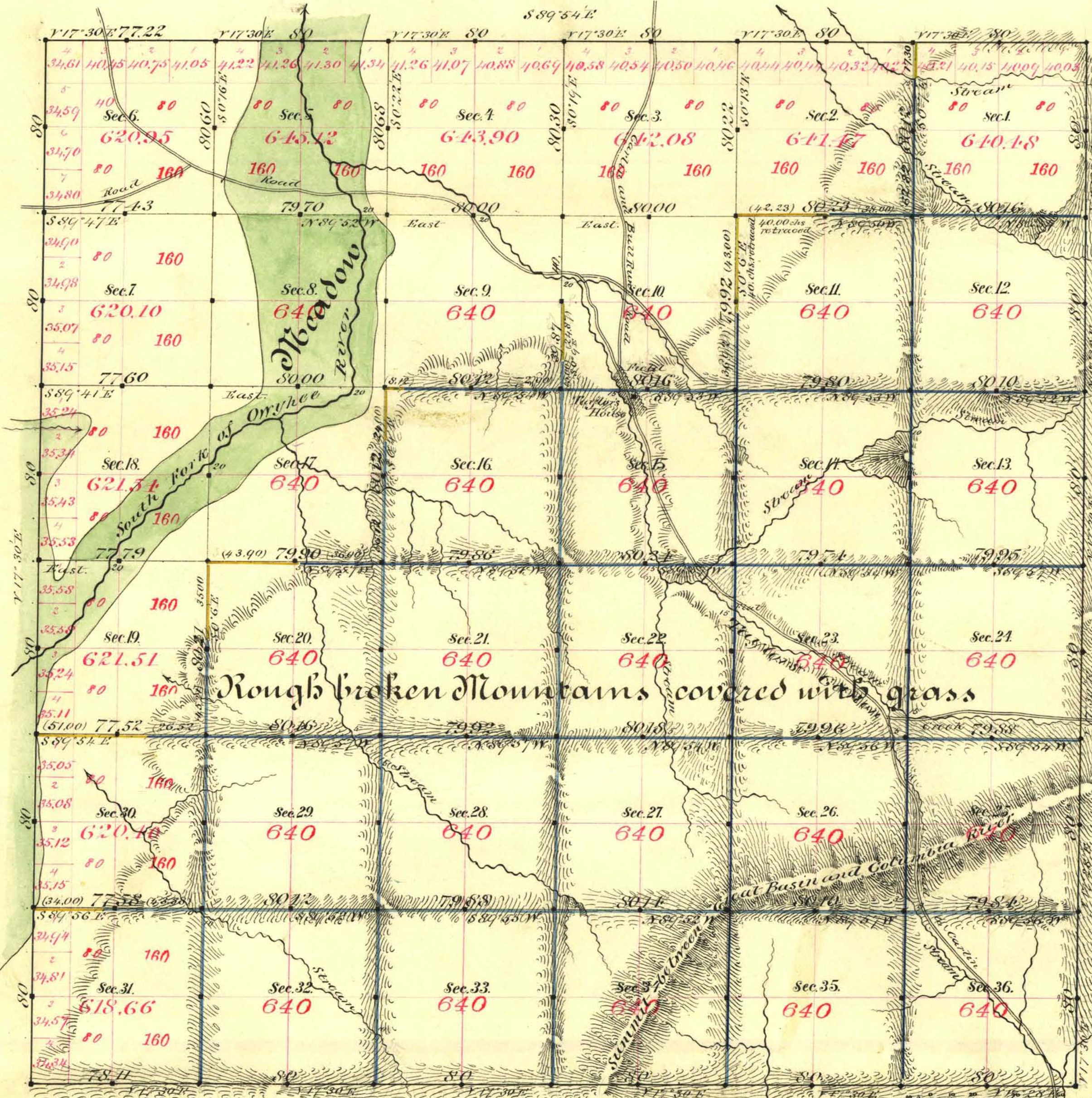

Aggregate area of Public Land surveyed by
Hatch & Eaton Nov 26th 1870 6025.73 acres
" area of Public Land surveyed by
McClellan & Bridges Aug 9th 1884 16910.48 "
Aggregate 22936.21 "

Old work commenced Jan. 20th 1871
" " completed " 23rd "
New " commenced Nov. 13th 1884
" " completed " 18th "

Old work approved by E. S. Davis Feb 25th 1871

Subdivisions run with a Variation of 17' 30" East

Surveys Designated.	By Whom Surveyed.	Date of Contract.	Amount of Surveys.	When Surveyed.	7 th Cont.
Township lines	Hatch & Eaton	Nov. 26 th 1870	23 - 95 - 33	1870	41
Subdivs. black	"	"	15 - 54 - 32	Jan 1871	"
" yellow	McClellan & Bridges	Aug 9 th 1884	4 - 03 - 42	Nov 1884	171
" blue	"	"	41 - 32 - 36	"	"

The above Map of Township No. 39 North of Range No. 52 East, Mount Diablo Meridian is strictly conformable to the field notes of the survey thereof on file in this Office, which have been examined and approved.
Surveyor General's Office, Reno, B. C. Cowing
January 13th 1885 U.S. Sur. Gen^l of Nevada.