

TOWNSHIP N^o 39 NORTH RANGE N^o 51 EAST

MOUNT DIABLO MERIDIAN

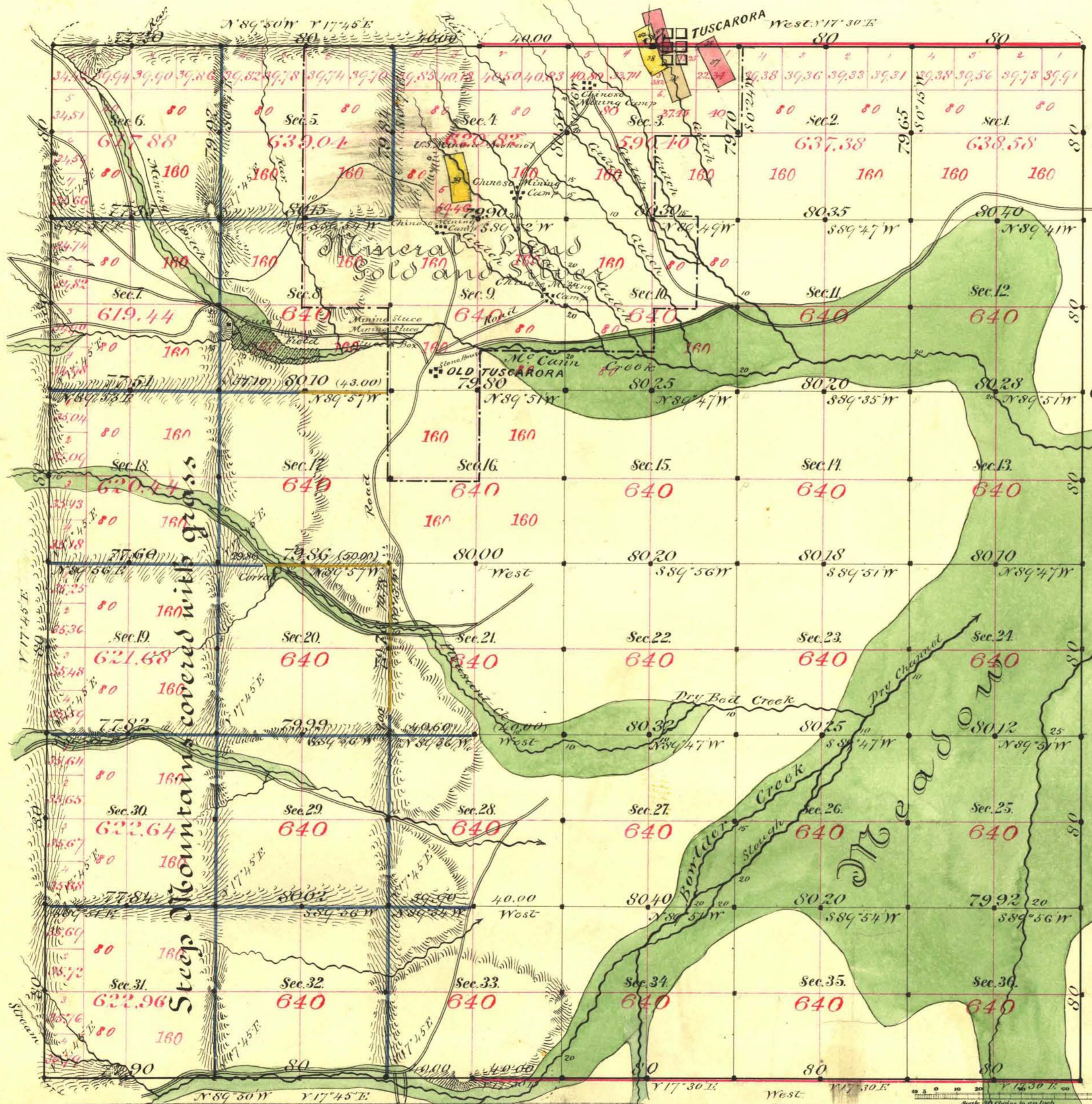

No.	Claim	Lode	Acres	Approval
37239	Young America South	California	30.66	Aug. 21 st 1875
38572	Nevado	Nevado	20.13	Sept. 8 th 1877
39	S. M. & J. W. Beard	Moloc	20.51	Dec. 6 th "
4087	Tuscarora Con.	May be so	15.28	Jan. 18 th 1879
41	E. & F. Con.	Reverue	19.28	Aug. 30 th 1883

Aggregate area of Public Land surveyed by Hatch & Eaton Nov. 26th 1870 12235.96 acres
 " " " " " " " " " " " " " " 1842.80 "
 area of Public Land surveyed by McEllan & Bridges Aug. 9th 1884 8044.64 "
 " " " " " " " " " " " " " " 298.80 "
 Aggregate 22922.20

Old work commenced Jan. 23rd 1871
 " " completed " 22nd "
 New " commenced Oct 31st 1884
 " " completed Nov 3rd "

Old work approved by E. S. Davis Feb 25th 1871

Subdivisions not noted run with a Var. of 12' 30" East

Surveys Designated.	By Whom Surveyed.	Date of Contract.	Amount of Surveys.	When Surveyed.	
N & S. red & E. bay	Hatch & Eaton	Nov. 26 th 1870	73 - 00 - 00	1870	41
Subdivns. black	"	"	39 - 03 - 02	Jan. 1871	170
N & S. blk. & W.	T. K. Stewart	Aug 7 th 1884	70 - 75 - 10	1884	171
Subdivns. yellow & blue	McEllan & Bridges	" 9 th "	2 - 03 - 78	Oct. & Nov. "	"
	"	"	18 - 64 - 50	"	"

The above Map of Township No. 39 North of Range No. 51 East of Mount Diablo Meridian is strictly conformable to the field notes of the survey thereof on file in this Office, which have been examined and approved.

Surveyor General's Office, Reno, L. C. Downing
 June 13th 1885
 U.S. Survey Genl. of Nevada.

For connection see R 50

Steep Mountain covered with grass

Dry Bed Creek