

TOWNSHIP N^o 39 NORTH RANGE N^o 48 EAST

MOUNT DIABLO MERIDIAN

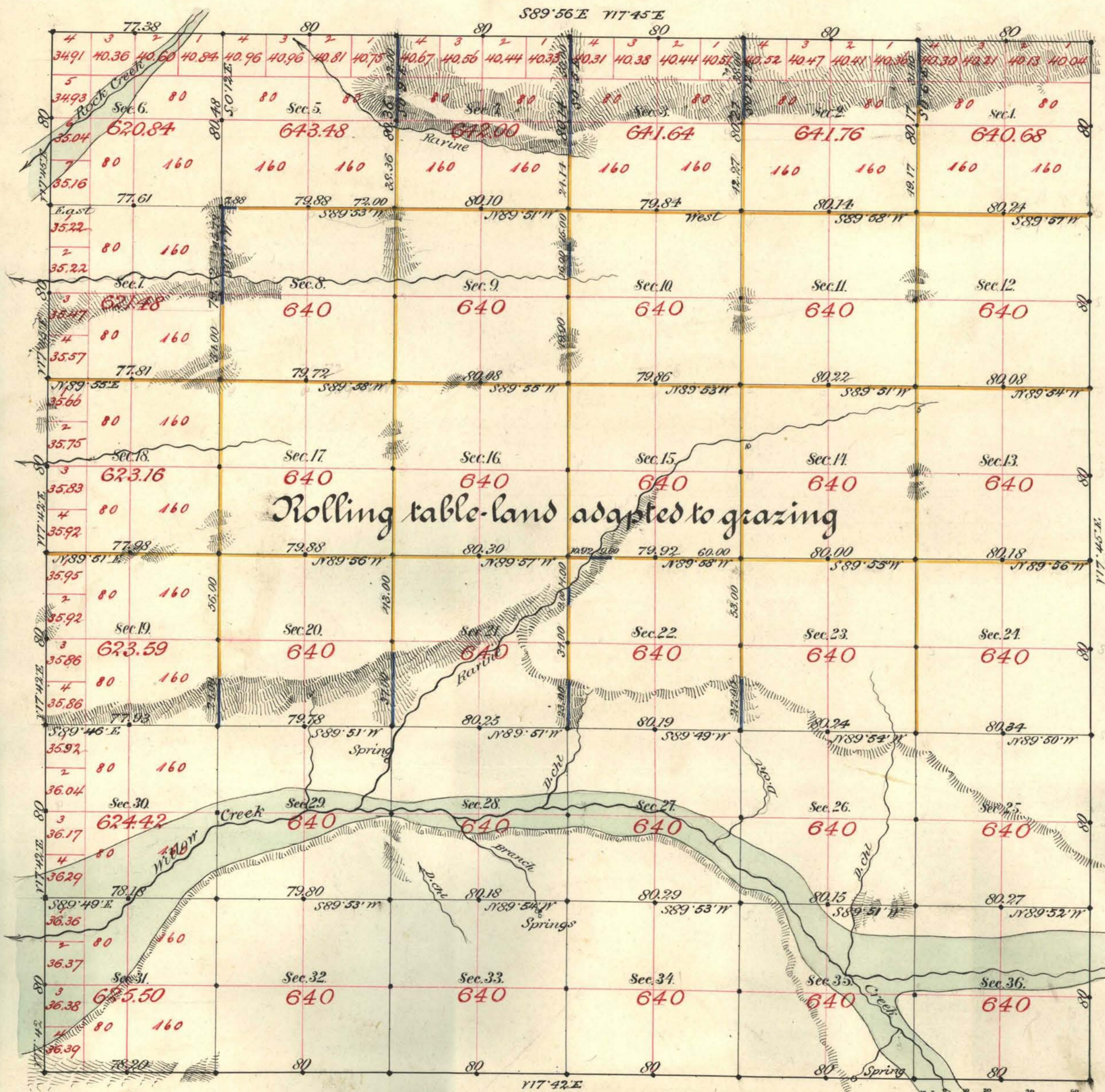

Aggregate Area of Public Land surveyed by
 Hatch, Eaton & Dwyer Nov. 16th 1842 9,054.87 Ac
 " by Mc Clellan & Bridges Nov. 14th 1854 13,893.71 "
 Aggregate 22,948.55 "

Old work commenced Jan. 14th 1843
 " " completed " 15th "
 Nov " commenced " 8th 1845
 " " completed " 12th "

Old work approved by C. S. Davis Oct. 13th 1843

Subdivs run with a Var. of 1st 45 East

Surveys Designated.	By Whom Surveyed.	Date of Contract.	Amount of Surveys.	When Surveyed.
Township lines	Hatch, Eaton & Dwyer	Nov. 16 th 1842	36 - 36 - 36	1842
Subdivs. black	" " "	" " "	23 - 76 - 62	Jan. 1843
" yellow	Mc Clellan & Bridges	" 14 th 1854	31 - 31 - 29	" 1855
" blue	" " "	" " "	4 - 45 - 60	" "

779 Cont.
 The above Map of Township No. 39 North of Range No. 48 East
 Mount Diablo Meridian, is strictly conformable to the field notes of the survey
 thereof on file in this Office, which have been examined and approved.
 Surveyor General's Office, Reno, *W. C. Downing*
 March 31st 1885 U.S. Surv. Genl. of Nevada.