

TOWNSHIP N^o 38 NORTH RANGE N^o 50 EAST

MOUNT DIABLO MERIDIAN

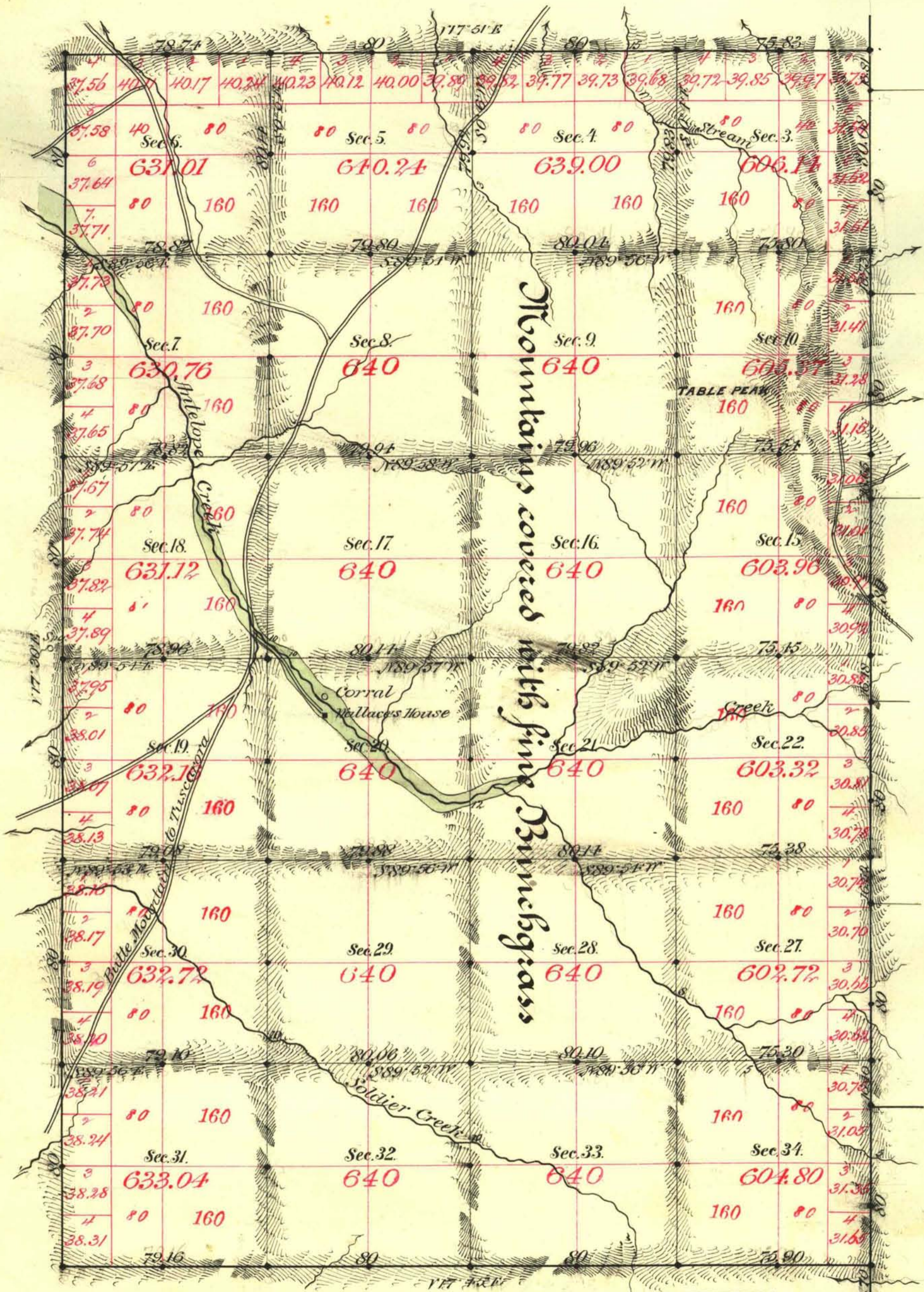

Aggregate area of Public land surveyed 15,096.26 Ac.

Commenced Sept. 19th 1884
Completed " 24th "

Soldiers run with a Cur. of 1^o 45' East.

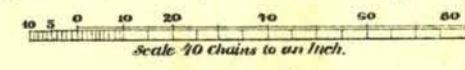

Surveys Designated.	By Whom Surveyed.	Date of Contract.	Amount of Surveys.	When Surveyed.	No. Corrs.
W. P. Dwy.	M. C. Adams & Stewart	March 14 th 1884	46 80 80	1884	169
J. S. P. Dwy.	J. K. Stewart	Aug. 4 th "	19 69 71	"	170
Soldiers	M. C. Adams & Bridges	" 9 th "	37 - 52 - 07	"	171
Commenced on C. P. Dwy.	"	" " "	1 - 02 - 78	"	"

The above Map of Township No. 38 North of Range No. 50 East Mount Diablo Meridian is strictly conformable to the field notes of the survey thereof on file in this Office, which have been examined and approved.
Surveyor General's Office, Reno, B. C. Downing
U.S. Survey Gen'l. of Nevada.
January 13th 1885