

TOWNSHIP N^o 38 NORTH RANGE N^o 45 EAST

MOUNT DIABLO MERIDIAN

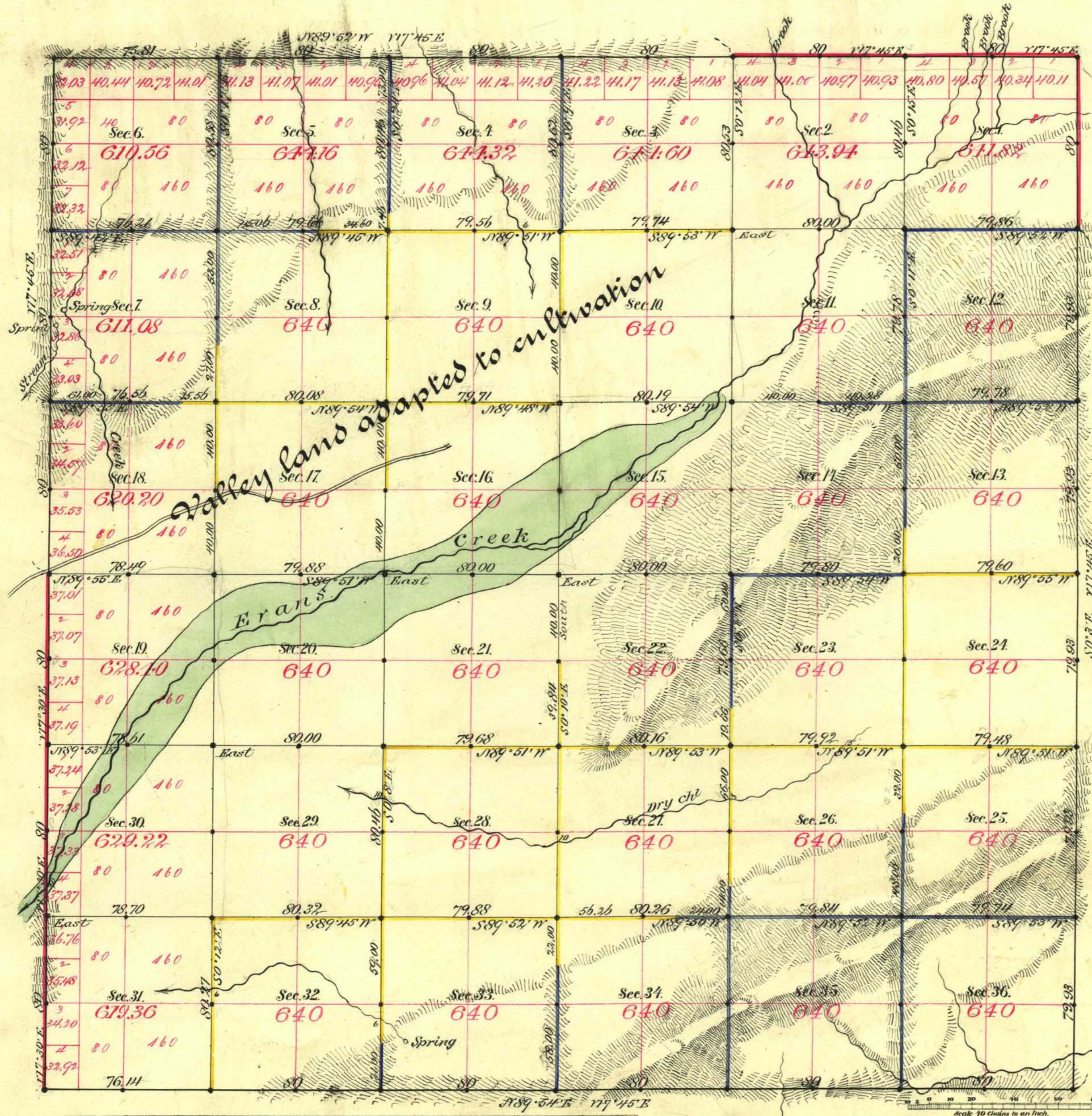

Resur Cont 190

Aggregate Area of Public Land surveyed by
 Hatch, Eaton & Smyles Nov. 16th 1843 5,898.18 Ac.
 " by Mc Clellan & Bridges Nov. 14th 1884 17,039.18 "
 Aggregate 22,937.56 "

Old work commenced January 4th 1843
 " " completed " 10th "
 New " commenced " 22nd 1885
 " " completed " 28th "

Old work approved by C. D. Davis Oct. 13th 1873

Subdons run with a Var. of 14' 45" East.

Surveys Designated.	By Whom Surveyed.	Date of Contract.	Amount of Surveys.	When Surveyed.
N. bdy rd	Hatch & Smyles	Dec. 15 th 1841	29- 86- 88	1842
N. & O. "	Hatch, Eaton & Smyles	Nov. 16 th 1843	3- 00- 00	"
Subdons black	"	"	19- 36- 86	January 1843
East of Sp. lines black	J. K. Stewart	" 10 th 1884	17- 71- 60	1884
Subdons yellow	Mc Clellan & Bridges	" 14 th "	22- 38- 24	1885
" blue	"	"	17- 73- 53	"

79th Con. 49
 54
 173
 174

The above Map of Township No. 38 North of Range No. 45 East Mount Diablo Meridian is strictly conformable to the field notes of the survey thereof on file in this Office, which have been examined and approved.

Surveyor General's Office, Reno, **B. B. Cowing**
 U.S. Surv. Gen'l. of Nevada.
 March 31st 1885