

Township N<sup>o</sup> 38 North

Range N<sup>o</sup> 30 East

Mount Diablo Meridian

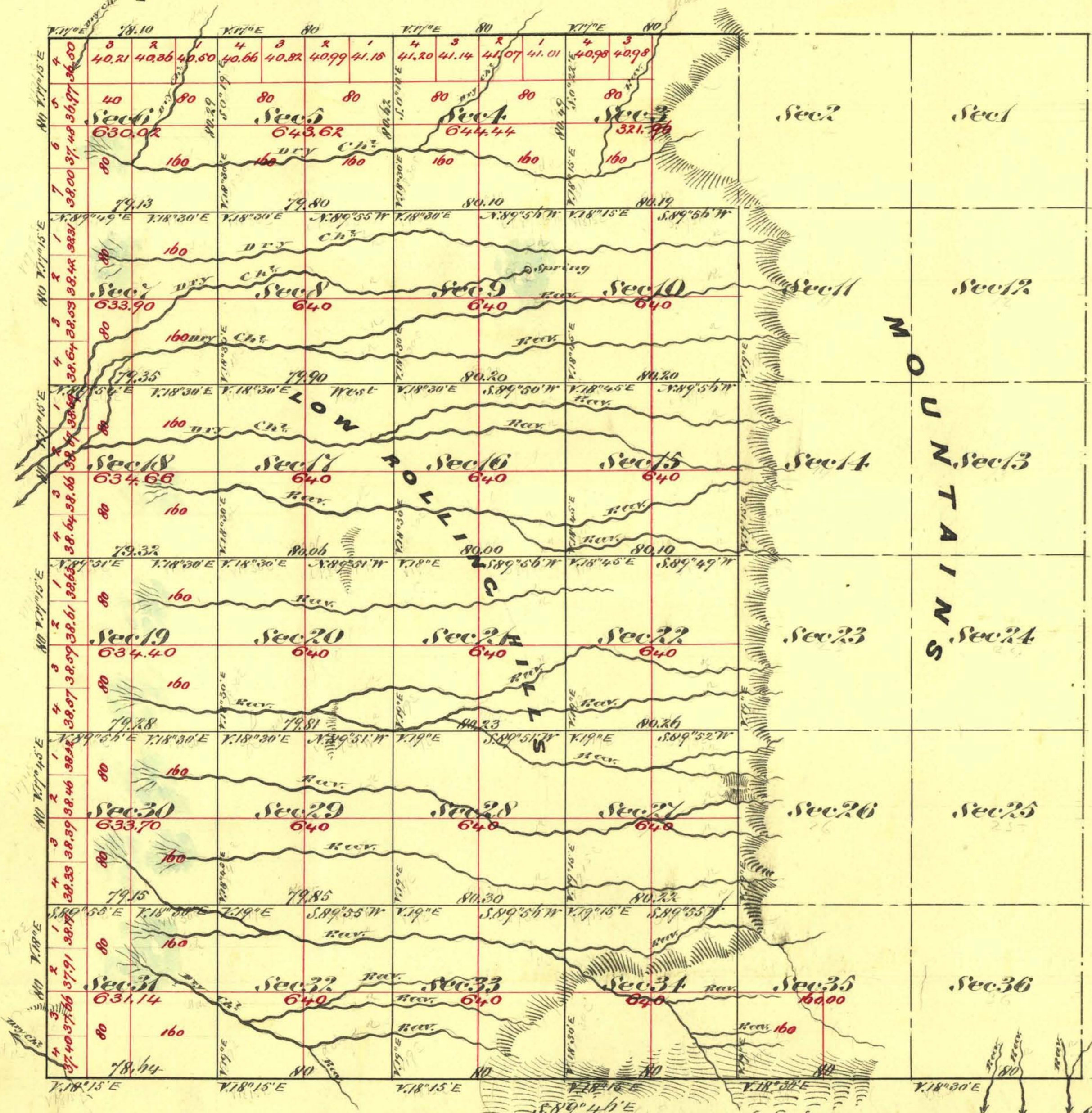

Aggregate Area of Public Land (Surveyed) 15,147.84 Acres  
 Estimated " " Mountains (unsurveyed) 7,884.80 "  
 Aggregate 23,032.64 "

Commenced Oct. 18<sup>th</sup> 1875  
 Completed " 22<sup>nd</sup> 1875

Surveys Designated	By whom Surveyed	Date of Contract	Am <sup>t</sup> of Land Acres	When Surveyed	N <sup>o</sup> Cont
North Boundary of Sp	G. W. Garside	August 12 <sup>th</sup> 1874	3 78 10	1874	65
West of Township Lines	G. W. Garside & C. S. Poble	Sept 29 <sup>th</sup> 1875	11 78 64	1875	71
Subdivision Lines	" " " "	" " "	42 78 85	Oct 1875	"

The above Map of Township N<sup>o</sup> 38 North Range N<sup>o</sup> 30 East Mount Diablo Meridian is strictly conformable to the field notes of the surveys thereof on file in this Office, which have been examined and approved  
 U. S. Surveyor General's Office  
 Virginia City Nevada  
 January 3<sup>rd</sup> 1876

0769

T38N, R30E. VD

C. S. Davis  
 U. S. Surveyor Gen<sup>l</sup> Nevada