

ORIGINAL

TOWNSHIP 37 NORTH, RANGE 52 EAST, OF THE MOUNT DIABLO MERIDIAN, NEVADA  
DEPENDENT RESURVEY

OFFICIALLY FILED  
NEVADA STATE OFFICE  
MAY 20, 1983

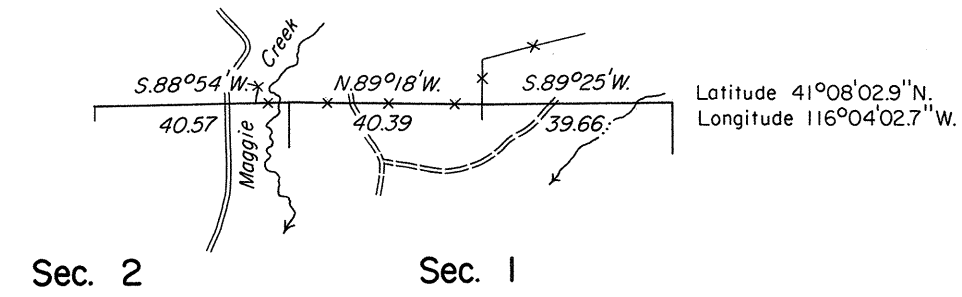

A history of surveys is contained in the field notes.

This plat represents a dependent resurvey of a portion of the north boundary of T. 37 N., R. 52 E., designed to restore the corners in their true original locations according to the best available evidence.

Survey executed by Joseph A. Bastian, Cadastral Surveyor, beginning December 1, 1980 and completed December 3, 1980, pursuant to Special Instructions dated May 7, 1979 and Supplemental Special Instructions dated August 11, 1980, for Group No. 574, Nevada.

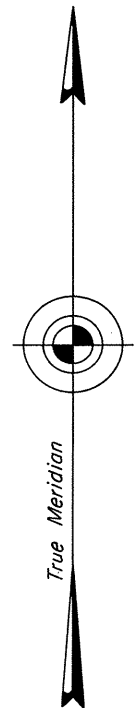

Mean Magnetic Declination  
17½° E.

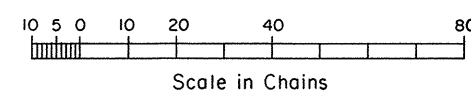

UNITED STATES DEPARTMENT OF THE INTERIOR  
BUREAU OF LAND MANAGEMENT

Reno, Nevada

May 5, 1983

This plat is strictly conformable to the approved field notes, and the survey, having been correctly executed in accordance with the requirements of law and the regulations of this Bureau, is hereby accepted.

For the Director

*Lacel E. Bland*

Acting Deputy State Director, Operations