

TOWNSHIP N^o 37 NORTH RANGE N^o 21 EAST MOUNT DIABLO MERIDIAN

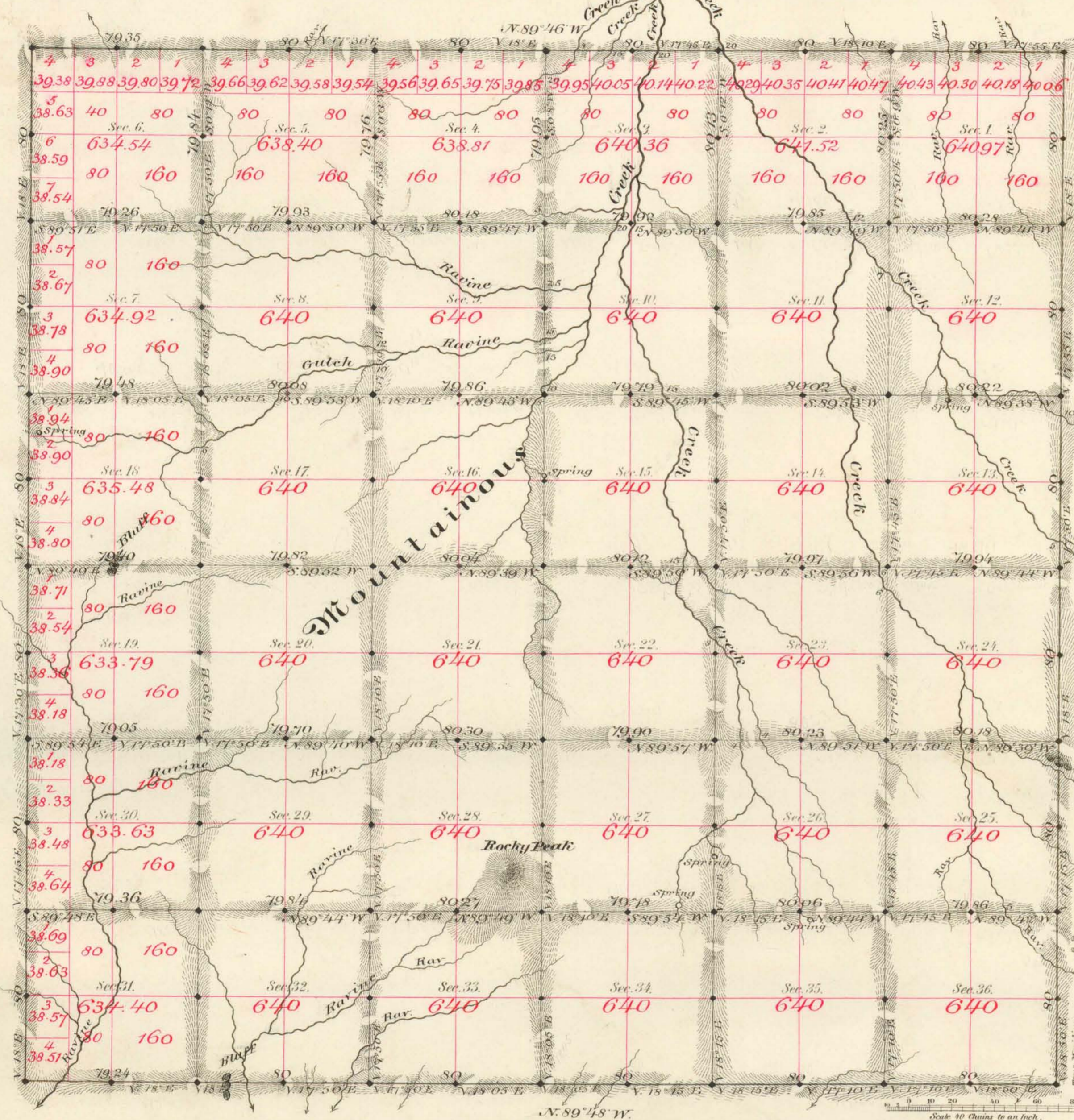

Aggregate Area of Public Land surveyed 23,006.82 As

Commenced November 28th 1882
Completed December 4th "

Subdivisions not noted run with a Variation of 18° East

Surveys Designated	By Whom Surveyed	Date of Contract	Amount of Surveys	When Surveyed
W & S. Bdy	F. G. Ward	June 20 th 1882	21 - 39 - 51	1882
N & E	W. D. Minckler		11 - 79 - 35	"
Section lines			59 - 76 - 62	Nov. & Dec. "

No. Cont. The above Map of Township N^o 37 North of Range N^o 21 East of M.D. is strictly conformable to the field notes of the survey thereof on file in this Office, which have been examined and approved.
Surveyor General's Office, Reno, Nevada
January 8th 1883
C. J. Davis, Sur. Gen., Nevada

T 37N, R 21E
VD