

Township N° 37 North Range N° 18 East Mount Diablo Meridian

70.30 Est. 59 M.P.
 70.14 Est. 61 M.P.
 69.72 Est. 63 M.P.
 CALIFORNIA
 NEVADA
 State Line
 BROKEN HILLS

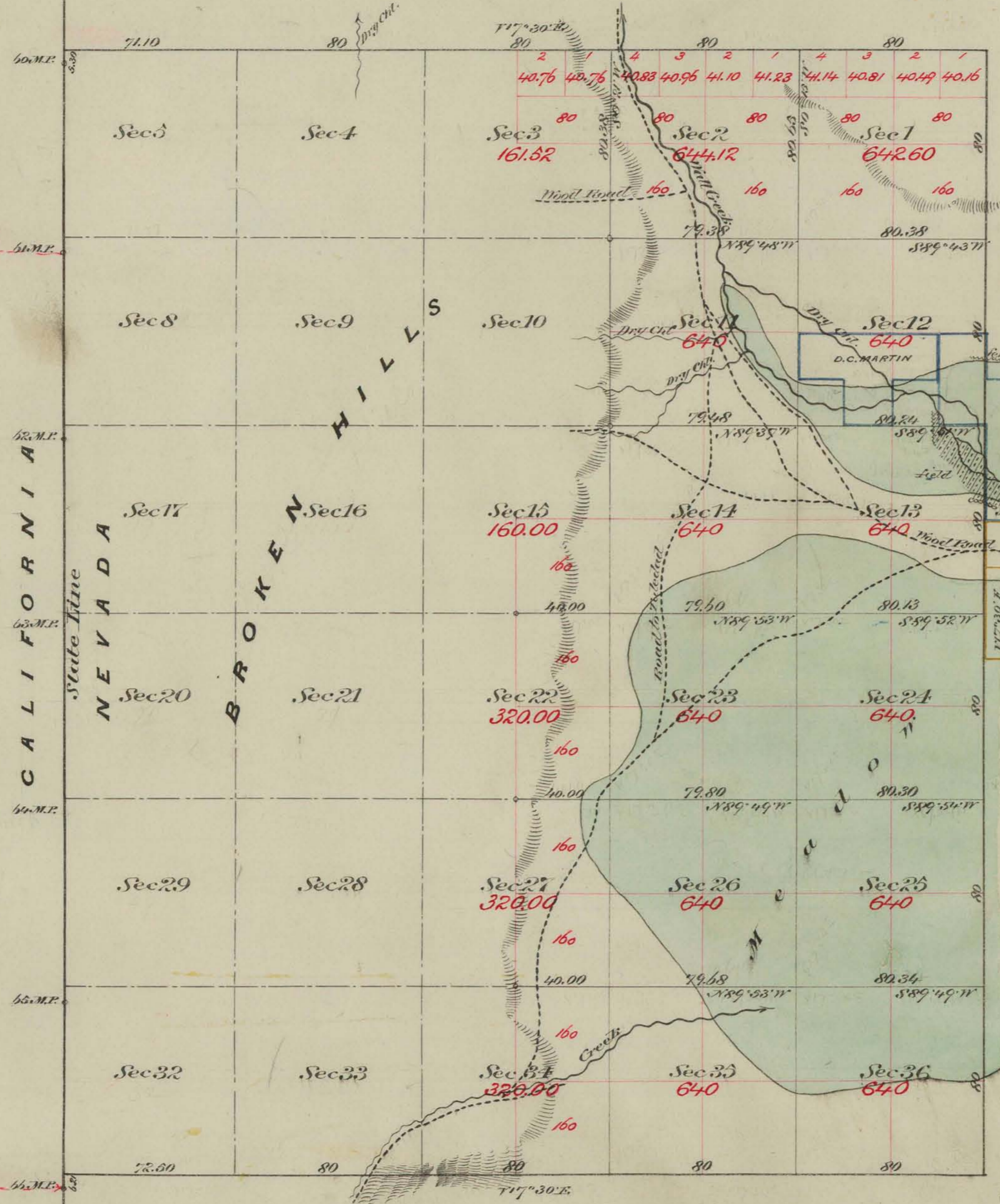

Aggregate Area of Public Land Damaged
 Estimated " Hills Unsurveyed
 Aggregate

8,968.24 Ac.
9,847.41 "
<u>18,815.65 "</u>

Blue lines show Desert Land Location
 Yellow " " Ranches

Commenced January 20th 1880
 Completed " 21st "

Said division line not otherwise noted runs variation of 17° 30' East

Survey designated	By whom Surveyed	Date of Control	Unit of Survey	When Surveyed	7 th Cont.
N. boundary State Line	A. M. Von Schmidt	July 20 th 1872		1872	
Township line	H. M. Gauside	Dec 14 th 1879	15-63-60	1880	93
Said division	"	"	23-40-36	January "	"

The above plat of Township N° 37 North of Range N° 18 East Mount Diablo Meridian is strictly conformable to the field notes of the surveys thereof on file in this office which have been examined and approved
 U. S. Surv. Genl. Office
 Virginia City Nev. 11
 March 6th 1880

E. J. Davis
 U. S. Surv. Genl. Serv.

0066

T 37 N. R. 18 E.

VD