

Township N^o 36 North

Range N^o 51 East

Mount Diablo Meridian

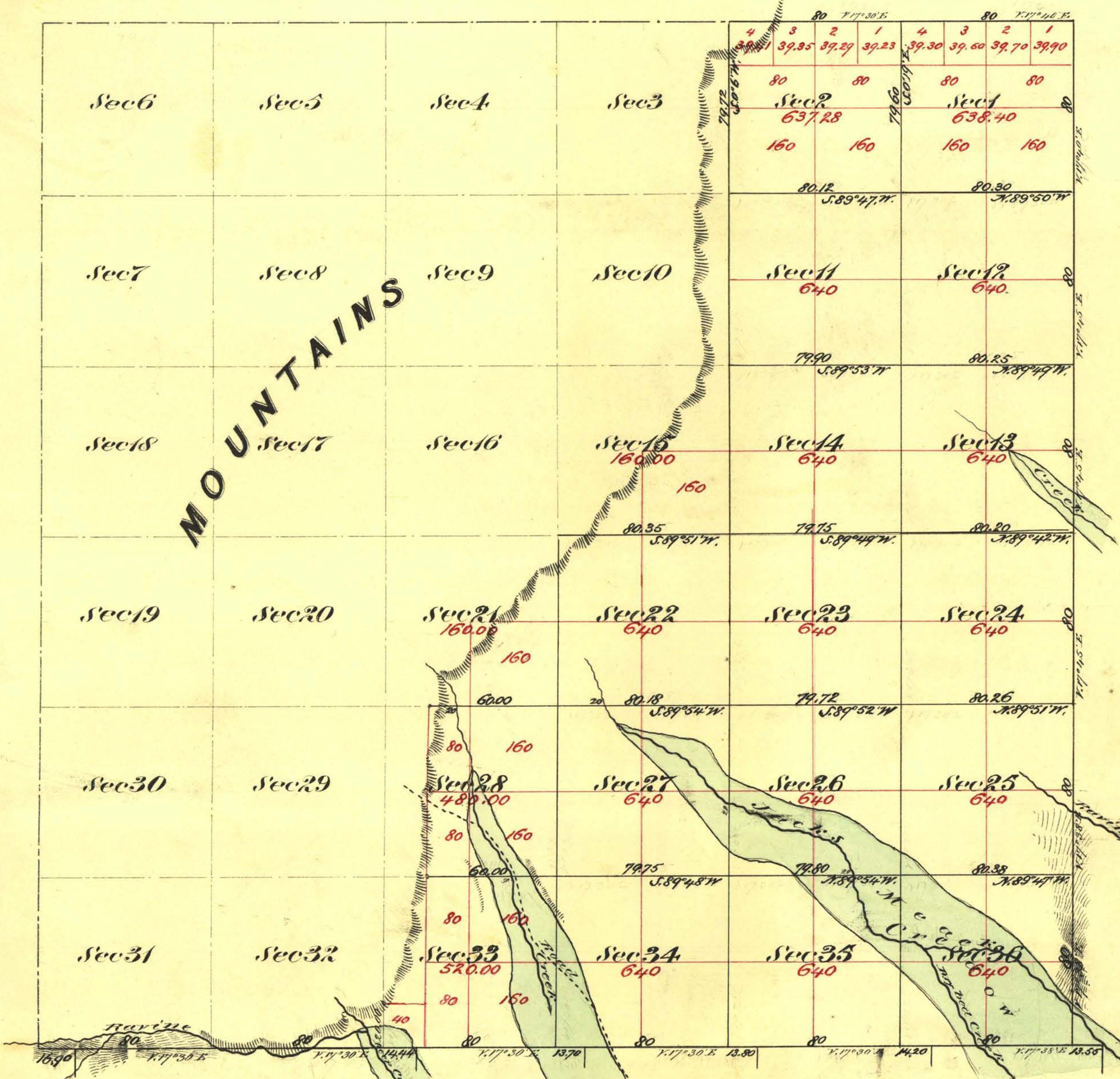

Aggregate Area of Public Land (Surveyed) 10,915.68 Acres
 Estimated " " Mountains (unsurveyed) 12,096.96 "
 Aggregate 23,012.64 "

Commenced March 11th 1871
 Completed " 15th 1871

Subdivision Lines not otherwise noted run with a Variation of 17' 30" E

The above Maps of Township N^o 36 North Range N^o 51 East Mount Diablo Meridian is strictly conformable to the field notes of the surveys thereof on file in this Office, which have been examined and approved
 U. S. Surveyor General's Office
 Virginia City Nevada
 May 10th 1871

Surveys Designated	By Whom Surveyed	Date of Contract	Amount of Surveys In Ac. Sq. Rds.	When Surveyed
Township Lines	A. J. Hatch & H. Eaton	February 6 th 1871	14. 00 00	1871
Subdivision Lines	" " " "	" " "	29. 60. 28.	March 1871

1987

E. S. Davis
 U. S. Surveyor General Nevada

T 36 N. R 51 E. V.P.