

Township N<sup>o</sup> 36 North

Range N<sup>o</sup> 50 East

M. D. M

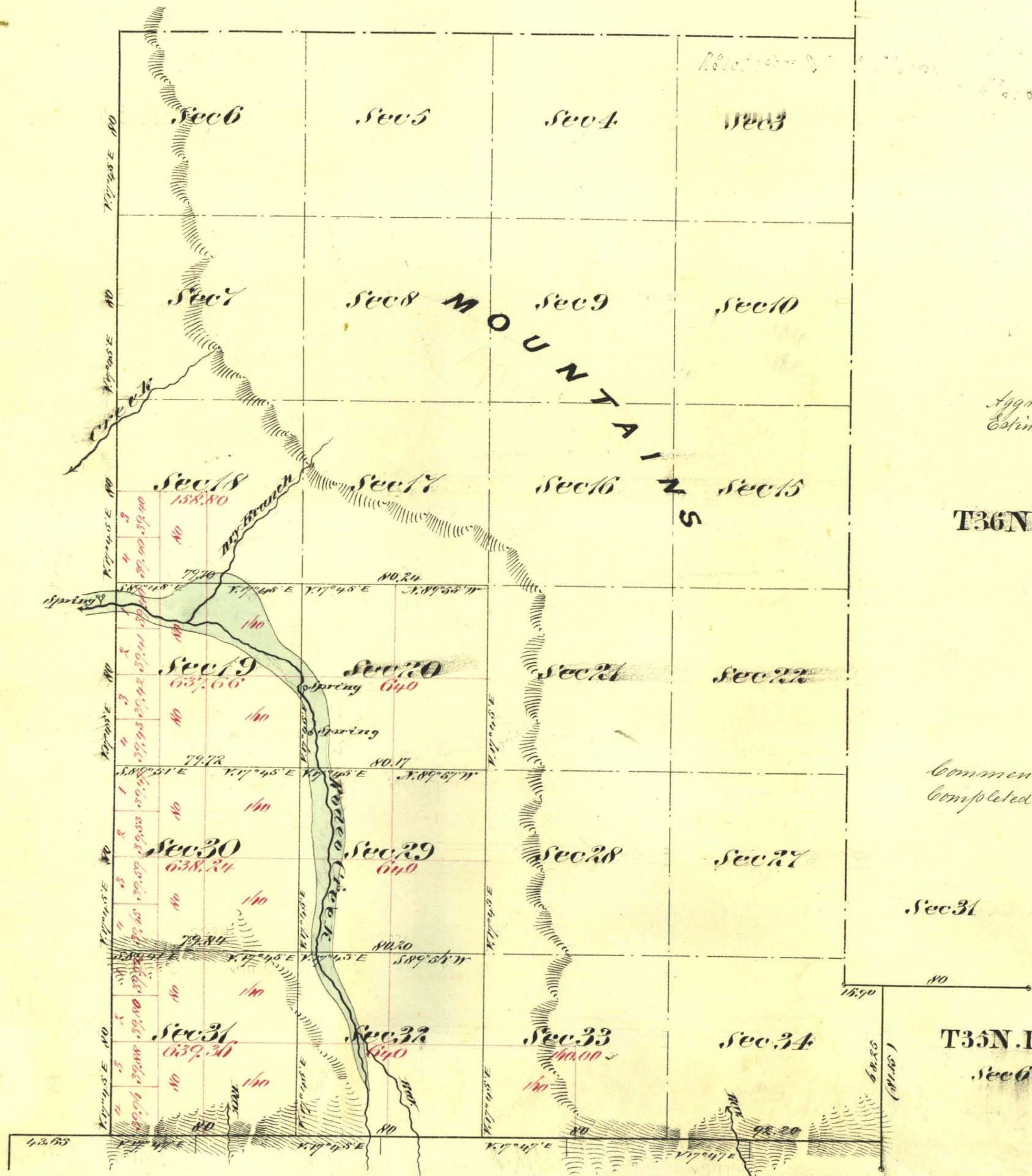

Aggregate Area of Public Land (Surveyed) 4,154.06 Ac.  
 Estimated " " Mountains (unsurveyed) 11,075.54 "  
 Aggregate 15,230.60 "

T36N. R51E

Commenced December 27<sup>th</sup> 1872  
 Completed " " "

Sec 31

T35N. R51E

Sec 6

Surveys Designated	By Whom Surveyed	Date of Contract	Am <sup>t</sup> of Surveys M <sup>o</sup> C <sup>o</sup> D <sup>o</sup>	When Surveyed
North West Boundary 135 <sup>th</sup> 135 <sup>th</sup>	J. H. Hatch & J. H. Eaton	February 15 <sup>th</sup> 1871	2 01 15	1871
West, South East "	J. H. Hatch, J. H. Eaton & J. L. Smyles	Nov <sup>br</sup> 15 <sup>th</sup> 1872	11 44 10	1872
Subdivision lines	" " " " "	" " " " "	11 79 87	December 1872

The above Maps of Township N<sup>o</sup> 36 North Range N<sup>o</sup> 50 East Mount Diablo Meridian  
 is strictly conformable to the field notes of the Surveys thereof on file in this Office  
 which have been examined and approved  
 U. S. Surveyor General's Office  
 Virginia City Nevada  
 February 13<sup>th</sup> 1873

E. S. Davis

U. S. Surveyor General Nevada