

Survey by Mr. Clellan and Bridges rejected by
Comm. Genl. Land Office by letter dated May 31 1885.

Approved by Com^r G. L. C. March 25th 1896

TOWNSHIP N^o 36 NORTH RANGE N^o 45 EAST MOUNT DIABLO MERIDIAN

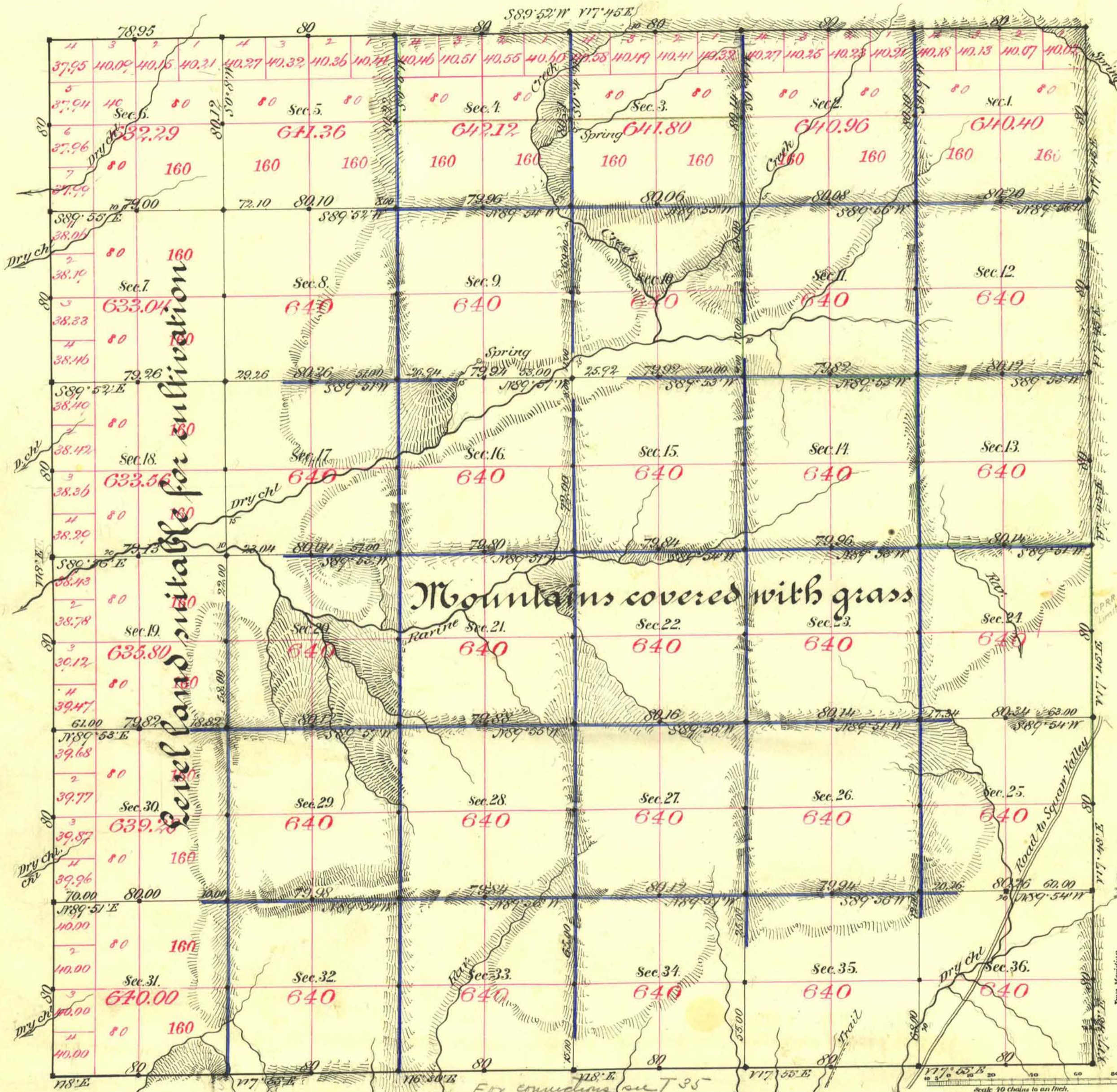

Aggregate Area of Public Land surveyed 23,020.61 Acres

Commenced March 11th 1885
Completed " 11th "

Subd. done with a Var. of 17th 45th East

Surveys Designated.	By Whom Surveyed.	Date of Contract.	Amount of Surveys.	When Surveyed.	No.
A. Day	Walter Dalton	Sept. 10 th 1868	25 - 26 - 27	1868	18
" "	"	Jan. 30 th 1869	6 - 00 - 00	1869	23
" "	"	Nov. 11 th 1872	6 - 00 - 00	1872	54
" "	S. R. Denmark	10 th 1884	5 - 78 - 95	1884	173
Subd. no black blue	Mr. Clellan & Bridges	" 11 th "	14 - 10 - 83	March 1885	174
" "	"	" "	45 - 68 - 29	" "	174

The above Map of Township No. 36 North of Range No. 45 East Mount Diablo Meridian is strictly conformable to the field notes of the survey thereof on file in this Office, which have been examined and approved.

Surveyor General's Office, Reno, *G. L. Corning*
U.S. Surv. Gen^l of Nevada.
June 2nd 1885