

Township N<sup>o</sup> 35 North Range N<sup>o</sup> 45 East Mount Diablo Meridian

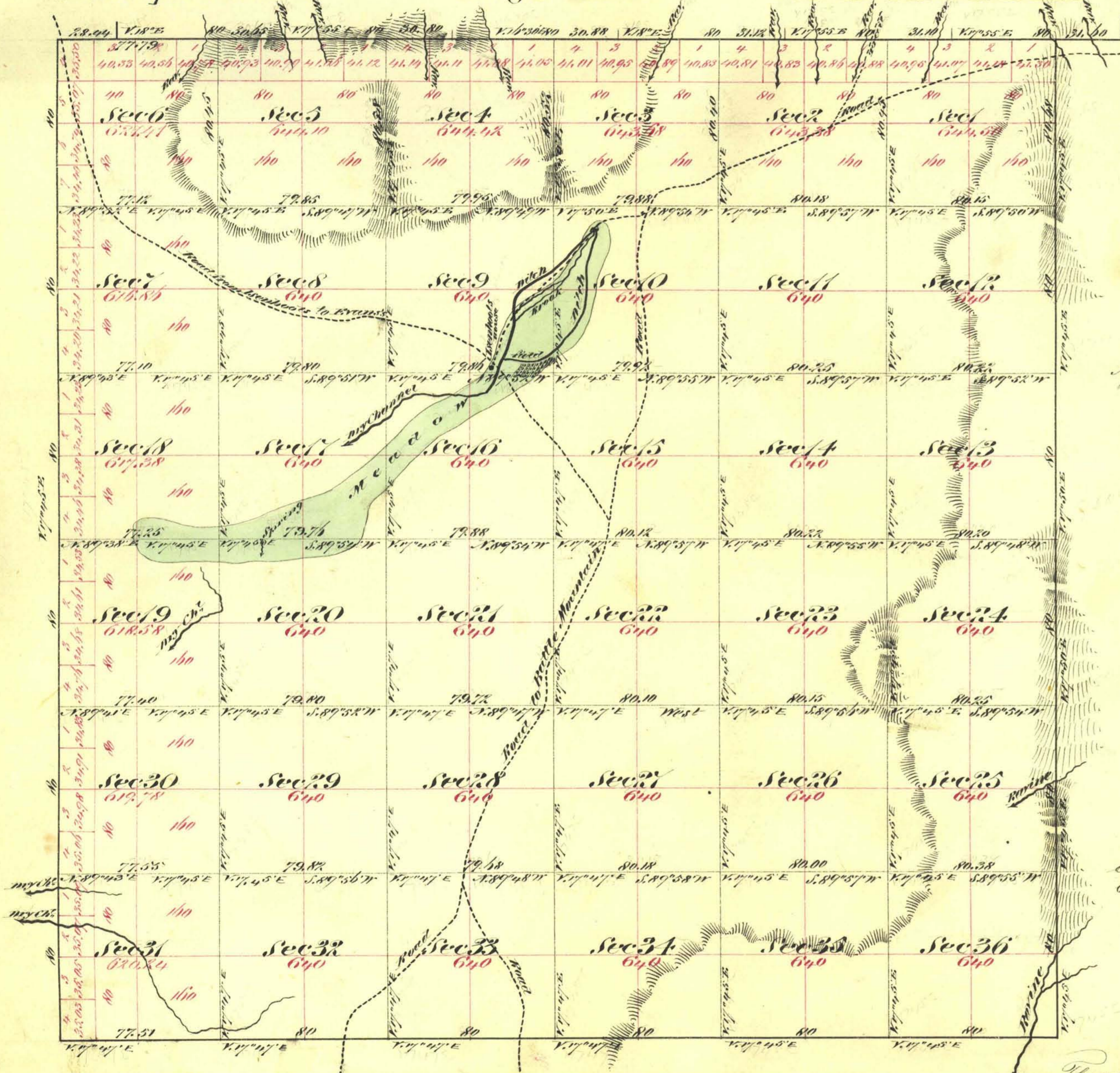

Aggregate Area of Public Land 22,934.33 Acres

Commenced December 21<sup>st</sup> 1872  
Completed December 30<sup>th</sup> 1872

Surveys Designated	By Whom Surveyed	Date of Contract	Am't of Survey M <sup>o</sup> C <sup>o</sup> S <sup>o</sup>	When Surveyed	7 <sup>th</sup> Cor <sup>r</sup>
North Boundary of Township	A. J. Hatch & H. Eaton	September 19 <sup>th</sup> 1868	6 00 00	1868	18
West "	" "	January 30 <sup>th</sup> 1869	6 00 00	1869	23
South East "	A. J. Hatch, H. Eaton & G. Smyle	November 15 <sup>th</sup> 1872	11 78 19	1872	54
Subdivision Lines	" " " "	" " "	59 69 14	December 1872	"
Convergency "	" " " "	" " "	1 74 55	"	"

The above Map of Township N<sup>o</sup> 35 North Range N<sup>o</sup> 45 East Mount Diablo Meridian is strictly conformable to the field notes of the surveys thereof on file in this office which have been examined and approved  
U. S. Surveyor General's Office  
Virginia City Nevada  
February 13<sup>th</sup> 1873

E. S. Davis  
U. S. Surveyor Gen'l Per. VD