

TOWNSHIP 34 NORTH, RANGE 33 EAST, OF THE MOUNT DIABLO MERIDIAN, NEVADA
 DEPENDENT RESURVEY

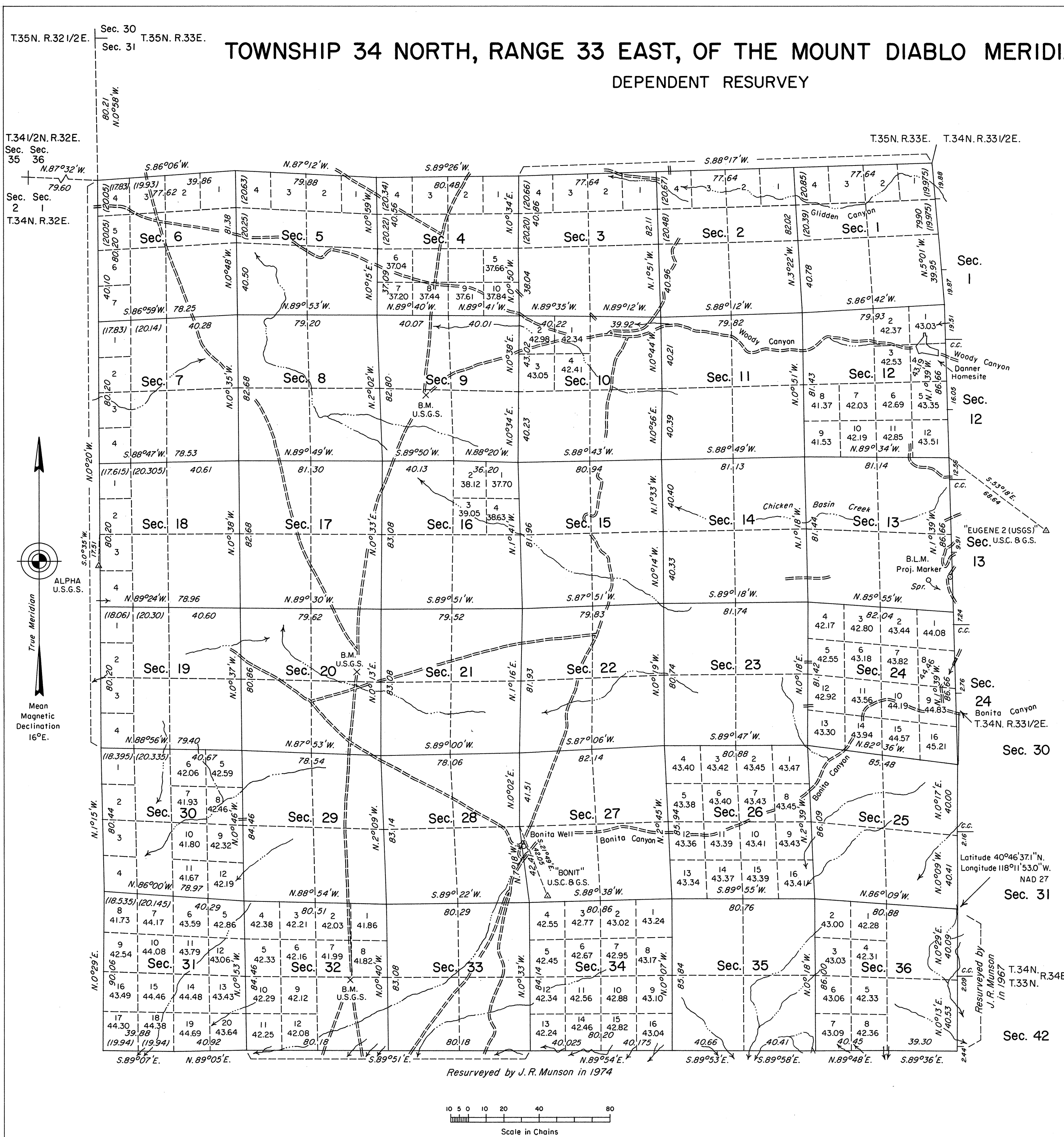

History of the earlier surveys is contained in the field notes.

This plat represents the dependent resurvey of a portion of the east boundary, the west and north boundaries, and the subdivisional lines of T. 34 N., R. 33 E., Mount Diablo Meridian, Nevada, designed to restore the corners in their true original locations according to the best available evidence.

Lottings and areas, except as indicated hereon, are as shown on the plat approved January 3, 1876.

Survey executed by Stephen R. Lambeth, Cadastral Surveyor, beginning September 17, 1987, and completed October 21, 1988, under Special Instructions dated September 4, 1987, and Supplemental Special Instructions dated December 17, 1987, for Group No. 654, Nevada.

UNITED STATES DEPARTMENT OF THE INTERIOR
 BUREAU OF LAND MANAGEMENT

Reno, Nevada September 30, 1991

This plat is strictly conformable to the approved field notes, and the survey, having been correctly executed in accordance with the requirements of law and the regulations of this Bureau, is hereby accepted.

For the Director

John S. Parrish

Chief Cadastral Surveyor, Nevada

T.34N., R.33E., M.D.M.