

*Township N°33North Range N°33East Mount Diablo Meridian*

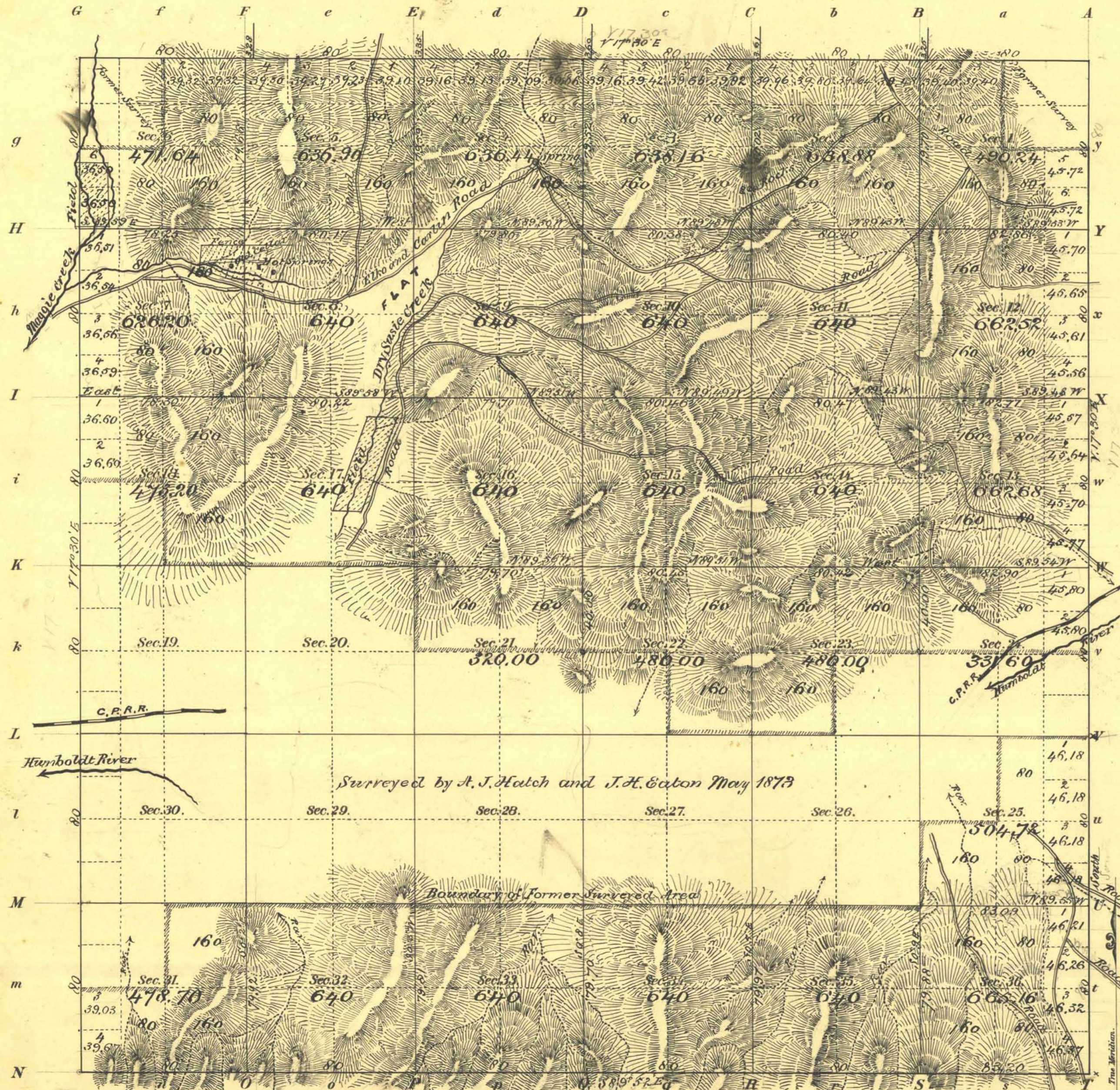

Surveyed by A. J. Hatch and J. H. Eaton May 1873

Total number of Acres 16,877.04

Surveys Designated	By Whom Surveyed	Date of Contract	Amount of Surveys M. Ch.² Lk.²	When Surveyed	No. of Contracts
Township lines	A. J. Hatch	Sept 17 <sup>th</sup> 1896	8 05 20	Apr 23 <sup>rd</sup> 1896	210
Subdivisions	A. J. Hatch	Apr 22 <sup>nd</sup> 1896	39 06 21	Apr 23 <sup>rd</sup> 1896	21
Connections & Subdivisions	A. J. Hatch	Oct 22 <sup>nd</sup> 1868	16 00 00	1868	21
T. N. & E. B. of Subdivisions	A. J. Hatch & J. H. Eaton	April 1 <sup>st</sup> 1873	20 77 30	May 1873	36

Meanders of						
Posts	Courses	Ch.² Lk.²	Posts	Courses	Ch.² Lk.²	Posts

Latitude 40° 43' 30"  
Longitude 116° 10' 11"  
Mean Mag. decl. 17° 24' 0"

The above Map of Township N°33 North of Range N°33 East Mount Diablo Meridian is strictly conformable to the field notes of the survey thereof on file in this Office which have been examined and approved.

Surveyor General's Office,  
Reno Nevada  
October 28<sup>th</sup> 1896

*Clayton Beckwith*  
Sur. Gen.