

## DEPENDENT RESURVEY AND SUBDIVISION

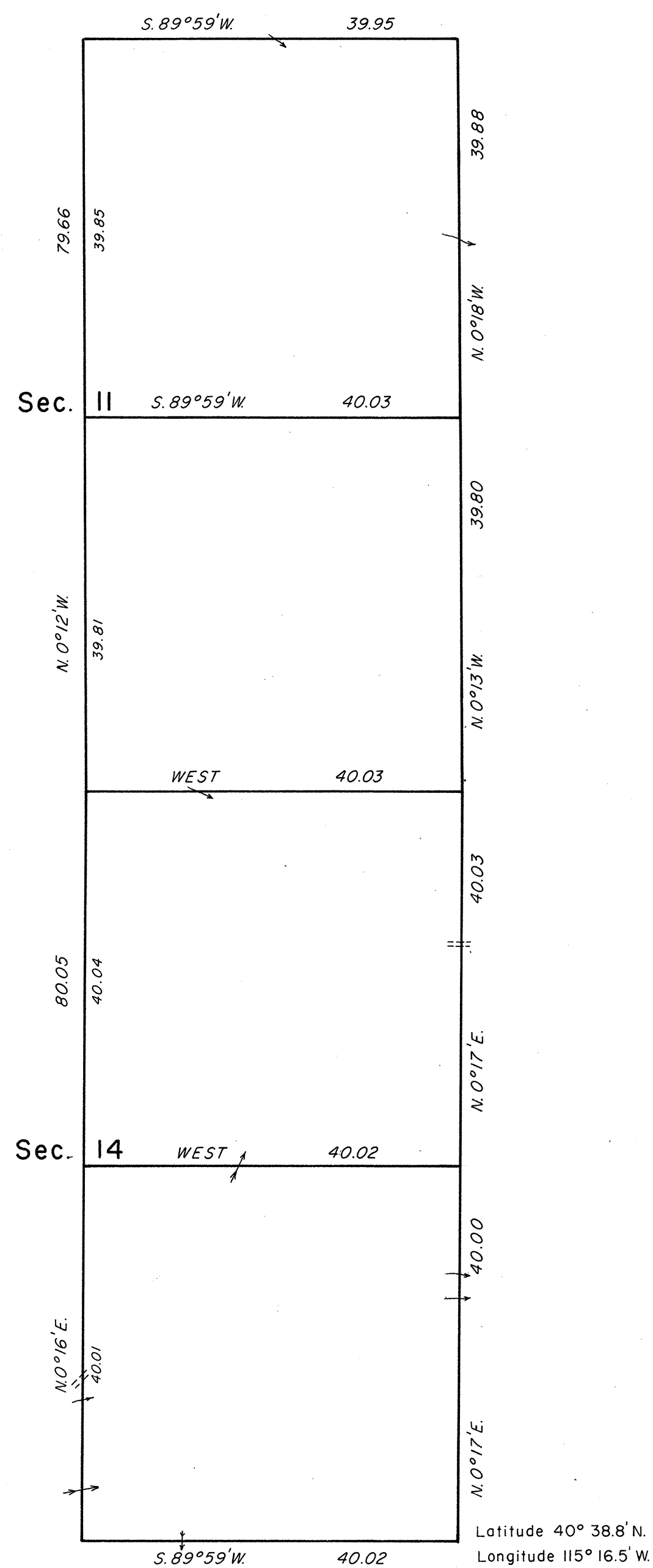

Survey executed by Terrence O. Nickerson, Cadastral Surveyor, beginning May 19, 1976, and completed May 21, 1976, pursuant to Special Instructions dated March 30, 1976, for Group No. 536, Nevada.

This plat is strictly conformable to the approved field notes, and the survey, having been correctly executed in accordance with the requirements of law and the regulations of this Bureau, is hereby accepted.

For the Director

*Alfred Arnold*  
Acting Chief, Cadastral Survey  
Examination and Approval Staff

MEAN MAGNETIC DECLINATION  
17½° EAST

LD