

TOWNSHIP 32 NORTH, RANGE 33 EAST, OF THE MOUNT DIABLO MERIDIAN, NEVADA

DEPENDENT RESURVEY AND SUBDIVISION

OFFICIALLY FILED  
NEVADA STATE OFFICE  
at 10:00 AM on May 9, 2012

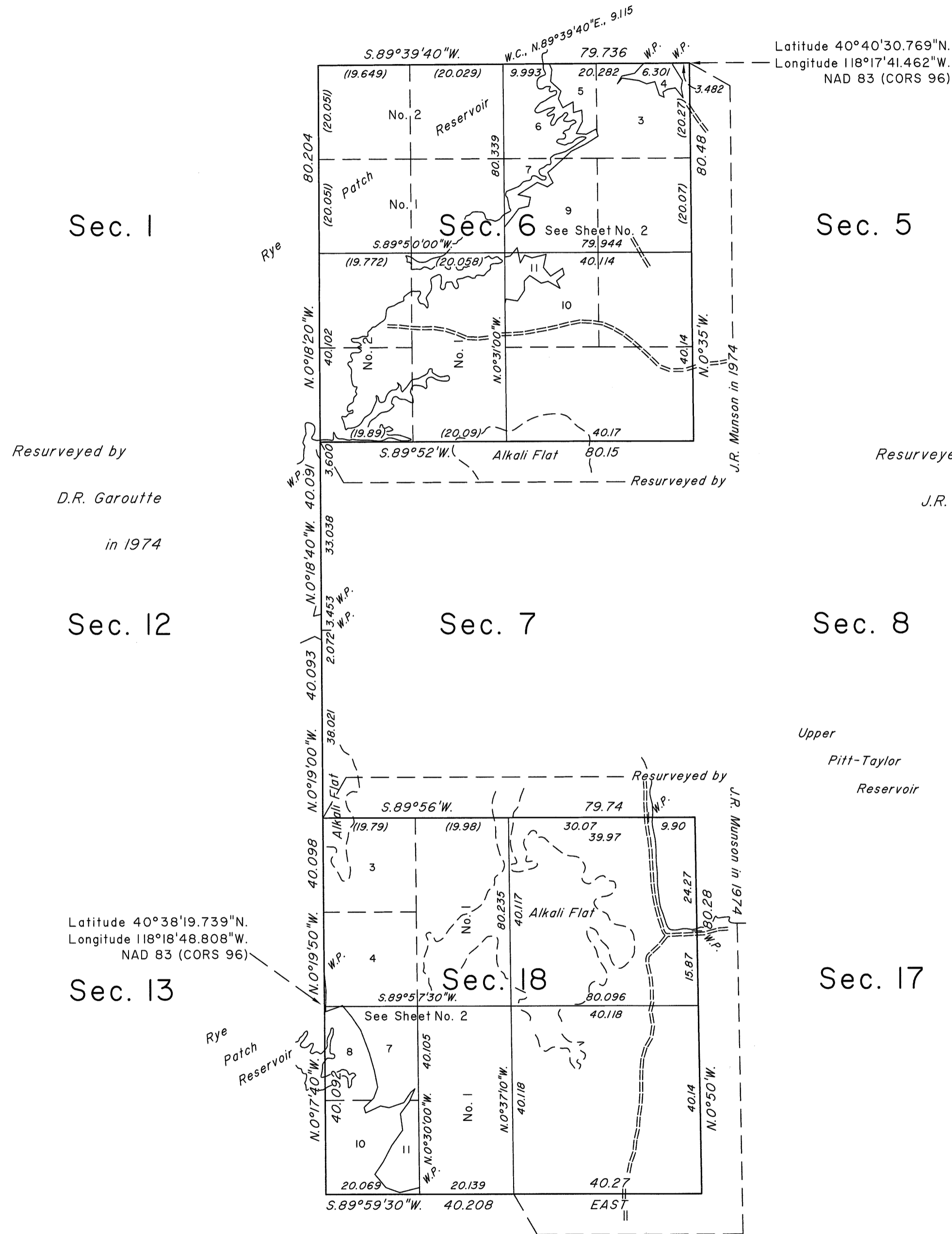
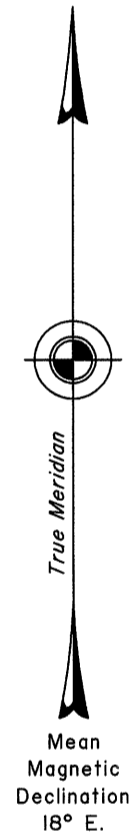

Resurveyed by  
*D.R. Garoutte*  
in 1974

Resurveyed by  
*J.R. Munson*  
in 1974

Sec. 12

Sec. 7

Sec. 8

Upper  
*Pitt-Taylor*  
Reservoir

Sec. 13

Sec. 18

Sec. 17

Latitude 40°38'19.739"N.  
Longitude 118°18'48.808"W.  
NAD 83 (CORS 96)

Latitude 40°40'30.769"N.  
Longitude 118°17'41.462"W.  
NAD 83 (CORS 96)

A history of the surveys is contained in the field notes.

The dependent resurvey of a portion of the west boundary was executed concurrently under T. 32 N., R. 32 E., of this same group.

This plat, in two sheets, represents the dependent resurvey of a portion of the north boundary and a portion of the subdivisional lines designed to restore the corners in their true original locations according to the best available evidence, the subdivision of sections 6 and 18, and the survey of the meanders of portions of the 4144 foot contour line, Township 32 North, Range 33 East, Mount Diablo Meridian, Nevada.

Except as indicated hereon, the lottings and areas are as shown on the plat approved March 25, 1864, and the plat accepted January 26, 1976.

Survey executed by Don R. Aschenbach, Cadastral Surveyor, beginning September 2, 2009, and completed October 4, 2011, under Special Instructions dated August 28, 2009, for Group No. 884, Nevada.

UNITED STATES DEPARTMENT OF THE INTERIOR  
BUREAU OF LAND MANAGEMENT

Reno, Nevada May 3, 2012

This plat is strictly conformable to the approved field notes, and the survey, having been correctly executed in accordance with the requirements of law and the regulations of this Bureau, is hereby accepted.

For the Director

Chief Cadastral Surveyor, Nevada

