

Township N^o 31 North Range N^o 53 East Mount Diablo Meridian

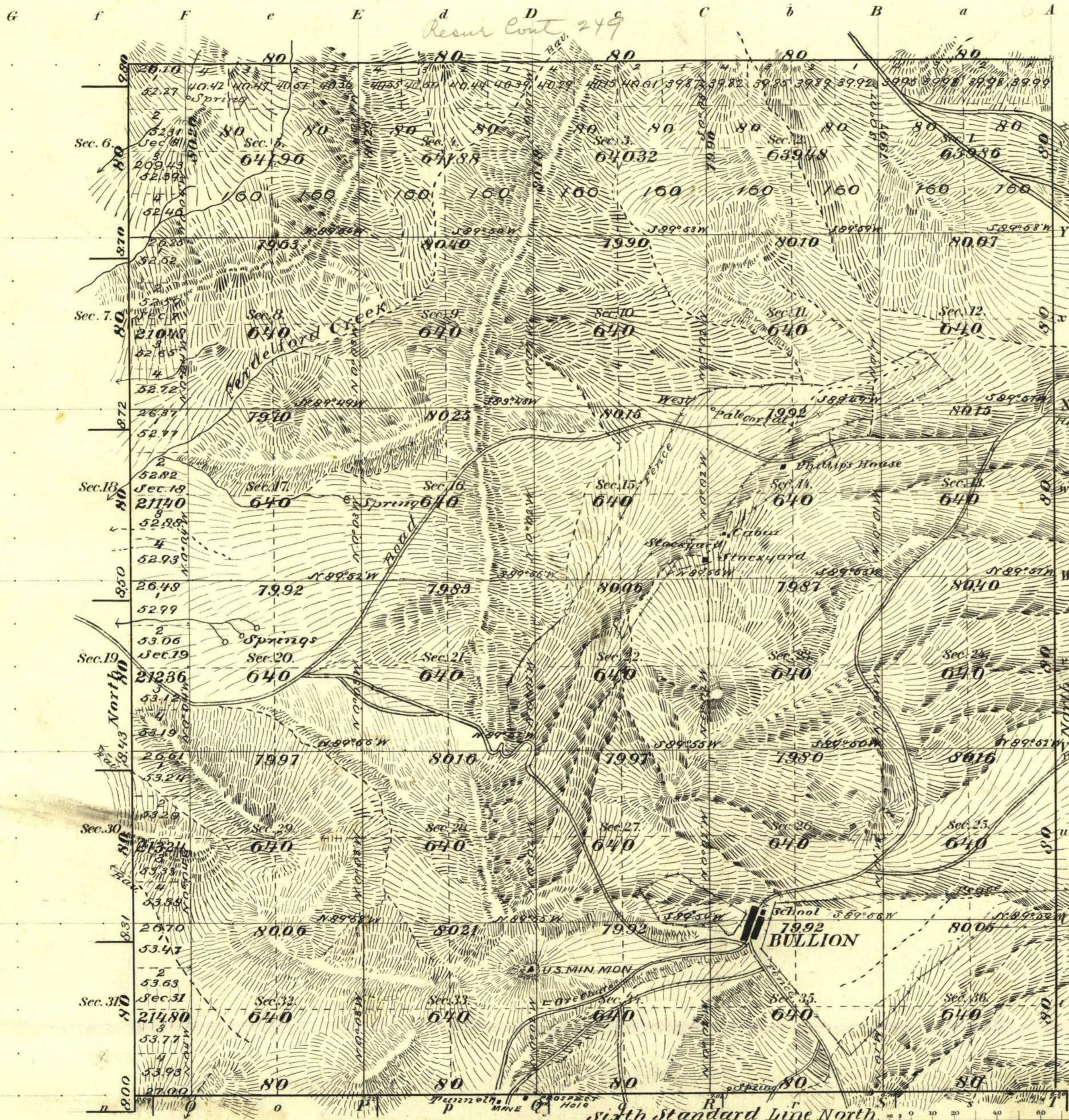

Meanders of

Posts	Courses	Ch. ² Lk. ²	Posts	Courses	Ch. ² Lk. ²	Posts	Courses	Ch. ² Lk. ²

Latitude 40° 32' N
Longitude 116° 00' W
Mean Mag. Decl. 17° 28' 15" E

Total number of Acres **20,473.21**

Surveys Designated	By Whom Surveyed	Date of Contract	Amount of Surveys M. Ch. ² Lk. ²	When Surveyed	No. Contract
Township lines	H.B. Mason	July 31 st 1896	5 26 10	1896	211
" E.B.	"	"	6 00 00	"	"
" W.B.	"	"	6 00 00	"	"
Sixth Standards	"	"	5 27 00	"	"
Subdivisions	"	"	56 53 72	Nov. 18 th 10 23 96	"
Corrections	"	"	60 40	1896	"

The above Map of Township N^o 31 North of Range N^o 53 East Mount Diablo Meridian, is strictly conformable to the field notes of the survey thereof on file in this Office, which have been examined and approved.

Surveyor General's Office.
Reno Nevada.
February 20th 1897

Clayton Beekun
Sur. Gen!