

Township N^o 30 North Range N^o 32 East M^t Diablo Meridian, Nevada

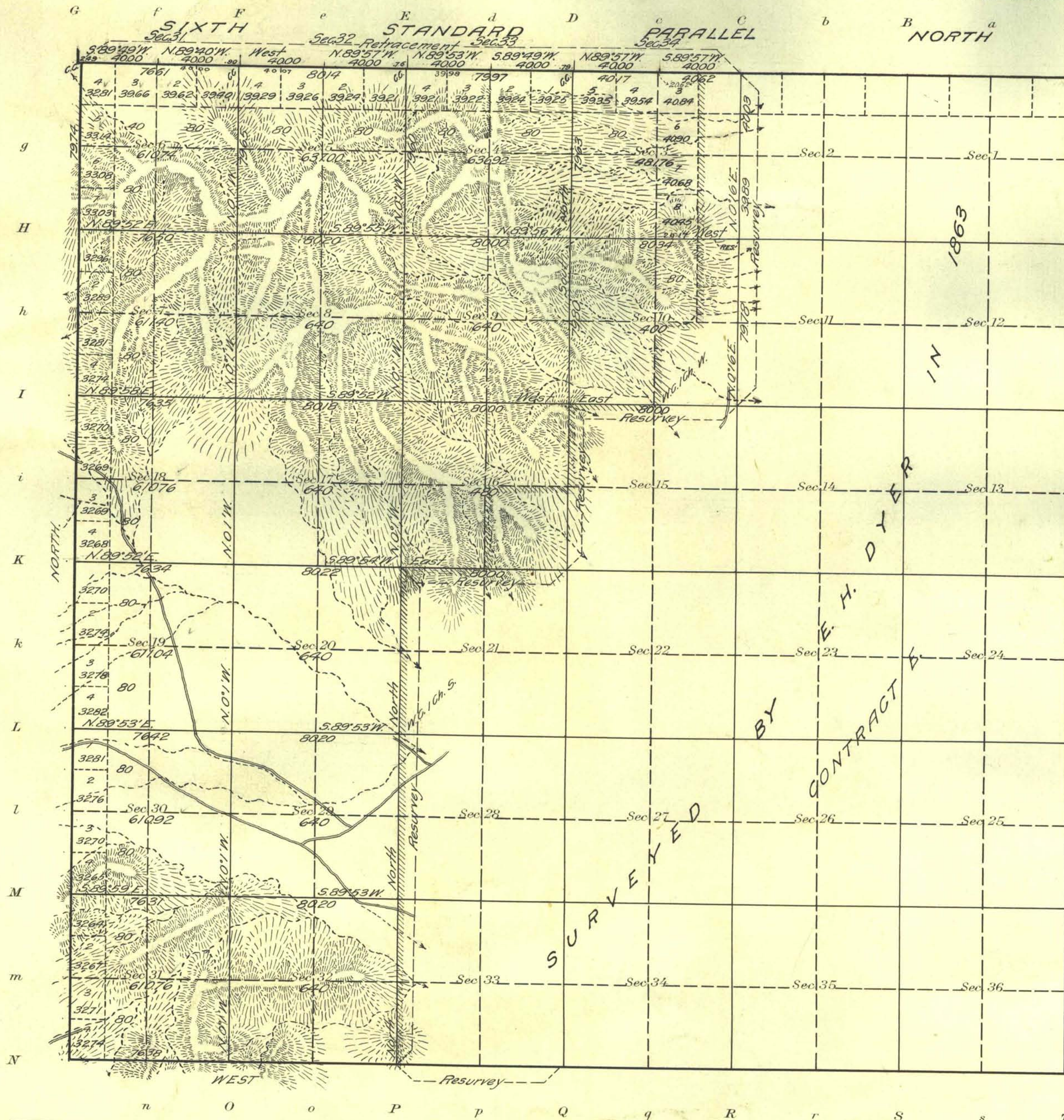

-NOTE -
 Surveyor reports a few indications of mineral in the portion of the Township surveyed by him

Areas in Acres	
Public Land	5269.34
Indian Reservation	
Indian Allotments	
Mineral Claims	
Water Surface	
C.P.R.R. Grant	4871.96
Total Area	10141.30

Scale 40 Chains to an inch
 Mean Magnetic Declination 18° 30' E

Surveys Designated	By Whom Surveyed	Group No.	Date	Amount of Surveys		When Surveyed	
				Mls.	chs.	begun	Completed
Sixth St. Par. N. Retr	Thos. A. Haight and W. H. Hayward	14	Aug. 22, 1911	3	77	51	Aug. 3, 1912
South Bdy. Resur.	"	"	"	1	00	00	Aug. 6, 1912
South Boundary	"	"	"	1	76	38	"
West Boundary	"	"	"	5	79	74	Sept. 23, 1912
Subdivision Resur.	"	"	"	8	11	70	Aug. 6, 1912
Subdivision	"	"	"	23	49	94	Sept. 28, 1912

The above map of Township No. 30 North Range No. 32 East of the M^t Diablo Meridian Nevada is strictly conformable to the field notes of the survey thereof on file in this office, which have been examined and approved
 U. S. Surveyor General's Office.
 Reno, Nevada, April 11, 1914

Matthew Kyle
 Surveyor General.